

RESIDENTIAL POOL AND SPA PLAN REVIEW CHECKLIST FOR CRITICAL SAFETY CODE REQMTS

HANDHOLDS REQUIRED

HANDHOLD(S) PROVIDED WHEN REQUIRED AT RAISED DECK AREAS MORE THAN 12 INCH FROM WATER LINE AND WATER DEPTH MORE THAN 4 FEET FOR LENGTH OF 8 FEET. [2011 ANSI/APSP-5, 17.1]

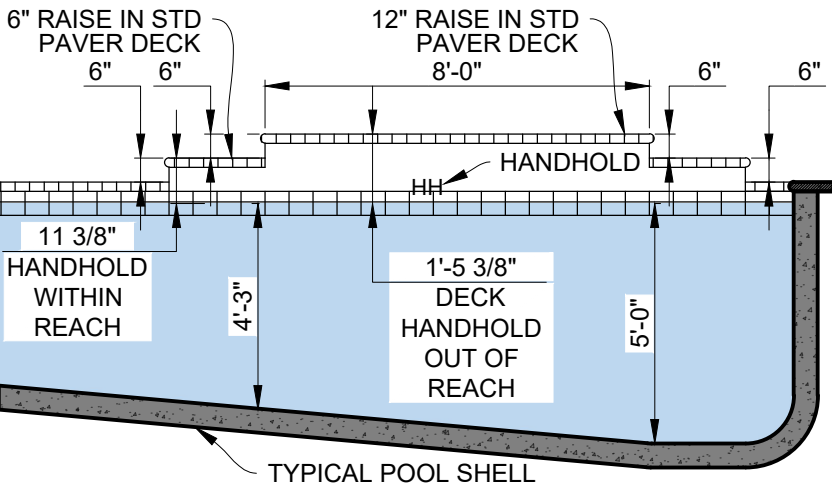

ON PAVER COPING A 6" RISE STILL HAS HANDHOLD

ON CONCRETE OVER POUR MORE THAN 5" RISE IS OUT OF REACH FOR HANDHOLD.

SPA STEP REQUIRED

UNLESS A SPA IS RAISED 12" OR MORE FROM DECK, A SPA STEP IS REQUIRED ON THE BENCH FOR THE MAXIMUM 12" FROM DECK TO ENTRY.[2014 ANSI/APSP-3, 5.6.1]

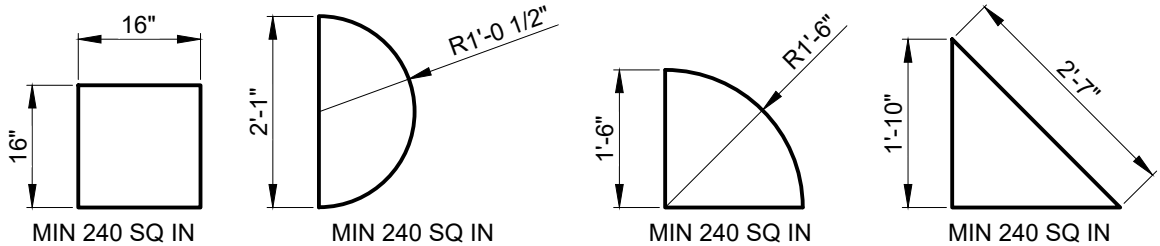

EXAMPLE 240 SQ IN STEP DIMENSIONS

SCALE: N.T.S.

HANDHOLDS REQUIRED

SCALE: N.T.S.

WHEN POOL WATER CLOSER THAN 5 FT

WINDOWS, DOORS OR OTHER GLASS WITHIN 5 FT OF WATER'S EDGE: MUST HAVE MANUFACTURER'S DESIGNATION OF SAFETY GLAZING AND BE VISIBLY MARKED

ALL FIXED METAL PARTS WITHIN 5 FT HORIZONTAL OR 12 FT VERTICAL- DOOR AND WINDOW FRAMES, CAGE AND FENCE STRUCTURES, STATIONARY EQUIPMENT, METAL AWNINGS- SHALL BE BONDED UNLESS PERMANENT BARRIER

ENERGY CODE REQUIREMENTS RESTATED:

1. GAS HEATER ELECTRICAL FEED SHALL BE THROUGH GFCI.
2. 4X PIPE DIAMETER STRAIGHT PIPE REQUIRED STRAIGHT INTO PUMP, 8" FOR 2" FITTING, 10" FOR 2.5" FITTING.
3. MIN 18" STRAIGHT PIPE REQUIRED AFTER FILTER AN BEFORE HEATER, IF HEATER PROVIDED.

PLAN REVIEWER AND INSPECTOR MUST VERIFY SUCTION OUTLET COVER RATED FLOW GREATER THAN DETAILED TDH CALCULATION AT MAXIMUM PUMP SPEED OR AT LEAST EXCEEDS MAXIMUM FLOW OF PUMP CURVE AND PARTICULARLY VERIFIED FOR SPA SIDEWALL SUCTIONS AND RATED "WALL" FLOWS

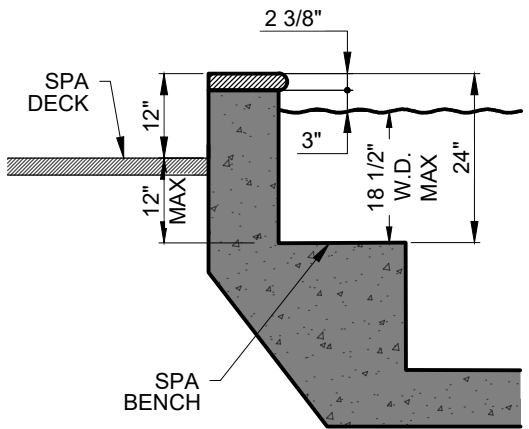

12" RAISED SPA NO STEP

SCALE: N.T.S.

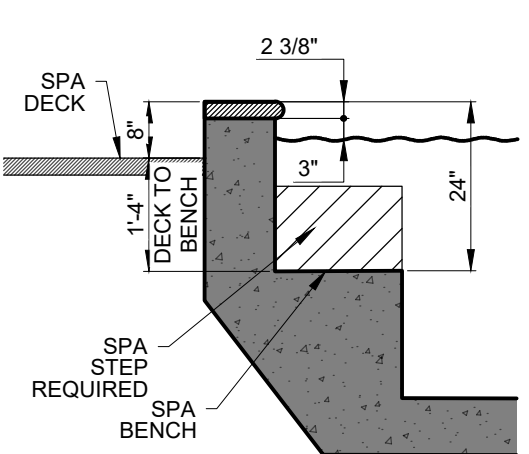

8" RAISED SPA STEP REQD.

SCALE: N.T.S.

DIGITAL SIGNATURE
INDEX SHEET FOR SHEETS
S1 S2 S3 PER RULE
61G15-23.001(4)(b),F.A.C.

SUN SHELF AS FIRST STEP

MAXIMUM 12" DECK TO SUN SHELF AS 1ST STEP, LIMITS WATER DEPTH UNLESS ADDED STEP ON SHELF. [2011 ANSI/APSP-5, 6.2.2]

SUN SHELF AS 1ST STEP

SCALE: N.T.S.

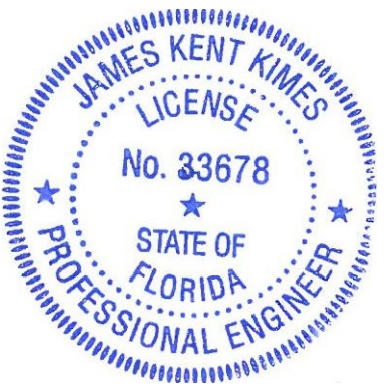
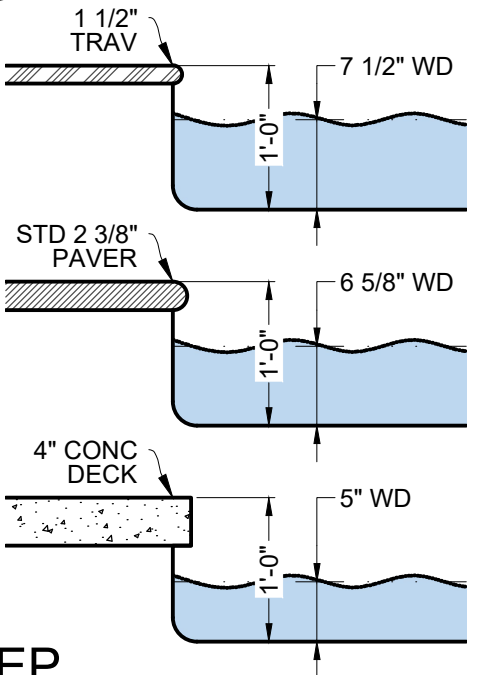

1925 Worth Ct
Bradenton, FL 34211
Office: 941-749-0311
C.A. 27189

KIMES ENGINEERING

©2022 Kimes Engineering and Management Services, Inc.
This drawing is the property of Kimes Engineering and Management Services, Inc. & is not to be reproduced or copied in whole or in part. It is only for the project & site specifically identified herein & is not to be used on any other project. It is to be returned upon request.

REV.	DATE	DESCRIPTION
PROJ. NO.	DWG BY:	CKD BY:
KE_RSTD	MCM	JKK
		01-Jan-21
		3-Feb-22

132 NW SILVERLEAF LN
SOUTHERN ESCAPES LLC

TYPICAL PLAN & SECTIONS
FOR RESIDENTIAL POOL/SPA

SHEET
S1

SHEET 1 OF 3

\\KIMES\RVD-Drive\COMPANY SHARED TWO\2020 FBC 7TH ED\2020 FBC KE Std Eng - r5.dwg

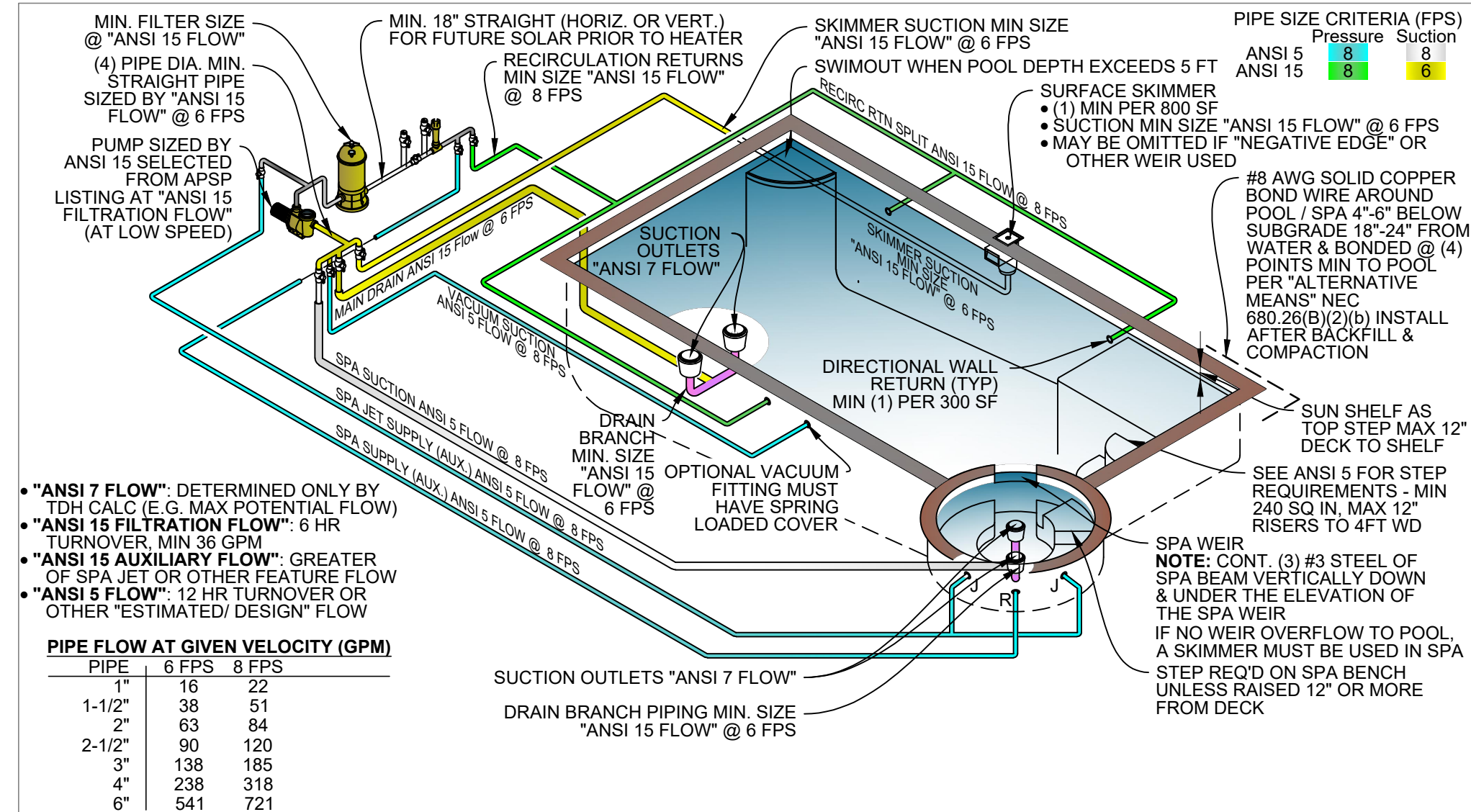

1 TYPICAL RESIDENTIAL POOL / SPA SCHEMATIC PLAN

SCALE: N.T.S.

FBC NO LONGER REQUIRES EXCAVATIONS OUT OF THE "ANGLE OF REPOSE PLUS 1 FT". THE CURRENT REQUIREMENT IN 7TH ED (2020) FBC, SECTION 1804.1 STATES THAT "EXCAVATIONS SHALL NOT REMOVE VERTICAL OR LATERAL SUPPORT FROM ANY FOUNDATION." THEREFORE THE FOLLOWING IS REQUIRED:

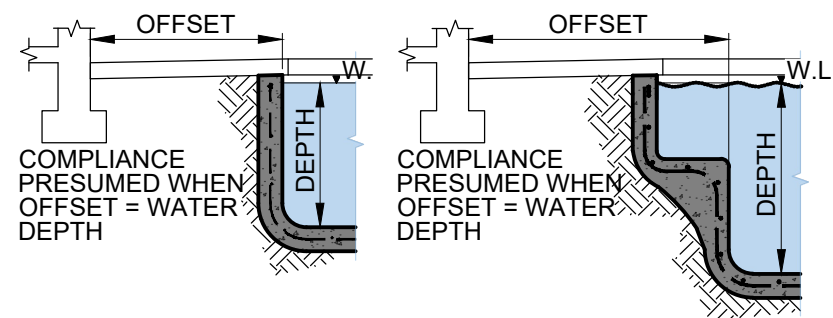

"ANGLE OF REPOSE" OR SEE CONTRACTOR PLAN

2 PROXIMITY TO STRUCTURE

SCALE: N.T.S.

1. WHEN THE POOL DECK DISTANCE IS EQUAL TO OR GREATER THAN WATER DEPTH, NO MITIGATION OF THE SHELL STRUCTURE IS REQUIRED, AND NO SHORING OR FOUNDATION SUPPORT INITIALLY REQUIRED.
2. WHEN THE POOL DECK DISTANCE IS LESS THAN THE WATER DEPTH, THE ENGINEER SHALL PROVIDE A MITIGATION SPECIFICATION, EITHER TO PROTECT THE FOUNDATION DURING EXCAVATION OR STRENGTHEN THE SHELL FROM STRUCTURE LOADS.
3. IF DURING EXCAVATION, SOIL CONDITIONS APPEAR TO LEAD TO LOSS OF FOUNDATION SUPPORT, THE CONTRACTOR SHALL CEASE EXCAVATION AND CONTACT THE ENGINEER FOR MITIGATION SPECIFICATIONS.
4. IF AFTER EXCAVATION THE CONTRACTOR FINDS A LOSS OR THREATENED LOSS OF SOIL SUPPORT AT THE FOUNDATION, CONTACT THE ENGINEER FOR A MITIGATION SPECIFICATION.

SEE INFORMATION ATTACHED TO THIS PERMIT PACKAGE FOR SITE SPECIFIC DETAILS SHOWING ANSI 7 & 15 AND FBC COMPLIANCE

NOTE TO REVIEWER:
DETAILED TDH CALCULATIONS ARE REQUIRED TO DETERMINE ANSI 7-SUCTION ENTRAPMENT COMPLIANCE

COMPLIES WITH 7TH ED. (2020) FBC, ALL VOLUMES

SEE DIGITAL SIGNATURE ON INDEX SHEET S1

1925 Worth Ct
Bradenton, FL 34211
Office: 941-749-0311
C.A. 27189

KIMES ENGINEERING

©2022 Kimes Engineering and Management Services, Inc.
This drawing is the property of Kimes Engineering and Management Services, Inc. & is not to be reproduced or copied in whole or in part. It is only for the project & site specifically identified herein & is not to be used on any other project. It is to be returned upon request.

REV. DATE DESCRIPTION
PROJ. NO.: DWG BY: CKD BY: JKK 01-Jan-21
KE_RSTD MCM VERSION: 3-Feb-22

132 NW SILVERLEAF LN
SOUTHERN ESCAPES LLC

TYPICAL PLAN & SECTIONS
FOR RESIDENTIAL POOL/SPA

SHEET
S2

SHEET 2 OF 3

ORIG. DWG: 17"x11" (ANSI B)

\\KIMES\SRV\Drawings\COMPANY SHARED\TWO\2020 FBC 7TH ED\2020 FBC KE Std Eng - r5.dwg

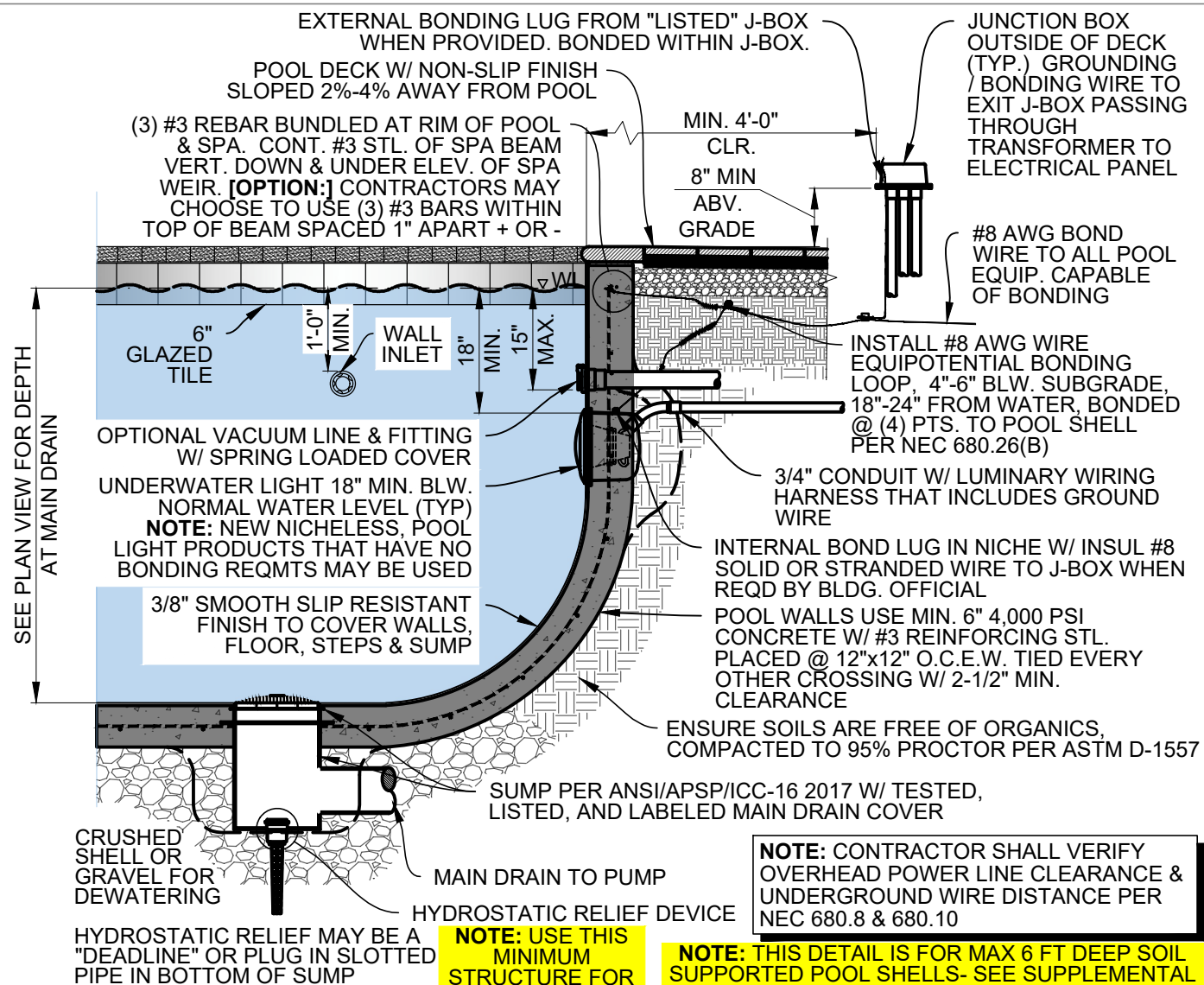

1 POOL DEEP END SECTION

SCALE: N.T.S.

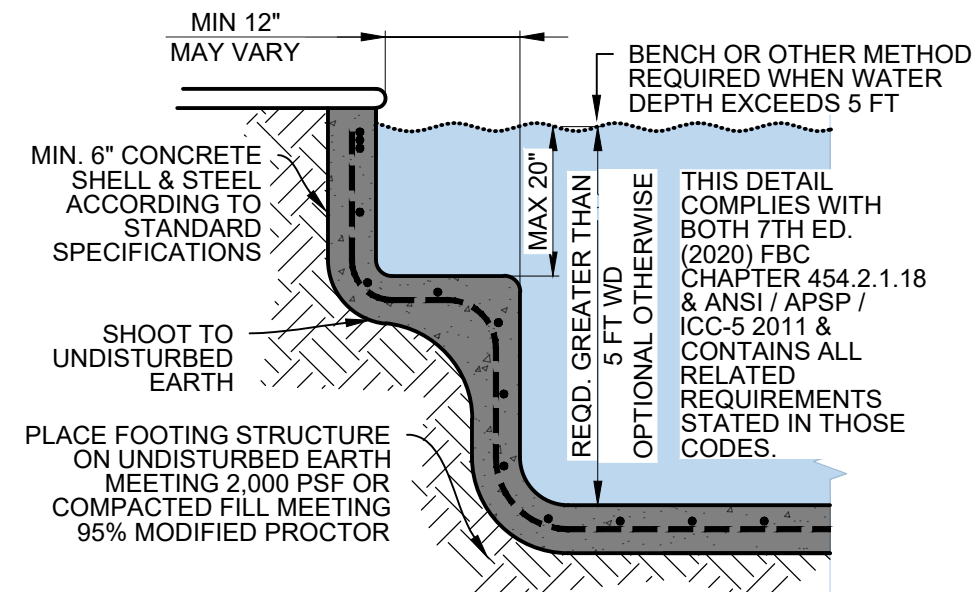

3 BENCH SECTION

SCALE: N.T.S.

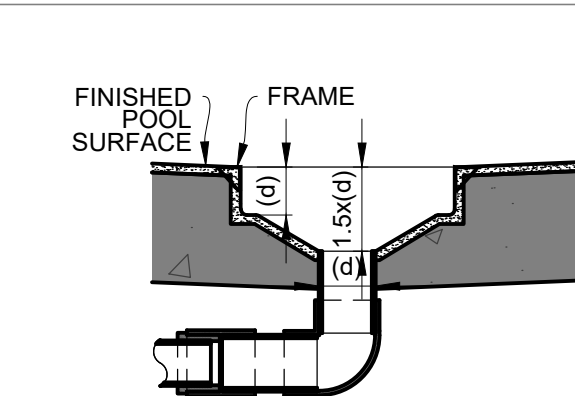

2 FIELD BUILT SUMP

SCALE: N.T.S.

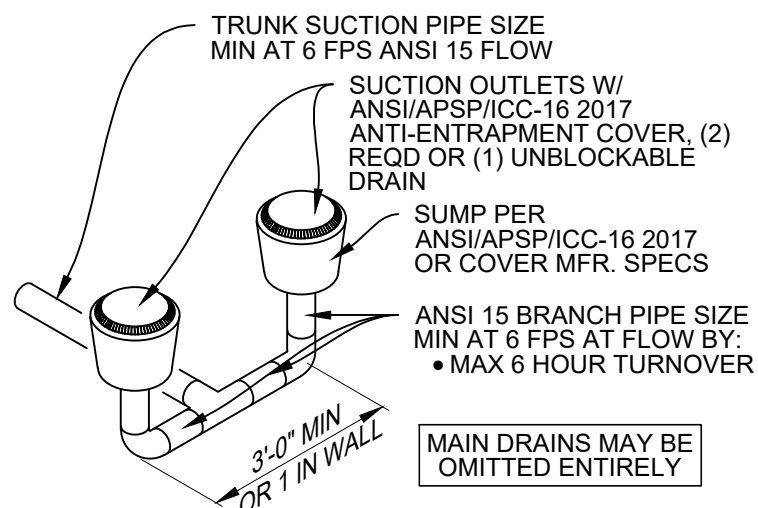

4 BRANCH PIPING

SCALE: N.T.S.



NOTES:

- APPROVED PRODUCT SPECIFICATION MAY DIFFER FROM FIELD BUILT SUMPS SHOWN ON THIS PAGE

ADDITIONAL STRUCTURAL NOTES:

- USE MINIMUM ASTM A615 GRADE 40 STEEL
- LAP #3 BARS MINIMUM 15"
- LAP #5 BARS MINIMUM 25"
- 6" SHELL THICKNESS AND 2-1/2" CONCRETE COVERAGE ARE MINIMUMS
- USE 4,000 PSI CONCRETE
- CONTRACTOR / OWNER REQUIRED TO:
 - CONTACT ENGINEER IF POOL NOT PLACED ON UNDISTURBED AND DE-WATERED EARTH THAT CAN MEET 2,000 PSF BEARING CAPACITY.
 - WHEN BURIED DEBRIS IS ENCOUNTERED OR QUESTIONABLE CONDITIONS ARE INDICATED AT THE WORK SITE PRIOR / DURING CONSTRUCTION, A SUBSURFACE CONSULTANT SHALL CONDUCT BORING(S) IN THE AREA OF THE POOL TO CONFIRM SOIL BEARING CAPACITY, CLEAR OF BURIED DEBRIS, & VERIFYING GROUND WATER LEVEL
 - ALL MODIFIED SOILS & EARTH FILL UNDER PERSPECTIVE POOL AREA SHALL MEET A SOIL DENSITY AND COMPACTION MINIMUM OF 95% MODIFIED PROCTOR WITHOUT SETTLEMENT.

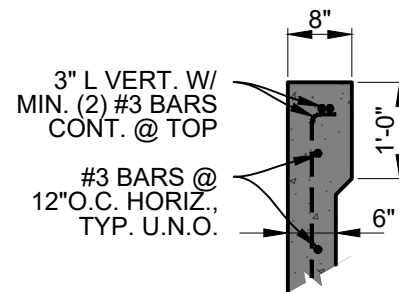

5 POOL BEAM 8"x12" OPTION

SCALE: N.T.S.

COMPLIES WITH 7TH ED. (2020) FBC, ALL VOLUMES

SEE DIGITAL SIGNATURE ON INDEX SHEET S1

KIMES ENGINEERING

1925 Worth Ct
Bradenton, FL 34211
Office: 941-749-0311
C.A. 27189

©2022 Kimes Engineering and Management Services, Inc.
This drawing is the property of Kimes Engineering and Management Services, Inc. & is not to be reproduced or copied in whole or in part. It is only for the project & site specifically identified herein & is not to be used on any other project. It is to be returned upon request.

REV. DATE DESCRIPTION
KE_RSTD MCM 01-Jan-21 JKK
2-3-2022 REVISED

PROJ. NO.: DWG BY: CKD BY: JKK
VERSION: 3-Feb-22

132 NW SILVERLEAF LN
SOUTHERN ESCAPES LLC

TYPICAL SECTIONS
FOR RESIDENTIAL POOL/SPA

ORIG. DWG: 17"x11" (ANSI B)

SHEET
S3

SHEET 3 OF 3