

LEGEND:

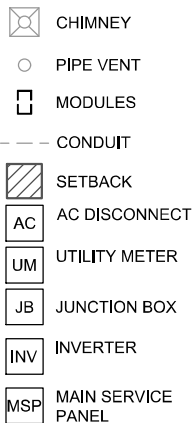

**PV SYSTEM**  
 6,880 kW-DC  
 5,000 kW-AC

SOUTHEAST COUNTRY CLUB ROAD

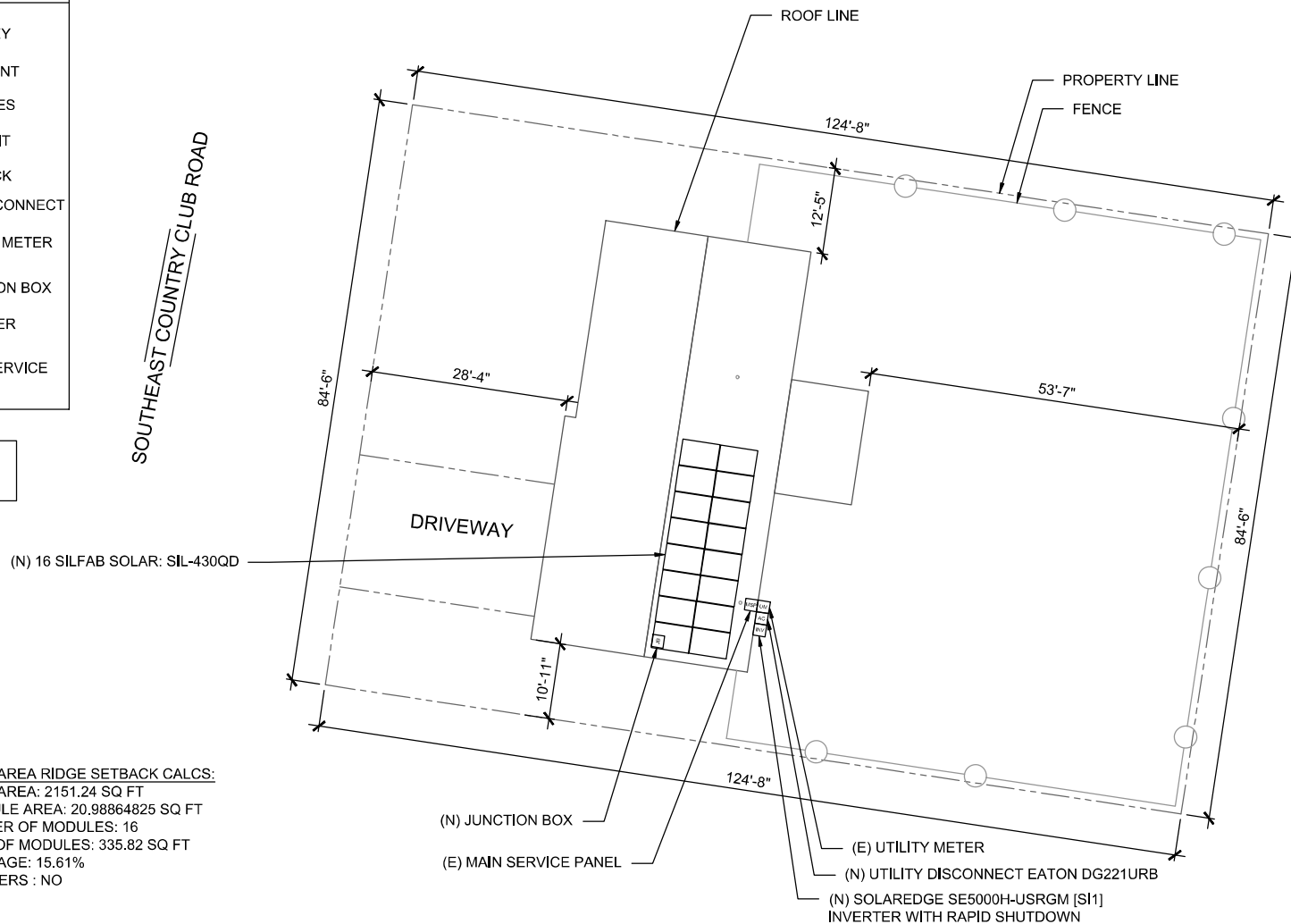

**TOTAL ROOF AREA RIDGE SETBACK CALCS:**  
 TOTAL ROOF AREA: 2151.24 SQ FT  
 SINGLE MODULE AREA: 20.98864825 SQ FT  
 TOTAL NUMBER OF MODULES: 16  
 TOTAL AREA OF MODULES: 335.82 SQ FT  
 ROOF COVERAGE: 15.61%  
 FIRE SPRINKLERS : NO

**THIS SYSTEM DESIGNED WITH:**  
 WIND SPEED: 119  
 WIND EXPOSURE: C  
 SNOW LOAD: 0



**SITE PLAN**  
 SCALE: 1/16" = 1'-0"

1



This item has been digitally signed  
 and sealed by Taqi Khawaja, PE on  
 09/20/2024 using a Digital Signature.  
 Printed copies of this document are  
 not considered signed and sealed  
 and the signatures must be verified  
 on any electronic copies.

ROOF AREA: 2151.24 SQ FT

**CLIENT:**  
 MICHAEL SCHLINK  
 485 SOUTHEAST COUNTRY CLUB ROAD,  
 LAKE CITY, FL 32025  
**AHJ:** COUNTY OF COLUMBIA  
**UTILITY:** FPL - FLORIDA POWER & LIGHT  
**METER:** ACD5917  
**\*PHONE:**  
**FINANCE:** OTHER

**SYSTEM:**  
 SYSTEM SIZE (DC): 16 X 430 = 6,880 kW  
 SYSTEM SIZE (AC): 5,000 kW @ 240V  
 MODULES: 16 X SILFAB SOLAR: SIL-430QD  
 OPTIMIZERS: 16 X SOLAREEDGE S440  
 INVERTER: SOLAREEDGE SE5000H-USRGM [S1]

REVISIONS		
NO.	REVISION BY	DATE
1	C.H.	9/19/2024
-	-	-
-	-	-

**freedom**  
 FOREVER  
 FREEDOM FOREVER LLC  
 2619 CONSULATE DR SUITE 800, ORLANDO,  
 FL 32819  
 Tel: (800) 385-1075  
 GREG ALBRIGHT  
  
**CONTRACTOR LICENSE:**  
 CERTIFIED ELECTRICAL CONTRACTOR  
 EC13008056

SITE PLAN			
JOB NO:	DATE:	DESIGNED BY:	SHEET:
496653	9/19/2024	C.H.	PW-2