



COLUMBIA COUNTY BUILDING DEPARTMENT

135 NE Hernando Ave., Suite B-21, Lake City, FL 32055

Office: 386-758-1008 Fax: 386-758-2160

www.columbiacountyfla.com/BuildingandZoning.asp

EXISTING BUILDING (Residential or Commercial) ADDITIONS - Additional Square Footage to an existing building.

Submit Permit Applications Online at: <https://www.columbiacountyfla.com/PermitSearch/MyBNZPortalLogin.aspx>

PERMIT EXEMPTION: If the construction job cost is \$4000.00 or less, no permit is required. (County Ord.2012-2) This does not change the requirement for the use of licensed contractors and the requirement of recording a Notice of Commencement when the cost is \$2500.00 or more. (F.S. ch:489, F.S. ch:713)

The Deeded Property Owner must sign the 2nd page of the application. If the customer has a **notarized Power of Attorney for from the Deeded Property Owner**, then that named person can sign for the owner.

For Corporate Ownership we must have documents to prove the person signing as the owner has the Authority to do so. (By: Articles of Incorporation, Proper contract documents, officer's authority on company letterhead, or other notarized documents; these documents will be reviewed prior to permit issuance.)

Agents cannot sign the Application for the contractor this must be the license holder.

- ☐ *Page 1 of 2 - Not required when submitted Online. Information on form completed as part of the Online application.
- ☐ If paper submission - Two page Permit Application with **PROPERTY OWNER'S SIGNATURE & notarized** contractor signature on 2nd page **and**, if a plan review is required the \$15.00 application fee.
- ☐ Subcontractors Verification Form, **signed** by the license holder/contractor that is subcontracted the job, if subcontractors are being used.
- ☐ License Holders (Contractors) must complete a "Letter of Authorization" for who signs the permit.
- ☐ If an Owner Builder, Notarized Disclosure Statement (Owner Builders **must** sign for the Permit).
- ☐ Recorded deed or Property Appraiser's parcel details printout; **and if**
- ☐ Owner is Corporation or Trust, **provide** corporate articles listing the signor, trust executor or POA forms.
- ☐ Product Approval Code Spec sheet, **if adding or replacing products with Florida approval numbers.**
- ☐ Recorded Notice of Commencement; before the 1st inspection.
- ☐ Provide information on Development Permits/Zoning Applications applied for, if applicable.
- ☐ **List of the job details including all stages of construction and all work being performed; STAFF WILL THEN FURTHER DETERMINE IF A PLAN REVIEW IS REQUIRED,**

PLAN REVIEW IS REQUIRED FOR: Any property located within a Flood Zone OR any Substantial Improvement- Any repair, reconstruction, rehabilitation, alteration, addition or other improvement of a building or structure, the cost of which equals or exceeds 50 percent of the market value of the structure before the improvement or repair is started. If the structure has sustained substantial damage, any repairs are considered substantial improvement regardless of the actual repair work performed. The term does not, however, include either: (1) Any project for improvement of a building required to correct existing health, sanitary, or safety code violations identified by the Building Official and that is the minimum necessary to ensure living conditions; or (2) Any alteration of a historic structure, provided that the alteration will not preclude the structure's continued designation as a historic structure.

Which may include...

- ☐ Site Plan with dimensions from each property line to the new addition. **Required if adding square footage.**
- ☐ 2 sets of blueprints or floor plans for safety review, Signed & Sealed Engineering, **if any structural changes.**
- ☐ 2 sets of Signed & Sealed truss engineering, **if any roof changes.**
- ☐ 2 sets of energy code & Manual J forms, **if required.**
- ☐ Septic Release or Septic Signed site plan from Environmental Health Department, call 386-758-1058.

Applications can be mailed, include the \$15.00 fee, checks to BCC or Board of County Commissioners. Revised 7-1-15

Columbia County Addition Permit Application

For Office Use Only Application # _____ Date Received _____ By _____ Permit # _____
 Zoning Official _____ Date _____ Flood Zone _____ Land Use _____ Zoning _____
 FEMA Map # _____ Elevation _____ MFE _____ River _____ Plans Examiner _____ Date _____
 Comments _____
☐ NOC ☐ Deed or PA ☐ Dev Permit # _____ ☐ In Floodway ☐ Letter of Auth. from Contractor
☐ F W Comp. letter ☐ Owner Builder Disclosure Statement ☐ Land Owner Affidavit ☐ Ellisville Water ☐ App Fee Paid
☐ Site Plan ☐ Env. Health Approval _____ ☐ Sub VF Form

*This page not required if Online submission.

Applicant (Person authorized to submit forms) Brian Rollins Fax _____ Phone (801) 992-1635

Address 2392 N Orchard Way Saratoga Springs UT 84045

Owners Name Jerry Padrta Phone (386) 961-6148

911 Address 253 NW Country Lake Dr Lake City FL 32055

Contractors Name Encor Solar LLC Phone (801) 992-1635

Address 2392 N Orchard Way Saratoga Springs UT 84045

Applicants Email permits@encorsolar.com ***Include to get updates on this job.

Fee Simple Owner Name & Address _____

Bonding Co. Name & Address _____

Architect/Engineer Name & Address _____

Mortgage Lenders Name & Address _____

Circle the correct power company ☒ FL Power & Light ☐ Clay Elec. ☐ Suwannee Valley Elec. ☐ Duke Energy

Property ID Number 22-35-16-02268-098 Estimated Construction Cost \$88,540.62

Subdivision Name WOODBOROUGH Lot 3 Block _____ Unit _____ Phase 4

Special Driving Instructions - Only -

Go N on NE Hernando Ave toward NE Justice St. Turn L on NE Madison St. Turn R on NW Main Blvd/US Hwy 41 N. At the traffic circle, take the 2nd exit on NW Bascom Norris Dr. Turn R on NW Lake Jeffery Rd. Turn L on NW Scenic Lake Dr/Woodborough. Turn R on NW Country Lake Dr. Destination will be on the L.

Construction of PV Solar Installation _____ Commercial OR ☒ Residential

Type of Structure (House; Mobile Home; Garage; Exxon) House

Use/Occupancy of the building now Residential Is this changing No

If Yes, Explain, Proposed Use/Occupancy _____

Is the building Fire Sprinkled? _____ If Yes, blueprints Included _____ Or Explain _____

Entrance Changes (Ingress/Egress) _____ If Yes, Explain _____

Zoning Applications applied for (Site & Development Plan, Special Exception, etc.) _____

Columbia County Building Permit Application - "Owner and Contractor Signature Page"

CODES: 2020 Florida Building Code 7th Edition and the 2017 National Electrical Code.

Application is hereby made to obtain a permit to do work and installations as indicated. I certify that no work or installation has commenced prior to the issuance of a permit and that all work be performed to meet the standards of all laws regulating construction in this jurisdiction.

TIME LIMITATIONS OF APPLICATION: An application for a permit for any proposed work shall be deemed to have been abandoned 180 days after the date of filing, unless pursued in good faith or a permit has been issued.

TIME LIMITATIONS OF PERMITS: Every permit issued shall become invalid unless the work authorized by such permit is commenced within 180 days after its issuance, or if the work authorized by such permit is suspended or abandoned for a period of 180 days after the time work is commenced. A valid permit receives an approved inspection every 180 days. Work shall be considered not suspended, abandoned or invalid when the permit has received an approved inspection within 180 days of the previous approved inspection.

FLORIDA'S CONSTRUCTION LIEN LAW: Protect Yourself and Your Investment: According to Florida Law, those who work on your property or provide materials, and are not paid-in-full, have a right to enforce their claim for payment against your property. This claim is known as a construction lien. If your contractor fails to pay subcontractors or material suppliers or neglects to make other legally required payments, the people who are owed money may look to your property for payment, even if you have paid your contractor in full. This means if a lien is filed against your property, it could be sold against your will to pay for labor, materials or other services which your contractor may have failed to pay.

NOTICE OF RESPONSIBILITY TO CONTRACTOR AND AGENT: YOU ARE HEREBY NOTIFIED as the recipient of a building permit from Columbia County, Florida, you will be held responsible to the County for any damage to sidewalks and/or road curbs and gutters, concrete features and structures, together with damage to drainage facilities, removal of sod, major changes to lot grades that result in ponding of water, or other damage to roadway and other public infrastructure facilities caused by you or your contractor, subcontractors, agents or representatives in the construction and/or improvement of the building and lot for which this permit is issued. No certificate of occupancy will be issued until all corrective work to these public infrastructures and facilities has been corrected.

WARNING TO OWNER: YOUR FAILURE TO RECORD A NOTICE OF COMMENCEMENT MAY RESULT IN YOU PAYING TWICE FOR IMPROVEMENTS TO YOUR PROPERTY. A NOTICE OF COMMENCEMENT MUST BE RECORDED AND POSTED ON THE JOB SITE BEFORE THE FIRST INSPECTION. IF YOU INTEND TO OBTAIN FINANCING, CONSULT WITH YOUR LENDER OR ATTORNEY BEFORE RECORDING YOUR NOTICE OF COMMENCEMENT.

OWNERS CERTIFICATION: I CERTIFY THAT ALL THE FOREGOING INFORMATION IS ACCURATE AND THAT ALL WORK WILL BE DONE IN COMPLIANCE WITH ALL APPLICABLE LAWS REGULATING CONSTRUCTION AND ZONING.

NOTICE TO OWNER: There are some properties that may have deed restrictions recorded upon them. These restrictions may limit or prohibit the work applied for in your building permit. You must verify if your property is encumbered by any restrictions or face possible litigation and or fines.

Jerry Padrta
Printed Owners Name

Owners Signature

****Property owners must sign here before any permit will be issued.**

CONTRACTORS AFFIDAVIT: By my signature, I understand and agree that I have informed and provided this written statement to the owner of all the above written responsibilities in Columbia County for obtaining this Building Permit including all application and permit time limitations.

Contractor's Signature

Contractor's License Number CVC57229
Columbia County
Competency Card Number

Affirmed and subscribed before me the Contractor by means of ☒ physical presence or ☐ online notarization, this 06 day of December 2023, who was personally known Driver License or produced ID Utah

State of ~~Florida~~ Utah Notary Signature (For the Contractor)

SEAL

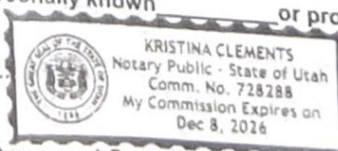

(Electronic Signatures Are Accepted.)



Columbia County, Florida
Building Department
135 NE Hernando Avenue
Lake City, Florida 32055
Phone: 386-758-1008

www.columbiacountyfla.com

ROOFING UNDERLAYMENT AFFIDAVIT

REQUIRED FOR WALK-IN OR PAPER SUBMITTALS

Job Address: 253 NW Country Lake Dr Lake City FL 32055

I (Print Name) Brian Rollins, as a Florida license Roofing Contractor or an Owner Builder, I understand to comply with the 2020 Florida Building Code 7th Edition underlayment requirements, I must select an option for sealing the roof deck.

The options are summarized below...

☐ a self-adhering polymer-modified bitumen underlayment complying with ASTM D1970 applied over the entire roof.

☐ a minimum 4-inch wide strip of selfadhering polymer-modified bitumen complying with ASTM D1970 or a minimum 3 ¼ - inch wide strip of selfadhering flexible flashing tape complying with AAMA 711, applied over all joints in the roof decking. A felt underlayment complying with ASTM D226 Type II, ASTM D4869 Type III or IV, or ASTM D6757, or a synthetic underlayment meeting the performance requirements specified, is required to be applied over the strips/tape over the entire roof.

☐ two layers of felt underlayment comply ASTM D226 Type II or ASTM D4869 Type III or IV, or two layers of a synthetic underlayment meeting the performance requirements specified, lapped and fastened as specified.

☒ Other (explain) 8"x12" flashing metal flashing installed under the above layer shingle, not to extend below the shingle the flashing is installed upon. A U-shaped bead of ASTM D4586 roof sealant is added to the underside of the flashing with the open side of the U pointing down the roof slope.

Contractor/Owners Signature

FINAL INSPECTION & CERTIFICATE OF COMPLETION:

This completed form and photographs must be uploaded to your permit via online at the Application Submission login (link) Welcome to Columbia County Online (columbiacountyfla.com).

Clearly visible in the Photographs must be the permit number or address and must include a ruler or measuring device to confirm nail spacing and overlaps including drip edge and valley flashing.

SUBCONTRACTOR VERIFICATION

APPLICATION/PERMIT # _____

JOB NAME Jerry Padrta

THIS FORM MUST BE SUBMITTED BEFORE A PERMIT WILL BE ISSUED

Columbia County issues combination permits. One permit will cover all trades doing work at the permitted site. It is **REQUIRED** that we have records of the subcontractors who actually did the trade specific work under the general contractors permit.

NOTE: It shall be the responsibility of the general contractor to make sure that all of the subcontractors are licensed with the Columbia County Building Department.

Use website to confirm licenses: <http://www.columbiacountyfla.com/PermitSearch/ContractorSearch.aspx>

NOTE: If this should change prior to completion of the project, it is your responsibility to have a corrected form submitted to our office, before that work has begun.

Violations will result in stop work orders and/or fines.

ELECTRICAL	Print Name <u>Brian Rollins</u>	Signature <u>[Signature]</u>	Need <input type="checkbox"/> Lic <input type="checkbox"/> Liab <input type="checkbox"/> W/C <input type="checkbox"/> EX <input type="checkbox"/> DE
<input checked="" type="checkbox"/>	Company Name: <u>Encor Solar LLC</u>		
CC# _____	License #: <u>CVC57229</u>	Phone #: <u>(801) 992-1635</u>	
MECHANICAL/ A/C	Print Name _____	Signature _____	Need <input type="checkbox"/> Lic <input type="checkbox"/> Liab <input type="checkbox"/> W/C <input type="checkbox"/> EX <input type="checkbox"/> DE
<input type="checkbox"/>	Company Name: _____		
CC# _____	License #: _____	Phone #: _____	
PLUMBING/ GAS	Print Name _____	Signature _____	Need <input type="checkbox"/> Lic <input type="checkbox"/> Liab <input type="checkbox"/> W/C <input type="checkbox"/> EX <input type="checkbox"/> DE
<input type="checkbox"/>	Company Name: _____		
CC# _____	License #: _____	Phone #: _____	
ROOFING	Print Name _____	Signature _____	Need <input type="checkbox"/> Lic <input type="checkbox"/> Liab <input type="checkbox"/> W/C <input type="checkbox"/> EX <input type="checkbox"/> DE
<input type="checkbox"/>	Company Name: _____		
CC# _____	License #: _____	Phone #: _____	
SHEET METAL	Print Name _____	Signature _____	Need <input type="checkbox"/> Lic <input type="checkbox"/> Liab <input type="checkbox"/> W/C <input type="checkbox"/> EX <input type="checkbox"/> DE
<input type="checkbox"/>	Company Name: _____		
CC# _____	License #: _____	Phone #: _____	
FIRE SYSTEM/ SPRINKLER	Print Name _____	Signature _____	Need <input type="checkbox"/> Lic <input type="checkbox"/> Liab <input type="checkbox"/> W/C <input type="checkbox"/> EX <input type="checkbox"/> DE
<input type="checkbox"/>	Company Name: _____		
CC# _____	License #: _____	Phone #: _____	
SOLAR	Print Name _____	Signature _____	Need <input type="checkbox"/> Lic <input type="checkbox"/> Liab <input type="checkbox"/> W/C <input type="checkbox"/> EX <input type="checkbox"/> DE
<input type="checkbox"/>	Company Name: _____		
CC# _____	License #: _____	Phone #: _____	
STATE SPECIALTY	Print Name _____	Signature _____	Need <input type="checkbox"/> Lic <input type="checkbox"/> Liab <input type="checkbox"/> W/C <input type="checkbox"/> EX <input type="checkbox"/> DE
<input type="checkbox"/>	Company Name: _____		
CC# _____	License #: _____	Phone #: _____	

SITE PLAN CHECKLIST

- SITE PLAN CHECKLIST**
- ___ 1) Property Dimensions
 - ___ 2) Footprint of proposed and existing structures (including decks), label these with existing addresses
 - ___ 3) Distance from structures to all property lines
 - ___ 4) Location and size of easements
 - ___ 5) Driveway path and distance at the entrance to the nearest property line
 - ___ 6) Location and distance from any waters; sink holes; wetlands; and etc.
 - ___ 7) Show slopes and or drainage paths
 - ___ 8) Arrow showing North direction

SITE PLAN EXAMPLE

Revised 7/1/15

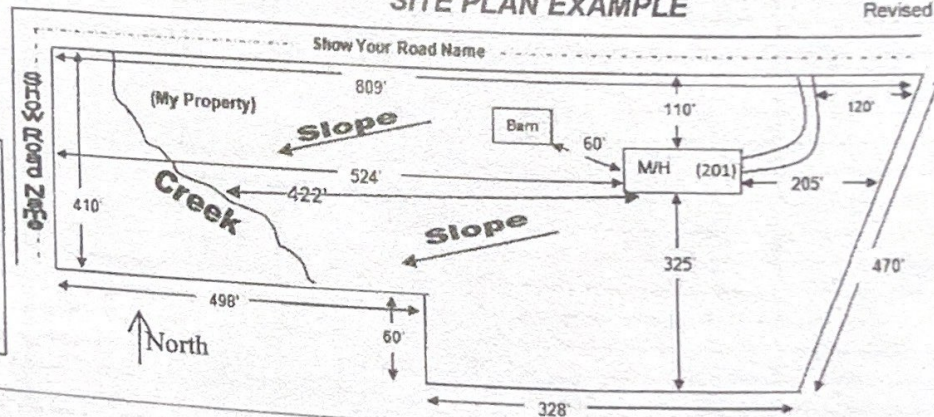

NOTE:

This site plan can be copied and used with the 911 Addressing Dept. application forms.

As required by Florida Statute 553.842 and Florida Administrative Code 9B-72, please provide the information and approval numbers on the building components listed below if they will be utilized on the construction project for which you are applying for a building permit. We recommend you contact your local product supplier should you not know the product approval number for any of the applicable listed products. Statewide approved products are listed online @ www.floridabuilding.org

Category/Subcategory	Manufacturer	Product Description	Approval Number(s)
1. EXTERIOR DOORS			
A. SWINGING			
B. SLIDING			
C. SECTIONAL/ROLL UP			
D. OTHER			
2. WINDOWS			
A. SINGLE/DOUBLE HUNG			
B. HORIZONTAL SLIDER			
C. CASEMENT			
D. FIXED			
E. MULLION			
F. SKYLIGHTS			
G. OTHER			
3. PANEL WALL			
A. SIDING			
B. SOFFITS			
C. STOREFRONTS			
D. GLASS BLOCK			
E. OTHER			
4. ROOFING PRODUCTS			
A. ASPHALT SHINGLES			
B. NON-STRUCT METAL			
C. ROOFING TILES			
D. SINGLE PLY ROOF			
E. OTHER			
5. STRUCT COMPONENTS			
A. WOOD CONNECTORS			
B. WOOD ANCHORS			
C. TRUSS PLATES			
D. INSULATION FORMS			
E. LINTELS			
F. OTHERS			
6. NEW EXTERIOR ENVELOPE PRODUCTS			

The products listed below did not demonstrate product approval at plan review. I understand that at the time of inspection of these products, the following information must be available to the inspector on the jobsite; 1) copy of the product approval, 2) performance characteristics which the product was tested and certified to comply with, 3) copy of the applicable manufacturers installation requirements. Further, I understand these products may have to be removed if approval cannot be demonstrated during inspection.

NOTES: _____

