

DATE 07/21/2005

Columbia County Building Permit

PERMIT

This Permit Expires One Year From the Date of Issue

000023400

APPLICANT HUGO ESCALANTE PHONE 288-8666
ADDRESS 6210 SW CR 18 FT. WHITE FL 32038
OWNER HUGO ESCALANTE PHONE 288-8666
ADDRESS 203 SW ROUND HOUSE COURT FT. WHITE FL 32038
CONTRACTOR HUGO ESCALANTE PHONE 288-8666
LOCATION OF PROPERTY 47S, TL ON 27, TL ON CR 18, TR ON DEPOT WAY, TL ON
ROUND HOUSE CT, 5TH LOT ON LEFT

TYPE DEVELOPMENT SFD,UTILITY ESTIMATED COST OF CONSTRUCTION 79000.00
HEATED FLOOR AREA 1580.00 TOTAL AREA 2116.00 HEIGHT .00 STORIES 1
FOUNDATION CONC WALLS FRAMED ROOF PITCH 6/12 FLOOR SLAB
LAND USE & ZONING FT WHITE MAX. HEIGHT 18
Minimum Set Back Requirments: STREET-FRONT REAR SIDE
NO. EX.D.U. 0 FLOOD ZONE FW DEVELOPMENT PERMIT NO.

PARCEL ID 34-6S-16-04059-114 SUBDIVISION FT. WHITE STATION
LOT 14 BLOCK PHASE UNIT TOTAL ACRES

Culvert Permit No. Culvert Waiver Contractor's License Number CRC1326967
Applicant/Owner/Contractor
EXISTING 05-0728-N BK Y
Driveway Connection Septic Tank Number LU & Zoning checked by Approved for Issuance New Resident

COMMENTS: FT WHITE LETTER RECEIVED, NOC ON FILE

Check # or Cash 2777

FOR BUILDING & ZONING DEPARTMENT ONLY

(footer/Slab)

Temporary Power date/app. by Foundation date/app. by Monolithic date/app. by
Under slab rough-in plumbing date/app. by Slab date/app. by Sheathing/Nailing date/app. by
Framing date/app. by Rough-in plumbing above slab and below wood floor date/app. by
Electrical rough-in date/app. by Heat & Air Duct date/app. by Peri. beam (Lintel) date/app. by
Permanent power date/app. by C.O. Final date/app. by Culvert date/app. by
M/H tie downs, blocking, electricity and plumbing date/app. by Pool date/app. by
Reconnection date/app. by Pump pole date/app. by Utility Pole date/app. by
M/H Pole date/app. by Travel Trailer date/app. by Re-roof date/app. by

BUILDING PERMIT FEE \$ 395.00 CERTIFICATION FEE \$ 10.58 SURCHARGE FEE \$ 10.58
MISC. FEES \$.00 ZONING CERT. FEE \$ FIRE FEE \$ WASTE FEE \$
FLOOD ZONE DEVELOPMENT FEE \$ CULVERT FEE \$ TOTAL FEE 416.16

INSPECTORS OFFICE Clerk's Office

NOTICE: IN ADDITION TO THE REQUIREMENTS OF THIS PERMIT, THERE MAY BE ADDITIONAL RESTRICTIONS APPLICABLE TO THIS PROPERTY THAT MAY BE FOUND IN THE PUBLIC RECORDS OF THIS COUNTY. AND THERE MAY BE ADDITIONAL PERMITS REQUIRED FROM OTHER GOVERNMENTAL ENTITIES SUCH AS WATER MANAGEMENT DISTRICTS, STATE AGENCIES, OR FEDERAL AGENCIES.

"WARNING TO OWNER: YOUR FAILURE TO RECORD A NOTICE OF COMMENCEMENT MAY RESULT IN YOUR PAYING TWICE FOR IMPROVEMENTS TO YOUR PROPERTY. IF YOU INTEND TO OBTAIN FINANCING, CONSULT WITH YOUR LENDER OR AN ATTORNEY BEFORE RECORDING YOUR NOTICE OF COMMENCEMENT."

This Permit Must Be Prominently Posted on Premises During Construction

PLEASE NOTIFY THE COLUMBIA COUNTY BUILDING DEPARTMENT AT LEAST 24 HOURS IN ADVANCE OF EACH INSPECTION, IN ORDER THAT IT MAY BE MADE WITHOUT DELAY OR INCONVENIENCE, PHONE 758-1008. THIS PERMIT IS NOT VALID UNLESS THE WORK AUTHORIZED BY IT IS COMMENCED WITHIN 6 MONTHS AFTER ISSUANCE.

The Issuance of this Permit Does Not Waive Compliance by Permittee with Deed Restrictions.

Columbia County Building Permit Application

416-16

Revised 9-23-04

For Office Use Only Application # 0507-38 Date Received 7/13/05 By G Permit # 23400
Application Approved by - Zoning Official _____ Date _____ Plans Examiner OK JTH Date 7-18-05
Flood Zone _____ Development Permit _____ Zoning _____ Land Use Plan Map Category _____
Comments En. Health. See Town Z # White

Applicants Name Hugo Escalante Phone 386-288-8666
Address 6210 S.W. CR 18, Ft White, FL 32038
Owners Name Hugo Escalante Phone 386-288-8666
911 Address 903 S.W. Round House Court, Fort White, FL 32038
Contractors Name Hugo Escalante Phone 386-288-8666
Address P.O. Box 280, FT White, FL 32038
Fee Simple Owner Name & Address None
Bonding Co. Name & Address None
Architect/Engineer Name & Address Daniel Sharheen, Lake City, FL
Mortgage Lenders Name & Address None

Circle the correct power company - FL Power & Light - Clay Elec. - Suwannee Valley Elec. - Progressive Energy
Property ID Number 34-68-16-04059-114 Estimated Cost of Construction 115,000
Subdivision Name Fort White Station Lot 14 Block _____ Unit _____ Phase _____
Driving Directions 47 South to US 97 Fort White, make left to CR 18 make left
1/4 mile make right on Depot way, go to end make left lot 14 on left
side last Nat. Nat. lot 14 5th lot on left
Type of Construction New SFR Number of Existing Dwellings on Property 0
Total Acreage .5 Lot Size 1/2 Acre Do you need a - Culvert Permit or Culvert Waiver or Have an Existing Drive
Actual Distance of Structure from Property Lines - Front 65' Side 15' Side 15' Rear 75'
Total Building Height 18'-6" Number of Stories 1 Heated Floor Area 1580 Sq Ft Roof Pitch 6-12
PORCHES 92 GARAGE 444 TOTAL 2116

Application is hereby made to obtain a permit to do work and installations as indicated. I certify that no work or installation has commenced prior to the issuance of a permit and that all work be performed to meet the standards of all laws regulating construction in this jurisdiction.

OWNERS AFFIDAVIT: I hereby certify that all the foregoing information is accurate and all work will be done in compliance with all applicable laws and regulating construction and zoning.

WARNING TO OWNER: YOUR FAILURE TO RECORD A NOTICE OF COMMENCEMENT MAY RESULT IN YOU PAYING TWICE FOR IMPROVEMENTS TO YOUR PROPERTY. IF YOU INTEND TO OBTAIN FINANCING, CONSULT WITH YOUR LENDER OR ATTORNEY BEFORE RECORDING YOUR NOTICE OF COMMENCEMENT.

Hugo Escalante
Owner/Builder or Agent (Including Contractor)

Hugo Escalante
Contractor Signature

STATE OF FLORIDA
COUNTY OF COLUMBIA



Sworn to (or affirmed) and subscribed before me
this 13th day of July 2005.

Personally known ✓ or Produced Identification _____

Contractors License Number CRC1326967
Competency Card Number _____
NOTARY STAMP/SEAL

Mildred J. King
Notary Signature

ADVISOR NUGS 7-20-05

**STATE OF FLORIDA
DEPARTMENT OF HEALTH
APPLICATION FOR ONSITE SEWAGE DISPOSAL SYSTEM CONSTRUCTION PERMIT**

PART II - SITEPLAN

A hand-drawn site plan of a property. The plan shows a large triangular-shaped lot. At the top, a road labeled "ROUND HOUSE COURT" runs along the boundary. A "ROAD DITCH" is shown adjacent to the road. A "CON DRIVE" (concrete drive) leads from the road into the lot. The lot is divided into several sections. A central rectangular area is labeled "1530 SQ" with dimensions "32" and "52". To the left of this area is a smaller rectangular section labeled "GAR" (garage) with a width of "25'". Below the garage is a "BM" (benchmark) and a "20'" dimension. The lot is surrounded by "VACANT" land on three sides. A "NORTH" arrow points towards the top right. A "90°" angle is marked between two lines, with "WL" (water line) and "WEL" (well) labels. Other dimensions include "196", "160", "32'", "159'", "30'", and "22.5'".

Site Plan submitted by: Roch D 7-11-05 **MASTER CONTRACTOR**
Plan Approved ✓ Not Approved 7-11-05 Date JUL 16 2005
By mm 7-11-05 Columbia County Health Department

Page 2 of 4

This Instrument was prepared by:
Hugo Escalante
P.O. BOX 280
Fort White, FL 32038

QUITCLAIM DEED

THIS QUITCLAIM DEED, Executed this 9th day of May, 2005 by first party (Grantor), **GIT Properties and Investment, Inc.**, as to 100% interest whose post office address is P.O. BOX 280, Fort White, FL 32038 to second party (Grantees), **Hugo Escalante** as to 100% interest whose post office address is P.O. BOX 280, Fort White, FL 32038.

WITNESSETH, That the said first party, for good consideration, maintenance, up kept and for the sum of \$10.00 paid by the said second party, the receipt whereof is hereby acknowledged, does hereby remise, release and quitclaim unto the said second party forever, all the right, title, interest and claim which the said first party has in and to the following described parcel of land, and improvements and appurtenances thereto in the County of Columbia, State of Florida to wit:

Lot 14, Fort White Station, a subdivision according to the plat thereof recorded in Plat Book 5, Page 128, of the Public Records of Columbia County, Florida.

Parcel Number: 34-6S-16-04059-114

Grantor(s) warrants that at the time of this conveyance, the subject property is not Grantor's (s) homestead within the meaning set forth in the state of Florida, nor is it contiguous to or a part of homestead property.

IN WITNESS WHEREOF, The said first party has signed and sealed these presents the day and year first above written.

Signed, sealed and delivered in presence of:

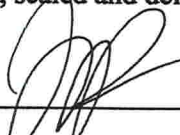

Witness Name: JUAN J. PEREZ



Witness Name: Luis CANDOR



Carlos Clavell
GIT Properties & Investment Inc

STATE OF Florida)
COUNTY OF DADE)

The foregoing instrument was acknowledged before me this the 13 day of MAY, 2005 by Carlos Clavell, who personally known to me or has produced FL D.L. as identification and who did/did not take an oath.

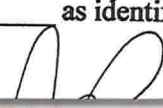

Lod 14 Ford White Station
Parcel # 34-68-16-04059-114

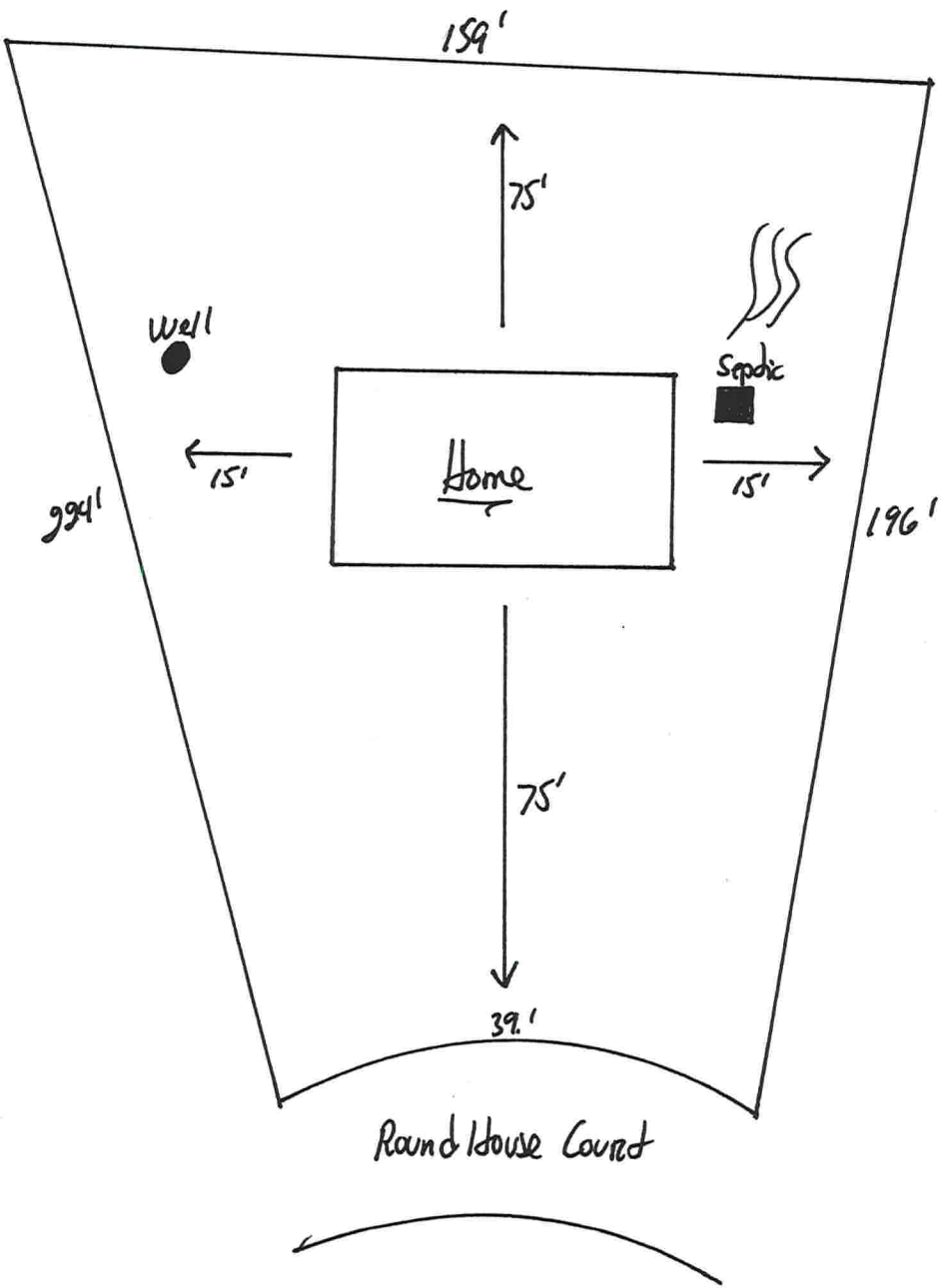

NOTICE OF COMMENCEMENT FORM
COLUMBIA COUNTY, FLORIDA

THE UNDERSIGNED hereby gives notice that improvement will be made to certain real property, and in accordance with Chapter 713, Florida Statutes, the following information is provided in this Notice of Commencement.

Tax Parcel ID Number 34-68-16-04059-114

1. Description of property: (legal description of the property and street address or 911 address)
Lot 14 Fort White Station S/D. ORB 666-262. SWD 1009-1613
QC 1038-1158
911 Address: 903 S.W. Roundhouse Ct, Fort White, FL 32038
2. General description of improvement: New Single Family Dwelling
3. Owner Name & Address Hugo Escobedo, P.O. Box 280, Fort White, FL 32038
Interest in Property 100%
4. Name & Address of Fee Simple Owner (if other than owner): None
5. Contractor Name Hugo Escobedo (EWPL INC) Phone Number 386-288-8666
Address P.O. Box 280, Fort White, FL 32038
6. Surety Holders Name None
Address _____
Amount of Bond _____
Inst: 2005016463 Date: 07/13/2005 Time: 10:34
MK DC, P. DeWitt Cason, Columbia County B: 1051 P: 1802
7. Lender Name None
Address _____
8. Persons within the State of Florida designated by the Owner upon whom notices or other documents may be served as provided by section 718.13 (1)(a) 7; Florida Statutes:
Name Hugo Escobedo Phone Number 386-288-8666
Address 6210 S.W. CR 18 Fort White, FL 32038
9. In addition to himself/herself the owner designates Marleen Escobedo of Fort White, FL to receive a copy of the Lienor's Notice as provided in Section 713.13 (1) - (a) 7. Phone Number of the designee 386-288-8666
10. Expiration date of the Notice of Commencement (the expiration date is 1 (one) year from the date of recording, (Unless a different date is specified) _____

NOTICE AS PER CHAPTER 713, Florida Statutes:

The owner must sign the notice of commencement and no one else may be permitted to sign in his/her stead.

Hugo Escobedo
Signature of Owner

Sworn to (or, affirmed) and subscribed before
day of July 13, 2005

NOTARY STAMP/SEAL



Mildred J. King
Signature of Notary

COLUMBIA COUNTY 9-1-1 ADDRESSING

263 NW Lake City Ave. * P. O. Box 1787 * Lake City, FL 32056-1787
PHONE: (386) 758-1125 * FAX: (386) 758-1365 * Email: ron_croft@columbiacountyfla.com

Addressing Maintenance

To maintain the Countywide Addressing Policy you must make application for a 9-1-1 Address at the time you apply for a building permit. The established standards for assigning and posting numbers to all principal buildings, dwellings, businesses and industries are contained in Columbia County Ordinance 2001-9. The addressing system is to enable Emergency Service Agencies to locate you in an emergency, and to assist the United States Postal Service and the public in the timely and efficient provision of services to residents and businesses of Columbia County.

DATE ISSUED: June 29 2005

ENHANCED 9-1-1 ADDRESS:

203 SW ROUND HOUSE CT (FORT WHITE, FL 32038)

Addressed Location 911 Phone Number: NOT AVAIL.

OCCUPANT NAME: NOT AVAIL.

OCCUPANT CURRENT MAILING ADDRESS: _____

PROPERTY APPRAISER MAP SHEET NUMBER: 53D

PROPERTY APPRAISER PARCEL NUMBER: 24-3S-16-04059-114

Other Contact Phone Number (If any): _____

Building Permit Number (If known): _____

Remarks: LOT 14, FORT WHITE STATION S/D

Address Issued By: _____

Columbia County 9-1-1 Addressing / GIS Department

NOTICE: THIS ADDRESS WAS ISSUED BASED ON LOCATION INFORMATION RECEIVED FROM THE REQUESTER. SHOULD, AT A LATER DATE, THE LOCATION INFORMATION BE FOUND TO BE IN ERROR, THIS ADDRESS IS SUBJECT TO CHANGE.

COLUMBIA COUNTY
9-1-1 ADDRESSING
APPROVED

Town of Fort White

Post Office Box 129 Fort White, Florida 32038-0129
Town Hall - (386) 497-2321 • Public Works - (386) 497-3345
Email: townofftwhite@alltel.com • Web site: Townoffortwhitefl.com

CERTIFICATE OF COMPLIANCE & REQUEST FOR ISSUANCE OF BUILDING PERMIT

The undersigned hereby certify the following property is in compliance with the Town of Fort
White's Comprehensive Plan and Land Development Regulations for the stated development purposes:

OWNER'S NAME: Hugo Escalante

ADDRESS: 6210 SW CR 18 Fort White, FL 32038

PROPERTY DESCRIPTION: Parcel # 24-3S-16-04059-114
(parcel number if possible) Lot # 14 Fort White Station

DEVELOPMENT: Single Family REsidence

You are hereby authorized to issue the appropriate building permits.

7/11/05

DATE

LAND DEVELOPMENT REGULATION
ADMINISTRATOR
TOWN OF FORT WHITE

District #1
Donald Cook
497-1086

District #2
Henry Maini
497-2992

District #3
John Gloskowski
497-3999

District #4
Demetric Jackson
497-2078

Mayor
Truett George
497-4741

FLORIDA ENERGY EFFICIENCY CODE
FOR BUILDING CONSTRUCTION

Florida Department of Community Affairs
Residential Whole Building Performance Method A

Project Name:	EWPL Lot 14 Fort White Station	Builder:	EWPL Inc.
Address:	Lot: 22 , Sub: Fort White Stat, Plat:	Permitting Office:	Columbia
City, State:	Fort White, FL 32038-	Permit Number:	23400
Owner:	Hugo Escalante	Jurisdiction Number:	221000
Climate Zone:	North		

1. New construction or existing	New	12. Cooling systems	
2. Single family or multi-family	Single family	a. Central Unit	Cap: 30.0 kBtu/hr
3. Number of units, if multi-family	1		SEER: 10.00
4. Number of Bedrooms	3	b. N/A	
5. Is this a worst case?	Yes	c. N/A	
6. Conditioned floor area (ft²)	1580 ft²		
7. Glass area & type		13. Heating systems	
a. Clear - single pane	0.0 ft²	a. Electric Heat Pump	Cap: 30.0 kBtu/hr
b. Clear - double pane	190.3 ft²		HSPF: 6.80
c. Tint/other SHGC - single pane	0.0 ft²	b. N/A	
d. Tint/other SHGC - double pane	0.0 ft²	c. N/A	
8. Floor types		14. Hot water systems	
a. Slab-On-Grade Edge Insulation	R=0.0, 181.0(p) ft	a. Electric Resistance	Cap: 40.0 gallons
b. N/A			EF: 0.88
c. N/A		b. N/A	
9. Wall types		c. Conservation credits	
a. Frame, Wood, Exterior	R=13.0, 1396.0 ft²	(HR-Heat recovery, Solar	
b. Frame, Wood, Adjacent	R=13.0, 200.0 ft²	DHP-Dedicated heat pump)	
c. N/A		15. HVAC credits	CF,
d. N/A		(CF-Ceiling fan, CV-Cross ventilation,	
e. N/A		HF-Whole house fan,	
10. Ceiling types		PT-Programmable Thermostat,	
a. Under Attic	R=30.0, 1580.0 ft²	MZ-C-Multizone cooling,	
b. N/A		MZ-H-Multizone heating)	
c. N/A			
11. Ducts			
a. Sup: Unc. Ret: Unc. AH: Interior	Sup. R=6.0, 120.0 ft		
b. N/A			

Glass/Floor Area: 0.12

Total as-built points: 23796
Total base points: 26123

PASS

I hereby certify that the plans and specifications covered by this calculation are in compliance with the Florida Energy Code.

PREPARED BY: [Signature]

DATE: 6-6-05

I hereby certify that this building, as designed, is in compliance with the Florida Energy Code.

OWNER/AGENT: _____

DATE: _____

Review of the plans and specifications covered by this calculation indicates compliance with the Florida Energy Code. Before construction is completed this building will be inspected for compliance with Section 553.908 Florida Statutes.

BUILDING OFFICIAL: _____

DATE: _____



Code Compliance Checklist

Residential Whole Building Performance Method A - Details

ADDRESS: Lot: 27, Sub: Fort White Stat, Plat: , Fort White, FL, 32038-

PERMIT #:

6A-21 INFILTRATION REDUCTION COMPLIANCE CHECKLIST

COMPONENTS	SECTION	REQUIREMENTS FOR EACH PRACTICE	CHECK
Exterior Windows & Doors	606.1.ABC.1.1	Maximum: .3 cfm/sq.ft. window area; .5 cfm/sq.ft. door area.	
Exterior & Adjacent Walls	606.1.ABC.1.2.1	Caulk, gasket, weatherstrip or seal between: windows/doors & frames, surrounding wall; foundation & wall sole or sill plate; joints between exterior wall panels at corners; utility penetrations; between wall panels & top/bottom plates; between walls and floor. EXCEPTION: Frame walls where a continuous infiltration barrier is installed that extends from, and is sealed to, the foundation to the top plate.	
Floors	606.1.ABC.1.2.2	Penetrations/openings >1/8" sealed unless backed by truss or joint members. EXCEPTION: Frame floors where a continuous infiltration barrier is installed that is sealed to the perimeter, penetrations and seams.	
Ceilings	606.1.ABC.1.2.3	Between walls & ceilings; penetrations of ceiling plane of top floor; around shafts, chases, soffits, chimneys, cabinets sealed to continuous air barrier; gaps in gyp board & top plate; attic access. EXCEPTION: Frame ceilings where a continuous infiltration barrier is installed that is sealed at the perimeter, at penetrations and seams.	
Recessed Lighting Fixtures	606.1.ABC.1.2.4	Type IC rated with no penetrations, sealed; or Type IC or non-IC rated, installed inside a sealed box with 1/2" clearance & 3" from insulation; or Type IC rated with < 2.0 cfm from conditioned space, tested.	
Multi-story Houses	606.1.ABC.1.2.5	Air barrier on perimeter of floor cavity between floors.	
Additional Infiltration reqts	606.1.ABC.1.3	Exhaust fans vented to outdoors, dampers; combustion space heaters comply with NFPA, have combustion air.	

6A-22 OTHER PRESCRIPTIVE MEASURES (must be met or exceeded by all residences.)

COMPONENTS	SECTION	REQUIREMENTS	CHECK
Water Heaters	612.1	Comply with efficiency requirements in Table 6-12. Switch or clearly marked circuit breaker (electric) or cutoff (gas) must be provided. External or built-in heat trap required.	
Swimming Pools & Spas	612.1	Spas & heated pools must have covers (except solar heated). Non-commercial pools must have a pump timer. Gas spa & pool heaters must have a minimum thermal efficiency of 78%.	
Shower heads	612.1	Water flow must be restricted to no more than 2.5 gallons per minute at 80 PSIG.	
Air Distribution Systems	610.1	All ducts, fittings, mechanical equipment and plenum chambers shall be mechanically attached, sealed, insulated, and installed in accordance with the criteria of Section 610. Ducts in unconditioned attics: R-6 min. insulation.	
HVAC Controls	607.1	Separate readily accessible manual or automatic thermostat for each system.	
Insulation	604.1, 602.1	Ceilings-Min. R-19. Common walls-Frame R-11 or CBS R-3 both sides. Common ceiling & floors R-11.	

WATER HEATING & CODE COMPLIANCE STATUS
Residential Whole Building Performance Method A - Details

ADDRESS: Lot: 27, Sub: Fort White Stat, Plat: , Fort White, FL, 32038-

PERMIT #:

BASE					AS-BUILT						
WATER HEATING											
Number of Bedrooms	X	Multiplier	=	Total	Tank Volume	EF	Number of Bedrooms	X	Tank X Ratio	Multiplier X	Credit = Total Multiplier
3		2746.00		8238.0	40.0	0.88	3		1.00	2746.00	1.00 8238.0
					As-Built Total:						8238.0

CODE COMPLIANCE STATUS											
BASE						AS-BUILT					
Cooling Points	+	Heating Points	+	Hot Water Points	= Total Points	Cooling Points	+	Heating Points	+	Hot Water Points	= Total Points
8869		9016		8238	26123	7381		8177		8238	23796

PASS



WINTER CALCULATIONS

Residential Whole Building Performance Method A - Details

ADDRESS: Lot: 27, Sub: Fort White Stat, Plat: , Fort White, FL, 32038-

PERMIT #:

BASE				AS-BUILT							
Winter Base Points:		14371.2		Winter As-Built Points:						14030.8	
Total Winter Points	X	System Multiplier	= Heating Points	Total Component	X	Cap Ratio	X Duct Multiplier	X System Multiplier	X Credit Multiplier	= Heating Points	
				(DM x DSM x AHU)							
14371.2		0.6274	9016.5	14030.8	1.000	(1.069 x 1.169 x 0.93)	0.501	1.000		8177.2	
				14030.8	1.00	1.162	0.501	1.000		8177.2	

WINTER CALCULATIONS

Residential Whole Building Performance Method A - Details

ADDRESS: Lot: 27, Sub: Fort White Stat, Plat: , Fort White, FL, 32038-

PERMIT #:

BASE				AS-BUILT							
GLASS TYPES .18 X Conditioned X BWPM = Points Floor Area				Type/SC	Overhang Ornt Len Hgt Area X WPM X WOF = Points						
.18	1580.0	12.74	3623.3	Double, Clear	W	1.5	8.0	36.0	10.77	1.01	391.9
				Double, Clear	W	9.0	10.0	13.3	10.77	1.16	165.9
				Double, Clear	W	9.0	10.0	6.0	10.77	1.16	74.7
				Double, Clear	W	1.5	6.0	17.5	10.77	1.02	192.8
				Double, Clear	N	1.5	6.0	30.0	14.30	1.00	430.1
				Double, Clear	E	1.5	6.0	17.5	9.09	1.04	164.7
				Double, Clear	E	1.5	7.5	20.0	9.09	1.02	186.0
				Double, Clear	E	1.5	6.0	30.0	9.09	1.04	282.4
				Double, Clear	S	1.0	7.0	20.0	4.03	1.01	81.3
				As-Built Total: 190.3 1969.8							
WALL TYPES Area X BWPM = Points				Type	R-Value Area X WPM = Points						
Adjacent	200.0	3.60	720.0	Frame, Wood, Exterior			13.0	1396.0	3.40		4746.4
Exterior	1396.0	3.70	5165.2	Frame, Wood, Adjacent			13.0	200.0	3.30		660.0
Base Total: 1596.0 5885.2				As-Built Total: 1596.0 5406.4							
DOOR TYPES Area X BWPM = Points				Type	Area X WPM = Points						
Adjacent	18.0	11.50	207.0	Exterior Wood				20.0	12.30		246.0
Exterior	60.0	12.30	738.0	Adjacent Wood				18.0	11.50		207.0
				Exterior Wood				40.0	12.30		492.0
Base Total: 78.0 945.0				As-Built Total: 78.0 945.0							
CEILING TYPESArea X BWPM = Points				Type	R-Value Area X WPM X WCM = Points						
Under Attic	1580.0	2.05	3239.0	Under Attic			30.0	1580.0	2.05 X 1.00		3239.0
Base Total: 1580.0 3239.0				As-Built Total: 1580.0 3239.0							
FLOOR TYPES Area X BWPM = Points				Type	R-Value Area X WPM = Points						
Slab	181.0(p)	8.9	1610.9	Slab-On-Grade Edge Insulation			0.0	181.0(p)	18.80		3402.8
Raised	0.0	0.00	0.0								
Base Total: 1610.9				As-Built Total: 181.0 3402.8							
INFILTRATION Area X BWPM = Points				Area X WPM = Points							
	1580.0	-0.59	-932.2	1580.0 -0.59 -932.2							

SUMMER CALCULATIONS

Residential Whole Building Performance Method A - Details

ADDRESS: Lot: 27, Sub: Fort White Stat, Plat: , Fort White, FL, 32038- PERMIT #:

BASE				AS-BUILT							
Summer Base Points: 20790.0				Summer As-Built Points: 20009.8							
Total Summer Points	X	System Multiplier	= Cooling Points	Total Component	X	Cap Ratio	X Duct Multiplier (DM x DSM x AHU)	X System Multiplier	X Credit Multiplier	= Cooling Points	
20790.0		0.4266	8869.0	20009.8 20009.8		1.000 1.00	(1.090 x 1.147 x 0.91) 1.138	0.341 0.341	0.950 0.950	7381.3 7381.3	

SUMMER CALCULATIONS
Residential Whole Building Performance Method A - Details

ADDRESS: Lot: 27, Sub: Fort White Stat, Plat: , Fort White, FL, 32038- PERMIT #:

BASE				AS-BUILT							
GLASS TYPES .18 X Conditioned X BSPM = Points Floor Area				Type/SC Overhang Ormt Len Hgt Area X SPM X SOF = Points							
.18	1580.0	20.04	5699.4	Double, Clear	W	1.5	8.0	36.0	36.99	0.96	1275.7
				Double, Clear	W	9.0	10.0	13.3	36.99	0.55	273.4
				Double, Clear	W	9.0	10.0	6.0	36.99	0.55	123.0
				Double, Clear	W	1.5	6.0	17.5	36.99	0.91	591.2
				Double, Clear	N	1.5	6.0	30.0	19.22	0.94	541.2
				Double, Clear	E	1.5	6.0	17.5	40.22	0.91	642.5
				Double, Clear	E	1.5	7.5	20.0	40.22	0.95	763.1
				Double, Clear	E	1.5	6.0	30.0	40.22	0.91	1101.4
				Double, Clear	S	1.0	7.0	20.0	34.50	0.97	667.2
				As-Built Total: 190.3 5978.6							
WALL TYPES Area X BSPM = Points				Type R-Value Area X SPM = Points							
Adjacent	200.0	0.70	140.0	Frame, Wood, Exterior			13.0	1396.0	1.50		2094.0
Exterior	1396.0	1.70	2373.2	Frame, Wood, Adjacent			13.0	200.0	0.60		120.0
Base Total: 1596.0 2513.2				As-Built Total: 1596.0 2214.0							
DOOR TYPES Area X BSPM = Points				Type Area X SPM = Points							
Adjacent	18.0	2.40	43.2	Exterior Wood				20.0	6.10		122.0
Exterior	60.0	6.10	366.0	Adjacent Wood				18.0	2.40		43.2
				Exterior Wood				40.0	6.10		244.0
Base Total: 78.0 409.2				As-Built Total: 78.0 409.2							
CEILING TYPES Area X BSPM = Points				Type R-Value Area X SPM X SCM = Points							
Under Attic	1580.0	1.73	2733.4	Under Attic			30.0	1580.0	1.73 X 1.00		2733.4
Base Total: 1580.0 2733.4				As-Built Total: 1580.0 2733.4							
FLOOR TYPES Area X BSPM = Points				Type R-Value Area X SPM = Points							
Slab	181.0(p)	-37.0	-6697.0	Slab-On-Grade Edge Insulation			0.0	181.0(p)	-41.20		-7457.2
Raised	0.0	0.00	0.0								
Base Total: -6697.0				As-Built Total: 181.0 -7457.2							
INFILTRATION Area X BSPM = Points				Area X SPM = Points							
1580.0 10.21 16131.8				1580.0 10.21 16131.8							

ENERGY PERFORMANCE LEVEL (EPL) DISPLAY CARD

ESTIMATED ENERGY PERFORMANCE SCORE* = 84.0

The higher the score, the more efficient the home.

Hugo Escalante, Lot: 27, Sub: Fort White Stat, Plat: , Fort White, FL, 32038-

1. New construction or existing	New	12. Cooling systems	
2. Single family or multi-family	Single family	a. Central Unit	Cap: 30.0 kBtu/hr
3. Number of units, if multi-family	1		SEER: 10.00
4. Number of Bedrooms	3	b. N/A	
5. Is this a worst case?	Yes	c. N/A	
6. Conditioned floor area (ft ²)	1580 ft ²		
7. Glass area & type		13. Heating systems	
a. Clear - single pane	0.0 ft ²	a. Electric Heat Pump	Cap: 30.0 kBtu/hr
b. Clear - double pane	190.3 ft ²		HSPF: 6.80
c. Tint/other SHGC - single pane	0.0 ft ²	b. N/A	
d. Tint/other SHGC - double pane	0.0 ft ²	c. N/A	
8. Floor types		14. Hot water systems	
a. Slab-On-Grade Edge Insulation	R=0.0, 181.0(p) ft	a. Electric Resistance	Cap: 40.0 gallons
b. N/A			EF: 0.88
c. N/A		b. N/A	
9. Wall types		c. Conservation credits	
a. Frame, Wood, Exterior	R=13.0, 1396.0 ft ²	(HR-Heat recovery, Solar	
b. Frame, Wood, Adjacent	R=13.0, 200.0 ft ²	DHP-Dedicated heat pump)	
c. N/A		15. HVAC credits	CF,
d. N/A		(CF-Ceiling fan, CV-Cross ventilation,	
e. N/A		HF-Whole house fan,	
10. Ceiling types		PT-Programmable Thermostat,	
a. Under Attic	R=30.0, 1580.0 ft ²	RB-Attic radiant barrier,	
b. N/A		MZ-C-Multizone cooling,	
c. N/A		MZ-H-Multizone heating)	
11. Ducts			
a. Sup: Unc. Ret: Unc. AH: Interior	Sup. R=6.0, 120.0 ft		
b. N/A			

I certify that this home has complied with the Florida Energy Efficiency Code For Building Construction through the above energy saving features which will be installed (or exceeded) in this home before final inspection. Otherwise, a new EPL Display Card will be completed based on installed Code compliant features.

Builder Signature: _____ Date: _____

Address of New Home: _____ City/FL Zip: _____



**NOTE: The home's estimated energy performance score is only available through the FLA/RES computer program. This is not a Building Energy Rating. If your score is 80 or greater (or 86 for a US EPA/DOE EnergyStdTM designation), your home may qualify for energy efficiency mortgage (EEM) incentives if you obtain a Florida Energy Gauge Rating. Contact the Energy Gauge Hotline at 321/638-1492 or see the Energy Gauge web site at www.fsec.ucf.edu for information and a list of certified Raters. For information about Florida's Energy Efficiency Code For Building Construction, contact the Department of Community Affairs at 850/487-1824.*

EnergyGauge® (Version: FLRCPB v3.2)

COLUMBIA COUNTY OFFICE OF OCCUPANCY

COLUMBIA COUNTY, FLORIDA

Department of Building and Zoning Inspection

This Certificate of Occupancy is issued to the below named permit holder for the building and premises at the below named location, and certifies that the work has been completed in accordance with the Columbia County Building Code.

Parcel Number 34-6S-16-04059-114

Building permit No. 000023400

Use Classification SFD, UTILITY

Fire: 53.28

Permit Holder HUGO ESCALANTE

Waste: 110.25

Owner of Building HUGO ESCALANTE

Total: 163.53

Location: 203 SW ROUND HOUSE CRT, FT. WHITE, FL 32038



Date: 01/12/2006

Harry Dick
Building Inspector

POST IN A CONSPICUOUS PLACE
(Business Places Only)

