

TYPICAL WALL SECTION
SCALE: 1" = 1'-0"

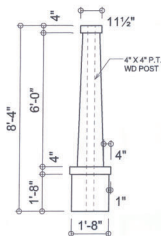

CRAFTSMAN COLUMN DETAIL
SCALE: 3/8" = 1'-0"



LEFT ELEVATION
SCALE: 1/4" = 1'-0"



RIGHT ELEVATION
SCALE: 1/4" = 1'-0"



REAR ELEVATION
SCALE: 1/4" = 1'-0"



FRONT ELEVATION
SCALE: 1/4" = 1'-0"

NOTE: ALL DRAWINGS NOT TO BE SCALED, WRITTEN DIMENSIONS TAKE PRECEDENCE OVER SCALED DIMENSIONS



REVISIONS	DATE	BY	APP
August 23, 2022			

SOFTPLAN
ARCHITECTURAL SOFTWARE

EXTERIOR ELEVATIONS
SCALE: 1/4" = 1'-0"

TYPICAL WALL SECTION
SCALE: 1" = 1'-0"

MODEL 1678 FOR:
LOT 46, CROSSWINDS
PROJECT ADDRESS: COLUMBIA COUNTY, FLORIDA
RHETT SMITHEY
LAKE CITY, FLORIDA

© WM DESIGN & ARCHITECTURE, LLC
428 NW COMMERCIAL CO. ST. 100
LAKE CITY, FL 32005
(386) 755-8406
info@wmdesign.com



JOB NUMBER
20220822

SHEET NUMBER
A.1

Wm C Smith

ELECTRICAL LEGEND	
	CEILING FAN (PRE-WIRE & LIGHT KIT)
	DOUBLE SWITCH LIGHT
	RECESSED LIGHT
	BATH EXHAUST
	LIGHT FIXTURE
	DUPLEX OUTLET (AFCI & TAMPER RESISTANT)
	220v OUTLET
	GFI DUPLEX OUTLET (PER NEC 408.8)
	TELEVISION
	CIRCUIT BREAKER (SPLIT A/C UNIT)
	SMOKE / CARBON MONOXIDE DETECTOR (see note below)
	WALL SWITCH
	3 WAY WALL SWITCH
	WATER PROOF OUTLET
	2 OR 4 TUB FLUORESCENT FIXTURE

NOTE:
ALL INTERIOR RECEPTACLES SHALL BE AFCI (ARC FAULT CIRCUIT INTERRUPTER) PER 210.12 & TAMPER RESISTANT PER NEC 408.11.
ALL INTERIOR & EXTERIOR LIGHTING SHALL MEET OR EXCEED THE MIN. 75% HIGH-EFFICIENCY LIGHTING PER IRC-ENERGY CONSERVATION R404.
ALL SMOKE DETECTORS BE A COMBINED CARBON MONOXIDE DETECTOR AND SHALL HAVE BATTERY BACKUP AND ALL WIRING TOGETHER TO A JUNCTION UNIT IS ACTIVATED THEY ALL ACTIVATE.
THE ELECTRICAL SERVICE OVERCURRENT PROTECTION DEVICE SHALL BE INSTALLED ON THE EXTERIOR OF THE STRUCTURE TO SERVE AS A DISCONNECT MEANS. CONDUCTORS USED FROM THE EXTERIOR DISCONNECTING MEANS TO A PANEL OR SUB PANEL SHALL HAVE FOUR-WIRE CORDING, OF WHICH ONE CONDUCTOR SHALL BE USED AS AN EQUIPMENT GROUND.
IT IS THE LICENSED ELECTRICAL CONTRACTOR'S RESPONSIBILITY TO INSURE THAT ALL WORK PERFORMED AND EQUIPMENT USED MEETS OR EXCEEDS THE 2017 (NFPA-70) NATIONAL ELECTRIC CODE AND ALL OTHER LOCAL CODES AND ORDINANCES.

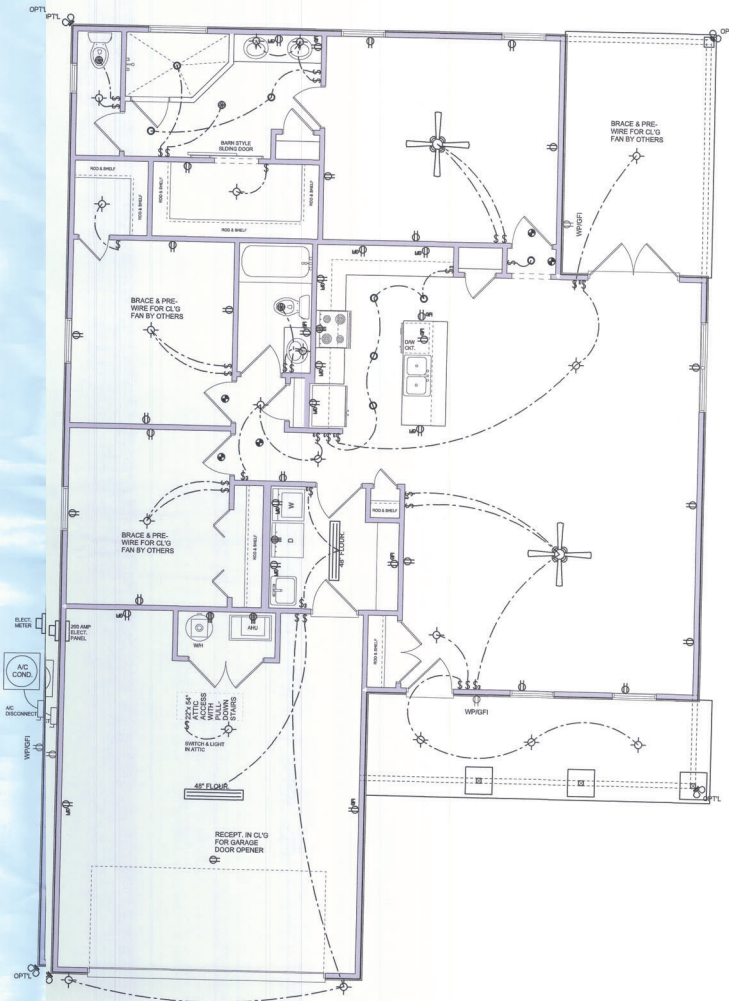

ELECTRICAL PLAN
SCALE: 1/8" = 1'-0"

NOTE: ALL DRAWINGS NOT TO BE SCALED, WRITTEN DIMENSIONS TAKE PRECEDENCE OVER SCALED DIMENSIONS

REVISIONS
August 23, 2022

SOFTWARE
REVISED: 08/23/2022 BY: JMS

ELECTRICAL PLAN SCALE: 1/8" = 1'-0"

MODEL 1678 FOR
LOT 46, CROSSWINDS
PROJECT ADDRESS: COLUMBIA COUNTY, FLORIDA
RHETT SMITHEY
LAKE CITY, FLORIDA

© WILSON &
ASSOCIATES, INC.
425 NW COMMERCE DR. STE 1X
LAKE CITY, FL 32025
(386) 758-8406
info@wilsoninc.com



JOB NUMBER
20220822

SHEET NUMBER

A.3

W.C. Smith

FLORIDA BUILDING CODE

Compliance Summary

TYPE OF CONSTRUCTION

Roof: Gable & Hip Construction, Wood Trusses @ 24" O
Walls: 2x4 Wood Studs @ 16" O.C.
Floor: 4" Thick Concrete Slab W/ 4x4 rebar @ 24" O.C. ea. way
Foundation: Continuous monolithic footing or Stem Wall foundation system

ROOF DECKING

Material: 5/8" CD Plywood or O.S.B.
Sheet Size: 48"X96" Sheets Perpendicular to Roof Framing
Fasteners: 8d Common or ring-shank nails per schedule on sheet 5.4

SHEARWALLS

Material: 1/2" CD Plywood or 7/16" O.S.B.
Sheet Size: 48"X96" Sheets Parallel Vertical, stagger each sheet.
Fasteners: 8d Common Nails @ 4" O.C. Edges & 8" O.C. Interior
Dragonage: Double Top Plate @ 16" O.C. W/ 16d Nails @ 12" O.C.
Wall Studs: 2x4 Wood Studs @ 16" O.C.

HURRICANE UPLIFT CONNECTORS

Truss Anchors: SIMPSON H2.5A (OR EQUIVALENT), W/ 6 - 10d NAILS
Wall Tension: Wall Sheathing Nailing is Adequate - 8d @ 4" O.C. Top & Bot.
Anchor Bolts: 1/2" A307 Rods @ 48" O.C. - 1st Bolt 1' from corner
Corner Hold-down Device: (1) DT22 (or equiv.) @ each corner
Post Column Base Connector: Simpson ABU44/ABU66 @ each column
Post Column to Beam Connector: Simpson EPC44/EPC44 @ each column

FOOTINGS AND FOUNDATIONS

Footing: 20"X10" Cont. W/ (2) #3 Bars Cont. on wire chairs or (1) #3 Transverse @ 2'-0"
Stemwall: 8" C.M.U. W/ 4-5 Vertical Dowel @ 48" O.C.

STRUCTURAL DESIGN CRITERIA:

- THE DESIGN COMPLIES WITH THE REQUIREMENTS OF THE 2020 FLORIDA BUILDING CODE (7TH EDITION) AND OTHER REFERENCED CODES AND SPECIFICATIONS. ALL CODES AND SPECIFICATIONS SHALL BE LATEST EDITION AT THE TIME OF PERMIT.
- WIND LOAD CRITERIA: RISK CATEGORY: 2, EXPOSURE: "C", BASED ON ANNUAL WIND SPEED 140 MPH (100-YEAR WIND VELOCITY, V_{100} = 104 MPH)
- ROOF DESIGN LOADS:
SUPERIMPOSED DEAD LOADS: 20 PSF
SUPERIMPOSED LIVE LOADS: 20 PSF
- FLOOR DESIGN LOADS:
SUPERIMPOSED DEAD LOADS: 25 PSF
SUPERIMPOSED LIVE LOADS: 40 PSF
RESIDENTIAL BALCONIES: 60 PSF
- WIND NET UPLIFT: AREAS INDICATED ON PLANS

TERMITE PROTECTION NOTES:

SOIL CHEMICAL BARRIER METHOD:

- A PERMANENT SIGN WHICH IDENTIFIES THE TERMITE TREATMENT PROVIDER AND NEED FOR INSPECTION AND TREATMENT CONTRACT RENEWAL SHALL BE PROVIDED. THE SIGN SHALL BE POSTED NEAR THE WATER HEATER OR ELECTRIC PANEL. FBC 1903.4.2
- CONDENSATE AND ROOF DOWNSPOUTS SHALL DISCHARGE AT LEAST 1'-0" AWAY FROM BUILDING SIDE WALLS. FBC 1903.4.4
- IRRIGATION/SPRINKLER SYSTEMS INCLUDING ALL RISERS AND SPRAY HEADS SHALL NOT BE INSTALLED WITHIN 1'-0" FROM BUILDING SIDE WALLS. FBC 1903.4.4
- TO PROVIDE FOR INSPECTION FOR TERMITE INFESTATION, BETWEEN WALL COVERINGS AND FINAL EARTH GRADE SHALL NOT BE LESS THAN 6". EXCEPTION: PAINT AND DECORATIVE CEMENTIOUS FINISH LESS THAN 6" THICK ADHERED DIRECTLY TO THE FOUNDATION WALL. FBC 1903.1.6
- INITIAL TREATMENT SHALL BE DONE AFTER ALL EXCAVATION AND BACKFILL IS COMPLETE. FBC 1916.1.1
- SOIL DISTURBED AFTER THE INITIAL TREATMENT SHALL BE RETREATED INCLUDING SPACES BOXED OR FORMED. FBC 1916.1.2
- BOXED AREAS IN CONCRETE FLOOR FOR SUBSEQUENT INSTALLATION OF TRAPS, ETC., SHALL BE MADE WITH PERMANENT METAL OR PLASTIC FORMS. PERMANENT FORMS MUST BE OF A SIZE AND DEPTH THAT WILL ELIMINATE THE DISTURBANCE OF SOIL AFTER THE INITIAL TREATMENT. FBC 1916.1.3
- MINIMUM 6 MIL VAPOR RETARDER MUST BE INSTALLED TO PROTECT AGAINST RAINFALL DILUTION IF RAINFALL OCCURS BEFORE VAPOR RETARDER PLACEMENT. RETREATMENT IS REQUIRED. FBC 1916.1.4
- CONCRETE OVERPOUR AND MORTAR ALONG THE FOUNDATION PERIMETER MUST BE REMOVED BEFORE EXTERIOR SOIL TREATMENT. FBC 1916.1.5
- SOIL TREATMENT MUST BE APPLIED UNDER ALL EXTERIOR CONCRETE OR GRADE WITHIN 1'-0" OF THE STRUCTURE SIDEWALLS. FBC 1916.1.6
- AN EXTERIOR VERTICAL CHEMICAL BARRIER MUST BE INSTALLED AFTER ANY SOIL DISTURBED INCLUDING LANDSCAPING AND IRRIGATION. ANY SOIL DISTURBED AFTER THE VERTICAL BARRIER IS APPLIED, SHALL BE RETREATED. FBC 1916.1.8
- ALL BUILDINGS ARE REQUIRED TO HAVE PER-CONSTRUCTION TREATMENT. FBC 1916.1.3
- A CERTIFICATE OF COMPLIANCE MUST BE ISSUED TO THE BUILDING DEPARTMENT BY A LICENSED PEST CONTROL COMPANY BEFORE A CERTIFICATE OF OCCUPANCY WILL BE ISSUED. THE CERTIFICATE OF COMPLIANCE SHALL STATE: "THE BUILDING HAS RECEIVED A COMPLETE TREATMENT FOR THE PREVENTION OF TERMITES. THE TREATMENT IS IN ACCORDANCE WITH THE RULES AND LAWS OF THE FLORIDA DEPARTMENT OF AGRICULTURE AND CONSUMER SERVICES". FBC 1916.1.7
- AFTER ALL WORK IS COMPLETED, LOOSE WOOD AND FILL MUST BE REMOVED FROM BELOW AND WITHIN 1'-0" OF THE BUILDING. THIS INCLUDES ALL GRADE STAKES, TUB TRAP BOXES, FORMS, SHORNS OR OTHER CELLULOSE CONTAINING MATERIAL. FBC 2303.1.3
- NO WOOD, VEGETATION, STUMPS, CARDBOARD, TRASH, ETC., SHALL BE BURIED WITHIN 15'-0" OF ANY BUILDING OR PROPOSED BUILDING. FBC 2303.1.4

FRAMING ANCHOR SCHEDULE

APPLICATION	MANUFACTURER/MODEL	CAP.
TRUSS TO WALL:	SIMPSON H2.5A (OR EQUIVALENT), W/ 6 - 10d NAILS	950#
ORDER TRUSS TO POST/HEADER:	SIMPSON LOT, W/ 28 - 16d NAILS	1785#
HEADER TO KING STUD(S):	SIMPSON DT22	1370#
PLATE TO STUD:	SIMPSON SP2	1065#
STUD TO BELL:	SIMPSON SP1	955#
PORCH BEAM TO POST:	SIMPSON PC44/EPC44	1700#
PORCH POST TO FND:	SIMPSON ABU44	2200#
MISC. JOINTS	SIMPSON A34	3196/240#

NOTE: ALL ANCHORS SHALL BE SECURED W/ NAILS AS PRESCRIBED BY THE MANUFACTURER FOR MAXIMUM JOINT STRENGTH, UNLESS NOTED OTHERWISE.
NOTE: REFER TO THE INCLUDED STRUCTURAL DETAILS FOR ADDITIONAL ANCHORS/ JOINT REINFORCEMENT AND FASTENERS.

NOTE: ALL UNLISTED JOINTS IN THE LOAD PATH SHALL BE REINFORCED WITH SIMPSON A34 FRAMING ANCHORS, TYPICAL T.O.

NOTE:

"SEMCO" PRODUCT APPROVAL:
MIAMI/DADE COUNTY REPORT #95-08115

NOTE:

"SIMPSON" PRODUCT APPROVALS:
MIAMI/DADE COUNTY REPORT #97-0107.05, #96-1126.11, #99-0623.04
SBCC1 NER-443, NER-393

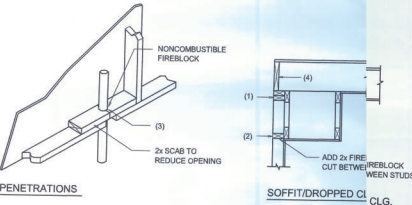

PENETRATIONS

FIREBLOCKING NOTES:

- FIREBLOCKING SHALL BE INSTALLED IN WOOD FRAME CONSTRUCTION IN THE FOLLOWING LOCATIONS:
- IN CONCEALED SPACES OF STUD WALLS AND PARTITIONS INCLUDING FURRED SPACES AT CEILING AND FLOOR LEVELS.
 - AT ALL INTERCONNECTIONS BETWEEN CONCEALED VERTICAL AND HORIZONTAL SPACES SUCH AS OCCUR AT SOFFITS, DROP CEILINGS, COVE CEILINGS, ETC.
 - AT OPENINGS AROUND VENTS, PIPES, DUCTS, CHIMNEYS AND FIREPLACES AT CEILING AND FLOOR LEVELS WITH "PROPIALAN MULTIPLEX SEALANT"
 - AT ALL INTERCONNECTIONS BETWEEN CONCEALED VERTICAL STUD WALL OR PARTITION SPACES AND CONCEALED SPACES CREATED BY AN ASSEMBLY OF FLOOR JOISTS. FIREBLOCKING SHALL BE PROVIDED FOR THE FULL DEPTH OF THE JOISTS AT THE ENDS AND OVER THE SUPPORTS.

Fire Stopping DETAILS

SCALE: NONE

A

BUILDING COMPONENTS & CLADDING LOADS MEAN BUILDING HEIGHT = 30.0', EXPOSURE "B" ROOF ANGLE 31° TO 45°					
ZONING DISTRICT	WIND SPEED (MPH)	WIND SPEED (MPH)			
		100 MPH	120 MPH	140 MPH	160 MPH
100	10	19.8 / -26.8	23.7 / -29.8	27.6 / -34.4	32.3 / -39.8
	20	19.4 / -25.7	23.0 / -29.4	27.0 / -33.9	31.4 / -38.9
	30	19.6 / -25.2	23.2 / -29.8	26.0 / -32.6	30.7 / -38.1
	40	19.8 / -25.8	23.7 / -30.3	27.6 / -35.4	32.3 / -40.3
	50	19.4 / -24.3	23.0 / -29.0	27.0 / -34.0	31.4 / -38.4
200	10	19.6 / -25.8	23.7 / -30.3	27.6 / -35.4	32.3 / -40.3
	20	19.4 / -24.3	23.0 / -29.0	27.0 / -34.0	31.4 / -38.4
	30	19.6 / -25.8	23.7 / -30.3	27.6 / -35.4	32.3 / -40.3
	40	19.8 / -26.4	24.7 / -31.4	28.0 / -35.0	33.7 / -41.0
	50	19.8 / -26.4	24.7 / -31.4	28.0 / -35.0	33.7 / -41.0

HEIGHT & EXPOSURE ADJUSTMENT COEFFICIENTS FOR BUILDING COMPONENTS & CLADDING			
BLDG. HEIGHT (FT)	EXPOSURE "B"	EXPOSURE "C"	EXPOSURE "D"
10	1.00	1.00	1.00
20	1.00	1.00	1.00
30	1.00	1.00	1.00

General Roofing NOTES:

DECK REQUIREMENTS:
ASPHALT SHINGLES SHALL BE FASTENED TO SOLIDLY SHEATHED DECKS.
SLOPE:
ASPHALT SHINGLES SHALL BE USED ONLY ON ROOF SLOPES OF 2:12 OR GREATER. FOR ROOF SLOPES FROM 2:12 TO 4:12, DBL. UNDERLAYMENT IS REQUIRED.

UNDERLAYMENT:
UNLESS OTHERWISE NOTED, UNDERLAYMENT SHALL CONFORM W/ ASTM D 226, TYPE 1, OR ASTM D 4966, TYPE 1.
SELF-ADHERING POLYMER MODIFIED BITUMEN SHEET:
SELF-ADHERING POLYMER MODIFIED BITUMEN SHALL COMPLY W/ ASTM D 1975.
ASPHALT SHINGLES:
ASPHALT SHINGLES SHALL HAVE SELF SEAL STRIPS OR BE INTERLOCKING, AND COMPLY WITH ASTM D 225 OR ASTM D 3462.

FASTENERS:
FASTENERS FOR ASPHALT SHINGLES SHALL BE GALVANIZED, STAINLESS STEEL, ALUMINUM OR COPPER ROOFING NAILS MINIMUM 12 GAUGE SHANK WITH A MINIMUM 3/8 INCH DIAMETER HEAD, OF A LENGTH TO PENETRATE THROUGH THE ROOFING MATERIAL AND A MINIMUM 3/4" INTO THE ROOF SHEATHING, WHERE THE SHEATHING IS LESS THAN 3/4" THICK. THE NAILS SHALL PENETRATE THROUGH THE SHEATHING.

ATTACHMENT:
ASPHALT SHINGLES SHALL BE SECURED TO THE ROOF WITH NOT LESS THAN FOUR FASTENERS PER STRIP SHINGLE OR TWO FASTENERS PER INDIVIDUAL SHINGLE, WHERE ROOFS LOCATED IN BASIC WIND SPEED OF 110 MPH OR GREATER, SPECIAL METHODS OF FASTENING ARE REQUIRED. UNLESS OTHERWISE NOTED, ATTACHMENT OF ASPHALT SHINGLES SHALL CONFORM WITH ASTM D 225 OR M-DC PA 107-86.

UNDERLAYMENT APPLICATION:
FOR ROOF SLOPES FROM 2:12 TO 4:12, UNDERLAYMENT SHALL BE A MINIMUM OF TWO LAYERS APPLIED AS FOLLOWS:
1. STARTING AT THE EAVE, A 19 INCH STRIP OF UNDERLAYMENT SHALL BE APPLIED PARALLEL WITH THE EAVE AND FASTENED SUFFICIENTLY TO STAY IN PLACE.

2. STARTING AT THE EAVE, 36 INCH WIDE STRIPS OF UNDERLAYMENT FELT SHALL BE APPLIED OVERLAPPING SUCCESSIVE SHEETS 19 INCHES AND FASTENED SUFFICIENTLY TO STAY IN PLACE.

FOR ROOF SLOPES 4:12 AND GREATER, UNDERLAYMENT SHALL BE A MINIMUM OF ONE LAYER OF UNDERLAYMENT FELT APPLIED AS FOLLOWS:
STARTING AT THE EAVE, UNDERLAYMENT SHALL BE APPLIED SHINGLE FASHION PARALLEL TO THE EAVE, LAPPED 2 INCHES, AND FASTENED SUFFICIENTLY TO STAY IN PLACE.

BASE AND CAP FLASHINGS:
BASE AND CAP FLASHING SHALL BE INSTALLED IN ACCORDANCE W/ MPOR'S INSTALLATION INSTRUCTIONS. BASE FLASHING SHALL BE OF EITHER CORROSION RESISTANT METAL OF MINIMUM NOMINAL THICKNESS 0.019 INCH OR MINERAL SURFACE ROLL ROOFING WEIGHING A MINIMUM OF 7.7 LBS PER 100 SQUARE FEET. CAP FLASHING SHALL BE CORROSION RESISTANT METAL OF MINIMUM NOMINAL THICKNESS OF 0.019 INCH.
VALLEYS:
VALLEY LININGS SHALL BE INSTALLED IN ACCORDANCE W/ MANUFACTURERS' INSTRUCTIONS OF THE FOLLOWING TYPES SHALL BE PERMITTED:
1. FOR OPEN VALLEYS LINED WITH METAL, THE VALLEY LINING SHALL BE AT LEAST 18" WIDE AND OF ANY OF THE CORROSION RESISTANT METALS IN FBC TABLE 1907.3.5.2
2. FOR OPEN VALLEYS, VALLEY LINING OF TWO PLYS OF MINERAL SURFACE ROLL ROOFING SHALL BE PERMITTED. THE BOTTOM LAYER SHALL BE 18 INCHES AND THE TOP LAYER A MINIMUM OF 36 INCHES WIDE.
3. FOR CLOSED VALLEYS VALLEY LINING SHALL BE ONE OF THE FOLLOWING:
1. BOTH TYPES 1 AND 2 ABOVE, COMBINED.
2. ONE PLY OF SMOOTH ROLL ROOFING AT LEAST 36 INCHES WIDE AND COMPLYING WITH ASTM D 224.
3. SPECIALLY UNDERLAYMENT AT LEAST 36 INCHES WIDE AND COMPLYING WITH ASTM D 1970.

NOTE 1 | 1 |
ROOF SHINGLES SHALL BE AS MANUFACTURED BY "TAMKO ROOFING PRODUCTS" OF THE FOLLOWING MODELS:
GLASS-SEAL AR
ELITE GLASS-SEAL AR
HERITAGE 30 AR
HERITAGE 40 AR
HERITAGE 50 AR
THESE SHINGLES MEET THE REQUIREMENTS OF ASTM D-3161 TYPE 1 MODIFIED TO 110 MPH WINDS & FBC TAS 100, USING 4 NAILS/SHINGLE

REVISIONS
August 23, 2022

SOFTWARE

DETAILS SHEET
SCALE
1/8" = 1'-0"

MODEL 1676 FOR
LOT 46, CROSSWINDS
PROJECT ADDRESS: COLUMBIA COUNTY, FLORIDA
RHETT CEMETERY
LAKE CITY, FLORIDA

2-461676
ARCCO/COB

NICHOLAS
BEI PAUL
4242 N. W. 17th Ave. Brown's Bldg.
ALACHUA, FL 32010
(904) 395-4355

JOB NUMBER
20220822

SHEET NUMBER
S.3
OF 4 SHEETS

NOTE: ALL DRAWINGS NOT TO BE SCALED, WRITTEN DIMENSIONS TAKE PRECEDENCE OVER SCALED DIMENSIONS

