



**NEMO | etc.**

Certificate of Authorization #32455  
353 Christian Street, Unit #13  
Oxford, CT 06478  
(203) 262-9245

ENGINEER

TEST

CONSULT

P.E. EVALUATION REPORT (PEER)

**TAMKO Building Products, LLC**

PO Box 97  
Galena, KS 66739  
(417) 624-6644

PEER-TAM-003.B.R3

FL12328-R12 (HVHZ)

Date of Issuance: 09/29/2020

Revision 3: 02/12/2024

**SCOPE:**

This P.E. Evaluation Report (henceforth 'PEER') is issued under Rule 61G20-3 and the applicable rules and regulations governing the use of construction materials in the State of Florida. The documentation submitted has been reviewed by Robert Nieminen, P.E. for use of the product under the Florida Building Code. The products described herein have been evaluated for compliance with the 8<sup>th</sup> Edition (2023) Florida Building Code, High Velocity Hurricane Zone sections noted herein.

**DESCRIPTION: TAMKO Roof Underlayments (HVHZ)**

**LABELING:** Labeling shall be in accordance with the requirements of the Accredited Quality Assurance Agency noted herein.

**CONTINUED COMPLIANCE:** This PEER is valid until such time as the named product(s) changes, the referenced Quality Assurance or production facility location(s) changes, or Code provisions that relate to the product(s) change. Acceptance of our PEERs by the named client constitutes agreement to notify NEMO ETC, LLC of any changes to the product(s), the Quality Assurance or the production facility location(s). NEMO ETC, LLC requires a complete review of its PEER relative to updated Code requirements with each Code Cycle.

**ADVERTISEMENT:** The Florida Product Approval Number (FL#) preceded by the words "NEMO P.E. Evaluated" may be displayed in advertising literature. If any portion of the PEER is displayed, then it shall be done in its entirety.

**INSPECTION:** Upon request, a copy of this entire PEER shall be provided to the user by the manufacturer or its distributors and shall be available for inspection at the job site at the request of the Building Official.

This PEER consists of pages 1 through 6.

Prepared by:

Digitally signed by  
Robert Nieminen  
Date: 2024.02.12  
'16:45:37 -05'00

This item has been digitally signed and sealed by Robert Nieminen, P.E.

Printed copies of this document are not considered signed and sealed, and the signature must be verified on any electronic copies.

Robert Nieminen, Florida P.E. 59166, FBC ANE1983  
NEMO ETC, LLC, Florida CA #32455

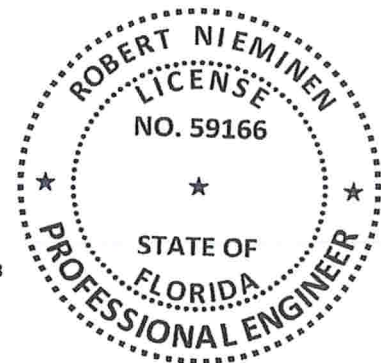

**CERTIFICATION OF INDEPENDENCE:**

1. NEMO ETC, LLC does not have, nor does it intend to acquire or will it acquire, a financial interest in any company manufacturing or distributing products it evaluates.
2. NEMO ETC, LLC is not owned, operated or controlled by any company manufacturing or distributing products it evaluates.
3. Robert Nieminen, P.E. does not have nor will acquire, a financial interest in any company manufacturing or distributing products for which the PEERs are being issued.
4. Robert Nieminen, P.E. does not have, nor will acquire, a financial interest in any other entity involved in the approval process of the product.
5. This is a building code evaluation. Neither NEMO ETC, LLC nor Robert Nieminen, P.E. are, in any way, the Designer of Record for any project on which this PEER, or previous versions thereof, is/was used for permitting or design guidance unless retained specifically for that purpose.

©2019, NEMO ETC, LLC

**ROOFING COMPONENT EVALUATION****1. SCOPE:****Product Category:** Roofing**Sub-Category:** Underlayment**Product Approval Method:** Method 1, Option D – Codified Material, Evaluation by Engineer**Compliance Statement:** TAMKO Roof Underlayments, as produced by TAMKO Building Products LLC, have demonstrated compliance with the following sections of the 8<sup>th</sup> Edition (2023) Florida Building Code, High Velocity Hurricane Zone through testing in accordance with the following Standards. Compliance is subject to the Installation Requirements and Limitations of Use set forth herein.**2. STANDARDS:**

| SECTION   | PROPERTY          | STANDARD   |
|---|-------------------|------------|
| 1518.2, 1518.2.1, TAS 110, RAS 118, RAS 119, RAS 120, RAS 130 | Material standard | ASTM D226  |
| 1518.2, 1518.2.1, TAS 110, RAS 130                            | Material standard | ASTM D1970 |
| TAS 110, RAS 118, RAS 119, RAS 120                            | Material standard | ASTM D6380 |
| TAS 103, Section 7  | Wind uplift       | UL1897     |

**3. REFERENCES:**

| ENTITY           | EXAMINATION        | REFERENCE            | DATE       |
|------------------|--------------------|----------------------|------------|
| MTI (TST2508)    | ASTM D1970         | DX24H7B              | 10/03/2017 |
| PRI (TST5878)    | ASTM D1970         | TAP-388-02-01        | 10/04/2017 |
| PRI (TST5878)    | ASTM D226, Type II | TAP-420-02-01        | 04/19/2018 |
| PRI (TST5878)    | ASTM D6380         | 847T0009             | 12/21/2019 |
| PRI (TST5878)    | ASTM D6380         | 847T00010            | 12/21/2019 |
| PRI (TST5878)    | ASTM D226, Type II | TAP-351-02-01        | 04/25/2016 |
| NEMO (TST6049)   | ASTM D1970         | 4j-TAM-22-SSUDL-01.A | 11/14/2022 |
| NEMO (TST6049)   | UL1897             | 4a-TAM-23-LSWUS-01.A | 12/25/2023 |
| UL LLC (QUA9625) | Quality Assurance  | Service Confirmation | 06/01/2023 |
| UL LLC (QUA9625) | Quality Assurance  | Florida BCIS         | Current    |

**4. PRODUCT DESCRIPTION:**

| TABLE 1: EVALUATED UNDERLAYMENTS |                         |                                      |  |
|----------------------------------|-------------------------|--------------------------------------|--|
| PRODUCT                          | MATERIAL STANDARD       | PLANT(S)                             | DESCRIPTION  |
| No. 30 UL                        | ASTM D226, Type II      | Joplin, MO<br>Green Cove Springs, FL | Asphalt-saturated organic felt   |
| Moisture Guard®                  | ASTM D1970              | Joplin, MO                           | Self-adhering, fiberglass reinforced SBS modified bitumen roof underlayment with a mineral top surface.      |
| TW Underlayment                  | ASTM D1970 <sup>1</sup> | Columbus, KS                         | Self-adhering, SBS modified bitumen roof underlayment with a polymer-film top surface.                       |
| TW Metal and Tile Underlayment   | ASTM D1970 <sup>1</sup> | Joplin, MO                           | Self-adhering, fiberglass reinforced SBS modified bitumen roof underlayment with a polymer-film top surface. |
| TW Seam Tape                     | ASTM D1970              | Columbus, KS                         | Self-adhering, SBS modified bitumen roof underlayment with a polymer-film top surface.                       |

<sup>1</sup> Agreement between purchaser and seller, as set forth in Section 4.3, Note 1 of ASTM D1970-17, should be established as to slip resistance of TW Underlayment and TW Metal and Tile Underlayment.



**TABLE 1: EVALUATED UNDERLAYMENTS**

| PRODUCT                          | MATERIAL STANDARD            | PLANT(S)               | DESCRIPTION   |
|----------------------------------|------------------------------|------------------------|---|
| ASTM Slate Surfaced Roll Roofing | ASTM D6380, Class M, Type II | Green Cove Springs, FL | Asphalt-saturated organic mat, coated on both sides with asphalt and surfaced with granules.  |
| ASTM Tile Underlayment           | ASTM D6380, Class M, Type II | Green Cove Springs, FL | Asphalt-saturated organic felt, coated on both sides with asphalt and surfaced with granules. |

**5. LIMITATIONS:**

- 5.1 This is a building code evaluation. Neither NEMO ETC, LLC nor Robert Nieminen, P.E. are, in any way, the Designer of Record for any project on which this PEER, or previous versions thereof, is/was used for permitting or design guidance. PEERs are not to be construed as representing any attributes not specifically listed, nor are PEERs to be construed as an endorsement of the subject, or a recommendation for its use. There is no warranty by NEMO ETC, LLC or Robert Nieminen, P.E., express or implied, as to any finding or other matter in this PEER, or as to any product covered by the PEER.
- 5.2 This PEER is exclusively for use in FBC High Velocity Hurricane Zone jurisdictions, as defined in FBC Chapter 2 (Broward and Miami-Dade Counties).
- 5.3 This PEER pertains to above-deck roof components. Roof decks and structural members shall be in accordance with FBC requirements to the satisfaction of the Authority Having Jurisdiction.
- 5.4 This PEER does not include evaluation of fire classification. Refer to **FBC HVHZ 1516** for requirements and limitations regarding roof assembly fire classification. Refer to **FBC 2603** for requirements and limitations concerning the use of foam plastic insulation.
- 5.5 **TAMKO Roof Underlayments** may be used with any prepared roof cover where the product is specifically referenced within FBC approval documents. If not listed, a request may be made to the Authority Having Jurisdiction for approval based on this PEER combined with supporting data for the prepared roof covering.
- 5.6 **Allowable Roof Covers:**

**TABLE 2: ROOF COVER OPTIONS**

| <u>FBC HVHZ:</u>                 | <b>RAS 115<br/>1518.2.1</b> | <b>RAS 118, 119 &amp; 120</b>            |  | <b>RAS 133<br/>1518.2.1</b> | <b>1518.2.1</b>                  | <b>RAS 130<br/>1518.10</b> |
|----------------------------------|-----------------------------|--|--|-----------------------------|----------------------------------|----------------------------|
| UNDERLAYMENT                     | ASPHALT<br>SHINGLES         | CLAY AND CONCRETE TILE                   |  | METAL                       | SLATE OR SLATE-<br>TYPE SHINGLES | WOOD                       |
|                                  |                             | MECHANICAL<br>ATTACH                     | ADHESIVE-SET                             |                             |                                  |                            |
| No. 30 UL                        | Yes                         | Yes<br>(as Base Sheet,<br>See Section 6) | Yes<br>(as Base Sheet,<br>See Section 6) | Yes                         | Yes                              | Yes                        |
| Moisture Guard®                  | Yes                         | No                                       | No                                       | No                          | Yes                              | Yes<br>(Valley Liner)      |
| TW Underlayment                  | Yes                         | No                                       | No                                       | Yes                         | Yes                              | Yes<br>(Valley Liner)      |
| TW Metal and Tile Underlayment   | Yes                         | No                                       | No                                       | Yes                         | Yes                              | Yes<br>(Valley Liner)      |
| TW Seam Tape                     | Yes <sup>2</sup>            | Yes <sup>2</sup>                         | Yes <sup>2</sup>                         | Yes <sup>2</sup>            | Yes <sup>2</sup>                 | Yes <sup>2</sup>           |
| ASTM Slate Surfaced Roll Roofing | Yes<br>(Valley Liner)       | Yes<br>(Cap Sheet in 2-<br>ply system)   | No                                       | No                          | No                               | No                         |
| ASTM Tile Underlayment           | Yes<br>(Valley Liner)       | Yes<br>(Cap Sheet in 2-<br>ply system)   | No                                       | No                          | No                               | No                         |

<sup>2</sup> Used as min. 3 ¾-inch wide joint-strips per FBC HVHZ 1518.2.1(2).



NEMO | etc.®

5.7 Allowable Substrates:

| TABLE 3: SUBSTRATE OPTIONS FOR ADHERED UNDERLAYMENTS               |               |  |   |
|--|---------------|--|---|
| UNDERLAYMENT   | APPLICATION   | SUBSTRATES (DESIGNED TO MEET WIND LOADS FOR PROJECT) |   |
|  |               | PRIMER   | SUBSTRATES  |
| Moisture Guard®, TW Underlayment or TW Metal and Tile Underlayment | self-adhering | (Optional) ASTM D41                                  | plywood   |
|  |               | None   | No. 30 UL   |
| TW Seam Tape   | self-adhering | (Optional) ASTM D41                                  | plywood (for use as Secondary Water Barrier only) |
| ASTM Slate Surfaced Roll Roofing or ASTM Tile Underlayment         | hot asphalt   | None   | No. 30 UL   |

5.8 Attachment Limitations:

5.8.1 Refer to Section 6 for codified prescriptive systems.

5.8.2 Refer to Table 4 for underlayment systems which have documented compliance with Section 7 of TAS 103. The Maximum Design Pressure is the result of testing for wind load resistance based on allowable wind loads, and reflects the ultimate passing pressure divided by 2 (the 2 to 1 margin of safety has already been applied). No extrapolation or rational analysis is permitted for assemblies marked with an asterisk\*.

| TABLE 4: ALLOWABLE DESIGN PRESSURES,<br>2-PLY UNDERLAYMENT SYSTEMS IN TILE ROOF APPLICATIONS |  |                                       |            |   |   |           |
|--|--|---------------------------------------|------------|---|---|-----------|
| SYSTEM No.   | DECK   | JOINT TREATMENT                       | BASE SHEET |   | CAP PLY   | MDP (PSF) |
|  |  |                                       | TYPE       | ATTACH  |   |           |
| UDL-1.   | Plywood, APA rated sheathing, 32/16, Exposure 1, PS1, 15/32 category | (Optional) TW Seam Tape, self-adhered | No. 30 UL  | 12 ga. x 1.5-inch annular ring shank nails with 32 ga., 1-5/8-inch diameter tin caps, 6-inch o.c. at the 4-inch laps and 12-inch o.c. at two (2) equally spaced center rows | ASTM Slate Surfaced Roll Roofing or ASTM Tile Underlayment, applied in ASTM D312, Type IV hot asphalt and back-nailed using 12 ga. ring shank nails with 32 ga., 1-5/8-inch diameter tin caps, 12-inch o.c. | -45.0     |
| UDL-2.   | Plywood, APA rated sheathing, 32/16, Exposure 1, PS1, 15/32 category | (Optional) TW Seam Tape, self-adhered | No. 30 UL  | 12 ga. x 1.5-inch annular ring shank nails with 32 ga., 1-5/8-inch diameter tin caps, 6-inch o.c. at the 4-inch laps and 6-inch o.c. at two (2) equally spaced center rows  | ASTM Slate Surfaced Roll Roofing or ASTM Tile Underlayment, applied in ASTM D312, Type IV hot asphalt and back-nailed using 12 ga. ring shank nails with 32 ga., 1-5/8-inch diameter tin caps, 12-inch o.c. | -67.5     |

5.9 Exposure Limitations:

| TABLE 4: EXPOSURE LIMITATIONS   |                          |
|---|--------------------------|
| UNDERLAYMENT  | MAXIMUM EXPOSURE (DAYS)* |
| No. 30 UL, Moisture Guard®, TW Underlayment or TW Metal and Tile Underlayment, ASTM Slate Surfaced Roll Roofing or ASTM Tile Underlayment | 30                       |

\*Maximum exposure shall not exceed the manufacturer's recommendations, which may be less than 30 days.

5.10 Tile Slippage Limitations: When loading roof tiles on ASTM Slate Surfaced Roll Roofing or ASTM Tile Underlayment, the tile shall be staged atop battens or loading board during loading of the roof tiles.





6. INSTALLATION:

6.1 **TAMKO Roof Underlayments** shall be installed in accordance with **TAMKO Building Products LLC** installation instructions subject to the Limitations of Use set forth herein and the specifics noted below.

6.1.1 Consult TAMKO requirements for back-nailing of adhered underlayments at slopes 2:12 or greater.

6.2 Re-fasten any loose decking panels, and check for protruding nail heads. Sweep the substrate thoroughly to remove any dust and debris prior to application, and prime the substrate (if applicable).

6.3 Refer to Section 6.4 for underlayments having prescriptive codified minimum attachment or Table 4 for underlayment systems having maximum design pressures established in accordance with Section 7 of TAS 103.

6.4 Underlayment Assemblies with Prescriptive Minimum Attachment for use in NON-TILE applications:

6.4.1 **CODE REFERENCE:** **1518.2.1, Option 1**  
Underlayment adhered to deck

DECK DESCRIPTION: Min. 19/32-inch plywood

UNDERLAYMENT: **Moisture Guard®, TW Underlayment or TW Metal and Tile Underlayment**, self-adhered in accordance with FBC HVHZ 1518.2.1(1) and back-nailed max. 12-inch o.c. using FBC HVHZ Approved nails and tin caps (FBC HVHZ 1517.5).

SURFACING: FBC HVHZ Approved asphalt shingles, metal roof panels or metal shingles, slate or slate type shingles, subject to the allowable roof covers in Table 2 herein.

6.4.2 **CODE REFERENCE:** **1518.2.1, Option 2**  
Self-adhering strips to deck-joints followed by underlayment mechanically attached to deck

DECK DESCRIPTION: Min. 19/32" plywood or wood plank

SECONDARY WATER BARRIER: **TW Seam Tape** self-adhered over joints of the plywood roof deck prior to installation of subsequent layer(s) in accordance with FBC HVHZ 1518.2.1(2). Do not overlap end-joints or T-joints. All end-joints and T-joints shall be butted firmly side by side, flush with each other but not overlapped.

UNDERLAYMENT: **No. 30 UL** in accordance with FBC HVHZ Table 1518.2.1, with a minimum 4-inch side lap and 6-inch end lap, mechanically fastened to deck

FASTENING: FBC HVHZ Approved nails and tin caps (FBC HVHZ 1517.5), grid pattern of 12-inches between the overlaps and 6-inch spacing at the overlaps, in accordance with FBC HVHZ Table 1518.2.1.

SURFACING: FBC HVHZ Approved asphalt shingles, metal roof panels or metal shingles, slate or slate type shingles, subject to the allowable roof covers in Table 2 herein.

6.4.3 **CODE REFERENCE:** **1518.2.1, Option 3**  
Two-layer underlayment mechanically fastened to deck

DECK DESCRIPTION: Min. 19/32" plywood or wood plank

UNDERLAYMENT: Two (2) layers of **No. 30 UL** in accordance with FBC HVHZ 1518.2.1(3).

FASTENING: FBC HVHZ Approved nails and tin caps (FBC HVHZ 1517.5) in accordance with FBC HVHZ 1518.2.1(3).

SURFACING: FBC HVHZ Approved asphalt shingles, metal roof panels or metal shingles, slate or slate type shingles, subject to the allowable roof covers in Table 2 herein.



NEMO|etc.®

6.4.4

|                          |  |
|--------------------------|--|
| CODE REFERENCE:          | <b>1518.2.1, Option 1 combined with Option 2 or 3</b><br>Optional self-adhering strips to deck-joints followed by base sheet mechanically fastened to deck followed by underlayment adhered to base sheet  |
| DECK DESCRIPTION:        | Min. 19/32" plywood or wood plank  |
| SECONDARY WATER BARRIER: | (Optional) <b>TW Seam Tape</b> self-adhered over joints of the plywood roof deck prior to installation of subsequent layer(s) in accordance with FBC HVHZ 1518.2.1(2). Do not overlap end-joints or T-joints. All end-joints and T-joints shall be butted firmly side by side, flush with each other but not overlapped. |
| BASE SHEET:              | One (1) or two (2) layer(s) of <b>No. 30 UL</b> in accordance with FBC HVHZ Table 1518.2.1, with a minimum 4-inch side lap and 6-inch end lap, mechanically fastened to deck.  |
| FASTENING:               | FBC HVHZ Approved nails and tin caps ( <a href="#">FBC HVHZ 1517.5</a> ), grid pattern of 12-inches between the overlaps and 6-inch spacing at the overlaps, in accordance with FBC HVHZ Table 1518.2.1.   |
| UNDERLAYMENT:            | <b>Moisture Guard®, TW Underlayment or TW Metal and Tile Underlayment</b> self-adhering and back-nailed max. 12-inch o.c. using FBC HVHZ Approved nails and tin caps ( <a href="#">FBC HVHZ 1517.5</a> ).  |
| SURFACING:               | FBC HVHZ Approved asphalt shingles, metal roof panels or metal shingles, slate or slate type shingles, subject to the allowable roof covers in <a href="#">Table 2</a> herein.   |

7. **BUILDING PERMIT REQUIREMENTS:**  
As required by the Building Official or Authority Having Jurisdiction in order to properly evaluate the installation of this product.
8. **MANUFACTURING PLANTS:**  
Contact the named QA entity for manufacturing facilities covered by **F.A.C. Rule 61G20-3** QA requirements. Refer to [Section 4](#) herein for products and production locations having met codified material standards.
9. **QUALITY ASSURANCE ENTITY:**  
[UL LLC – QUA9625](#); (360) 817-5512; [bsai.inspections@ul.com](mailto:bsai.inspections@ul.com)

- END OF PEER -





DEPARTMENT OF REGULATORY AND ECONOMIC RESOURCES (RER)  
BOARD AND CODE ADMINISTRATION DIVISION

## NOTICE OF ACCEPTANCE (NOA)

MIAMI-DADE COUNTY  
PRODUCT CONTROL SECTION

11805 SW 26 Street, Room 208  
Miami, Florida 33175-2474  
T (786) 315-2590 F (786) 315-2599

[www.miamidade.gov/economy](http://www.miamidade.gov/economy)

Kaycan Ltd.  
1 Memorial Drive.  
Richford, VT 05476

**SCOPE:** This NOA is being issued under the applicable rules and regulations governing the use of construction materials. The documentation submitted has been reviewed and accepted by Miami-Dade County RER-Product Control Section to be used in Miami-Dade County and other areas where allowed by the Authority Having Jurisdiction (AHJ).

This NOA shall not be valid after the expiration date stated below. The Miami-Dade County Product Control Section (In Miami-Dade County) and/ or the AHJ (in areas other than Miami-Dade County) reserve the right to have this product or material tested for quality assurance purposes. If this product or material fails to perform in the accepted manner, the manufacturer will incur the expense of such testing and the AHJ may immediately revoke, modify, or suspend the use of such product or material within their jurisdiction. RER reserves the right to revoke this acceptance if it is determined by Miami-Dade County Product Control Section that this product or material fails to meet the requirements of the applicable building code.

This product is approved as described herein and has been designed to comply with the Florida Building Code, including the High Velocity Hurricane Zone.

**DESCRIPTION:** Model SP-600 16" Aluminum Vented Soffit

**APPROVAL DOCUMENT:** Drawing No. KAY0003, titled "SP-600 16" Aluminum Soffit - Vented", sheets 1 through 4 of 4, dated 12/27/2011, with revision 6 dated 08/31/2023, prepared by PTC, LLC, signed and sealed by Robert J. Amoroso, P.E., bearing the Miami-Dade County Product Control revision stamp with the Notice of Acceptance number and expiration date by the Miami-Dade County Product Control Section.

**MISSILE IMPACT RATING:** None

**LABELING:** Each piece shall bear a permanent label marked at not more than 4 ft. (1.2m) o.c. with the manufacturer's name or logo, Pointe-Claire, QC, Canada and following statement: "Miami-Dade County Product Control Approved", per FBC 1709.10.2 and 1709.10.3.

**RENEWAL** of this NOA shall be considered after a renewal application has been filed and there has been no change in the applicable building code negatively affecting the performance of this product.

**TERMINATION** of this NOA will occur after the expiration date or if there has been a revision or change in the materials, use, and/ or manufacture of the product or process. Misuse of this NOA as an endorsement of any product, for sales, advertising or any other purposes shall automatically terminate this NOA. Failure to comply with any section of this NOA shall be cause for termination and removal of NOA.

**ADVERTISEMENT:** The NOA number preceded by the words Miami-Dade County, Florida, and followed by the expiration date may be displayed in advertising literature. If any portion of the NOA is displayed, then it shall be done in its entirety.

**INSPECTION:** A copy of this entire NOA shall be provided to the user by the manufacturer or its distributors and shall be available for inspection at the job site at the request of the Building Official.

This NOA revises NOA # 21-1208.04 and consists of this page 1 and evidence pages E-1, E-2, E-3 and E-4, as well as approval document mentioned above.

The submitted documentation was reviewed by Carlos M. Utrera, P.E.



NOA No. 23-0908.07  
Expiration Date: June 1, 2026  
Approval Date: October 26, 2023  
Page 1

**NOTICE OF ACCEPTANCE: EVIDENCE SUBMITTED**

1. Evidence submitted under previous NOA's
- A. **DRAWINGS** *"Submitted under NOA # 15-0612.15"*
  1. Drawing No. KAY0003, titled "SP-600 16" Aluminum Soffit – Vented", sheets 1 through 4 of 4, dated 12/27/2011, with revision 2 dated 03/17/2015, prepared by the manufacturer, signed and sealed by Robert J. Amoruso, P.E.
- B. **TESTS** *"Submitted under NOA # 17-0404.03"*
  1. Test report on Wind Driven Rain Resistance Test per TAS 100(A) of Model SP-600 16" Aluminum Vented Soffit prepared by Fenestration Testing Laboratory, Inc., Test Report No. 9457, dated 03/28/2017, signed and sealed by Idalmis Ortega, P.E.  
*"Submitted under NOA # 05-0802.03"*
  2. Test report of Cyclic Load Pressure Test per TAS 203 and test report of Uniform Static Load Test per TAS 202 on Aluminum Soffit SP-600 prepared by Architectural Testing, Test Report No. 55982.02-122-18, dated 07/18/2005, signed and sealed by S. M. Urich, P.E.
  3. Test report of Tensile Test per ASTM E8 on Aluminum Vented Soffit, prepared by Architectural Testing, Test Report No. 55982.03-122-18, dated 04/26/2005, signed and sealed by Joseph A. Reed, P.E.
- C. **CALCULATIONS** *"Submitted under NOA # 12-0124.04"*
  1. Anchor calculations prepared by PTC Product Design Group, LLC, dated 12/27/2011, signed and sealed by Robert J. Amoruso, P.E.  
*"Submitted under NOA # 05-0802.03"*
  2. Anchor calculations prepared by H. R. Engineering, Inc., pages 1 through 3, dated 07/25/2005, signed and sealed by Allen N. Reeves, P.E.
- D. **QUALITY ASSURANCE**
  1. Miami-Dade Department of Regulatory and Economic Resources (RER).
- E. **MATERIAL CERTIFICATIONS**
  1. None.
- F. **STATEMENTS** *"Submitted under NOA # 15-0612.15"*
  1. Statement letter of code conformance to 5<sup>th</sup> edition (2014) FBC and of no financial interest, prepared by PTC Product Design Group, LLC, dated 03/17/2015, signed and sealed by Robert J. Amoruso, P.E.  
*"Submitted under NOA # 12-0124.04"*
  2. Statement letter of code conformance to 2010 FBC and no financial interest, prepared by PTC Product Design Group, LLC, dated 01/19/2012, signed and sealed by Robert J. Amoruso, P.E.  
*"Submitted under NOA # 11-0325.03"*
  3. Distributor agreement dated 04/25/2011.



Carlos M. Utrera, P.E.  
Product Control Examiner  
NOA No. 23-0908.07  
Expiration Date: June 1, 2026  
Approval Date: October 26, 2023



**NOTICE OF ACCEPTANCE: EVIDENCE SUBMITTED**

**2. Evidence submitted under NOA # 17-1221.31**

**A. DRAWINGS**

1. Drawing No. **KAY0003**, titled "SP-600 16" Aluminum Soffit – Vented", sheets 1 through 4 of 4, dated 12/27/2011, with revision 3 dated 12/01/2017, prepared by PTC, LLC, signed and sealed by Robert J. Amoruso, P.E.

**B. TESTS**

1. None.

**C. CALCULATIONS**

1. None.

**D. QUALITY ASSURANCE**

1. Miami-Dade Department of Regulatory and Economic Resources (RER)

**E. MATERIAL CERTIFICATIONS**

1. None.

**F. STATEMENTS**

1. Statement letter of code conformance to 6<sup>th</sup> edition (2017) FBC and of no financial interest, prepared by PTC Product Design Group, LLC, dated 12/01/2017, signed and sealed by Robert J. Amoruso, P.E.



---

**Carlos M. Utrera, P.E.**  
**Product Control Examiner**  
**NOA No. 23-0908.07**  
**Expiration Date: June 1, 2026**  
**Approval Date: October 26, 2023**

**NOTICE OF ACCEPTANCE: EVIDENCE SUBMITTED**

**3. Evidence submitted under NOA # 20-1013.08**

**A. DRAWINGS**

1. Drawing No. **KAY0003**, titled "SP-600 16" Aluminum Soffit – Vented", sheets 1 through 4 of 4, dated 12/27/2011, with revision 4 dated 09/30/2020, prepared by PTC, LLC, signed and sealed by Robert J. Amoruso, P.E.

**B. TESTS**

1. None.

**C. CALCULATIONS**

1. None.

**D. QUALITY ASSURANCE**

1. Miami-Dade Department of Regulatory and Economic Resources (RER)

**E. MATERIAL CERTIFICATIONS**

1. None.

**F. STATEMENTS**

1. Statement letter of code conformance to the 7<sup>th</sup> edition (2020) FBC and of no financial interest, prepared by PTC Product Design Group, LLC, dated 09/30/2020, signed and sealed by Robert J. Amoruso, P.E.
2. Testing contract letter issued by Molimo LLC, dated 01/19/2021, signed by Michael D. Stremmel, P.E.



Carlos M. Utrera, P.E.  
Product Control Examiner  
NOA No. 23-0908.07  
Expiration Date: June 1, 2026  
Approval Date: October 26, 2023



**NOTICE OF ACCEPTANCE: EVIDENCE SUBMITTED**

**4. Evidence submitted under NOA # 21-1208.04 and new**

**A. DRAWINGS**

1. Drawing No. **KAY0003**, titled "SP-600 16" Aluminum Soffit – Vented", sheets 1 through 4 of 4, dated 12/27/2011, with revision **6** dated 08/31/2023, prepared by PTC, LLC, signed and sealed by Robert J. Amoruso, P.E.

**B. TESTS**

1. Test reports on 1) Uniform Static Air Pressure Test, Loading per FBC TAS 202-94  
2) Cyclic Wind Pressure Loading per FBC, TAS 203-94  
along with marked-up drawings and installation diagram of Model SP-600 16" Aluminum Vented Soffit, by Molimo Architectural Product Testing, Report No. **2846.01-106-11**, dated 04/14/2021, signed and sealed by Michael D. Stremmel, P.E.

**C. CALCULATIONS**

1. None.

**D. QUALITY ASSURANCE**

1. Miami-Dade Department of Regulatory and Economic Resources (RER).

**E. MATERIAL CERTIFICATIONS**

1. None.

**F. STATEMENTS**

1. Statement letter of code conformance to the 8<sup>th</sup> edition (2023) of the FBC, issued by PTC Product Design Group, LLC, dated 08/31/2023, signed and sealed by Robert J. Amoruso, P.E.
2. Statement letter of no financial interest, issued by PTC Product Design Group, LLC, dated 08/31/2023, signed and sealed by Robert J. Amoruso, P.E.
3. Statement letter of code conformance to the 7<sup>th</sup> edition (2020) of the FBC and of no financial interest, issued by PTC Product Design Group, LLC, dated 11/15/2021, signed and sealed by Robert J. Amoruso, P.E.



**Carlos M. Utrera, P.E.**  
**Product Control Examiner**  
**NOA No. 23-0908.07**  
**Expiration Date: June 1, 2026**  
**Approval Date: October 26, 2023**

# KAYCAN LTD

## SP-600 16" ALUMINUM SOFFIT - VENTED

### INSTALLATION ANCHORAGE DETAILS

#### GENERAL NOTES:

- THIS PRODUCT HAS BEEN TESTED AND DESIGNED TO COMPLY WITH THE 8TH EDITION (2023) FLORIDA BUILDING CODE (FBC) - BUILDING AND RESIDENTIAL VOLUMES INCLUDING THOSE SECTIONS OF THE FBC PERTAINING TO THE HIGH VELOCITY HURRICANE ZONE (HVHZ) AT THE DESIGN PRESSURE(S) STATED HEREIN. THE PRODUCT WAS TESTED TO TAS-202 AND TAS-203. IMPACT TESTING TO TAS-201 IS NOT REQUIRED FOR SOFFIT. STRUCTURAL TEST RESULTS BASED ON TAS 202 WERE DIVIDED BY 1.5 AS REQUIRED BY THE 8TH EDITION (2023) FBC - BUILDING AND RESIDENTIAL VOLUMES.
- THE PRODUCT DETAILS CONTAINED HEREIN ARE BASED UPON SIGNED AND SEALED ARCHITECTURAL TESTING REPORT #55982.02-122-18 AND MOLIMO REPORT NO. 2946.01-106-11, INCLUDING ASSOCIATED LABORATORY STAMPED DRAWINGS.
- ADEQUACY OF THE EXISTING STRUCTURAL CONCRETE, MASONRY AND WOOD FRAMING COMPRISING THE ATTACHMENT SUBSTRATE FOR THE SOFFIT SHALL BE DETERMINED TO BE CAPABLE OF WITHSTANDING AND TRANSFERRING APPLIED PRODUCT LOADS TO THAT STRUCTURE AND IS THE RESPONSIBILITY OF THE ARCHITECT OR ENGINEER OF RECORD FOR THE PROJECT.
- OVERHANG RECEIVING ALUMINUM SOFFIT SHALL BE CHECKED FOR STRUCTURAL INADEQUACY, CRACKS OR DEFECTS THAT SHALL BE ELIMINATED.
- INSTALLATION OF SOFFIT ACCESSORIES AND ACCESSORIES SUCH AS CORNER POSTS, STARTER STRIPS AND TRIM AROUND OPENINGS SHALL BE DONE IN ACCORDANCE WITH THE 8TH EDITION (2023) FLORIDA BUILDING CODE - BUILDING AND RESIDENTIAL VOLUMES AND THE MANUFACTURER'S INSTRUCTIONS.
- SITE CONDITIONS THAT DEVIATE FROM THE DETAILS OF THIS DRAWING REQUIRE FURTHER ENGINEERING EVALUATION BY A LICENSED ENGINEER OR REGISTERED ARCHITECT.
- LABELED IN ACCORDANCE WITH THE 8TH EDITION (2023) FLORIDA BUILDING CODE - BUILDING AND RESIDENTIAL VOLUMES.
- SOFFIT NET FREE AREA IN ACCORDANCE WITH THE 8TH EDITION (2023) FLORIDA BUILDING CODE - BUILDING AND RESIDENTIAL VOLUMES.
- 7.7 SQ INCH/LINEAL FT.

#### INSTALLATION NOTES:

- ANCHORS SHALL BE THE TYPE, SIZE, EMBEDMENT AND EDGE DISTANCE SHOWN HEREIN FOR RESPECTIVE SUBSTRATE.
- INSTALLATION ANCHORS SHALL BE AS SHOWN ON THE "BATTEN INSTALLATION" AND "SOFFIT INSTALLATION" SECTIONS ON SHEETS 3 AND 4.
- MINIMUM EMBEDMENT AND EDGE DISTANCE EXCLUDE WALL FINISHES (INCLUDING BUT NOT LIMITED TO STUCCO, FOAM, BRICK VENEER AND SIDING).
- FOR INSTALLATION OF BATTEN TO WOOD STRUCTURE USE #8 x 3" WOOD SCREW OR #8 x 3" TAPPING SCREW. PLACE ONE SCREW PER LOCATION AND MAXIMUM 24" O.C. ALONG BATTEN LENGTH.
- FOR INSTALLATION OF SOFFIT TO BATTEN USE 0.12" DIAMETER x 1-1/2" LONG SMOOTH, SCREW OR RING SHANK ROOFING NAIL WITH 3/8" DIAMETER HEAD.
- ALL FASTENERS SHALL HAVE CORROSION RESISTANT COATINGS OR BE MADE OF CORROSION RESISTANT MATERIALS COMPATIBLE WITH THE SUBSTRATE MATERIALS.

#### ALUMINUM SOFFIT SPECIFICATIONS:

- KAYCAN BUILDING PRODUCTS ALUMINUM SOFFIT IS MANUFACTURED BY ALUMINUM PRODUCTS, 3075 TRANS-CANADA HWY, POINTE-CLAIRE, QC H8R 1B4, CANADA.
- SP-600 16" SOFFIT - VENTED
  - MATERIAL: ALUMINUM 3004-H19
  - WALL THICKNESS: 0.015"
  - PANEL LENGTHS: 12' - 0" LONG
- TRIM
  - F-CHANNEL
  - MATERIAL: ALUMINUM
  - WALL THICKNESS: 0.022"
  - FASCIA
  - MATERIAL: ALUMINUM
  - WALL THICKNESS: 0.022"

#### BILL OF MATERIALS

| ITEM | DESCRIPTION  | MATERIAL       |
|------|--|----------------|
| 1    | SP-600 16" VENTED SOFFIT   | ALUM. 3004-H19 |
| 2    | F-CHANNEL  | ALUMINUM       |
| 3    | 6" FASCIA  | ALUMINUM       |
| 4    | 0.125" DIAMETER x 1-1/2" LONG ROOFING NAIL WITH 7/16" DIA. HEAD. USED TO ATTACH SOFFIT TO BATTEN | STEEL          |
| 5    | #8 x 3" WOOD SCREW OR #8 x 3" TAPPING SCREW. USED TO ATTACH BATTEN TO WOOD STRUCTURE             | STEEL          |
| 6    | 2" x 2" WOOD BATTEN  | WOOD           |

#### TABLE OF CONTENT

| SHEET | DESCRIPTION   |
|-------|---|
| 1     | GENERAL AND INSTALLATION NOTES, B.O.M. AND D.P. CHART |
| 2     | APPROVED SOFFIT PROFILE AND COMPONENTS                |
| 3     | SOFFIT INSTALLATION AND CROSS SECTION                 |
| 4     | SOFFIT INSTALLATION SECTION                           |

#### DESIGN PRESSURE (PSF) RATING

| SOFFIT MODEL                               | DESIGN PRESSURE (PSF) |
|--|-----------------------|
| SP-600 16" ALUM. VENTED SOFFIT W/F-CHANNEL | +55.0PSF / -35.0psf   |

|                   |   |
|-------------------|---|
| PROJECT #423-0909 |   |
| REV               | DESCRIPTION                                 |
| 6                 | UPDATE TO THE 8TH (2023) EDITION OF THE FBC |
| DATE              | 8/3/23                                      |
| BY                | RA  |

|                                      |          |
|--------------------------------------|----------|
| KAYCAN LTD                           |          |
| 1 MEMORIAL DRIVE                     |          |
| RICHFORD, VT 05476                   |          |
| SP-600 16" ALUMINUM SOFFIT - VENTED  |          |
| GENERAL NOTES, B.O.M. AND D.P. CHART |          |
| DATE                                 | 12/27/11 |
| DRAWN BY                             | TJH      |
| SCALE                                | N.T.S.   |
| SHEET                                | 6        |
| 1 OF 4                               |          |

**PRODUCT REVISED**  
as complying with the Florida  
Building Code  
NOA-No. 23-0908.07  
Expiration Date 06/01/2026

By *[Signature]*  
Miami-Dade Product Control

Robert J. Amoruso, P.E.  
Florida P.E. No. 48752





|   |   |  |     |
|---|---|--|-----|
| PROJECT #423-0909   |   | KAYCAN LTD<br>1 MEMORIAL DRIVE<br>RICHFORD, VT 05476 |     |
| SP-600 16" ALUMINUM SOFFIT - VENTED<br>APPROVED SOFFIT PROFILE AND COMPONENTS |   | PREPARED BY:<br>TJH<br>DATE: 12/27/11                |     |
| KAY0003   |   | SCALE:<br>N.T.S.                                     |     |
| 2 OF 4  |   | REV: 6   |     |
| REV   | DESCRIPTION                                 | DATE   | BY  |
| 6   | UPDATE TO THE 8TH (2023) EDITION OF THE FBC | 8/3/23   | RJA |

**PRODUCT REVISED**  
as complying with the Florida  
Building Code  
NOA-No. 23-0908.07  
Expiration Date 06/01/2026  
By: *[Signature]*  
Miami-Dade Product Control

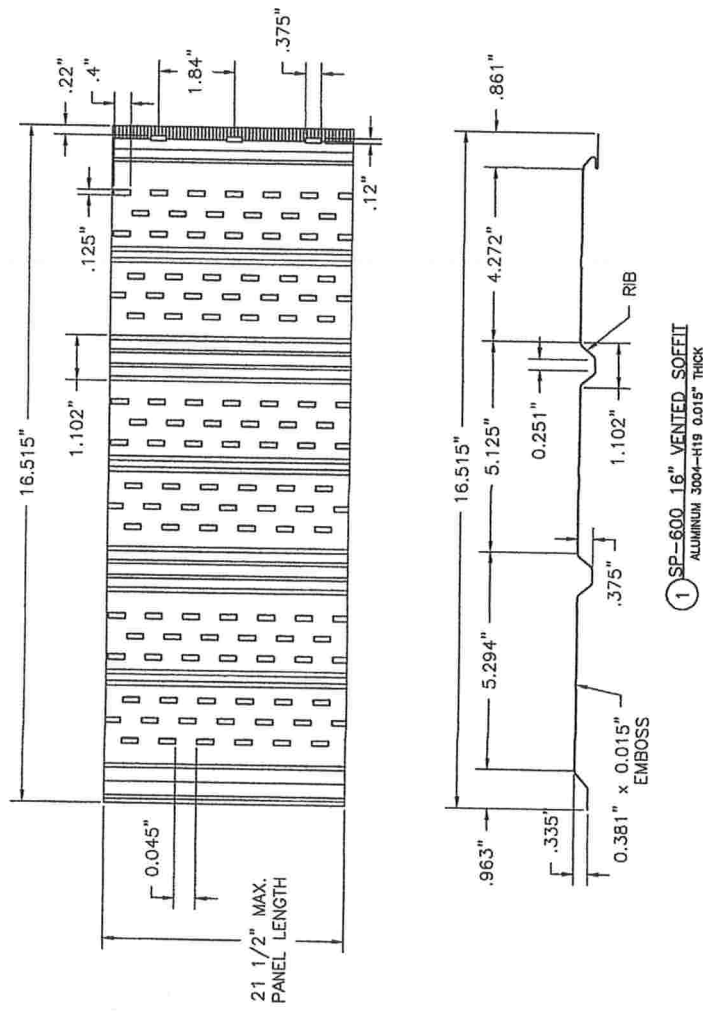
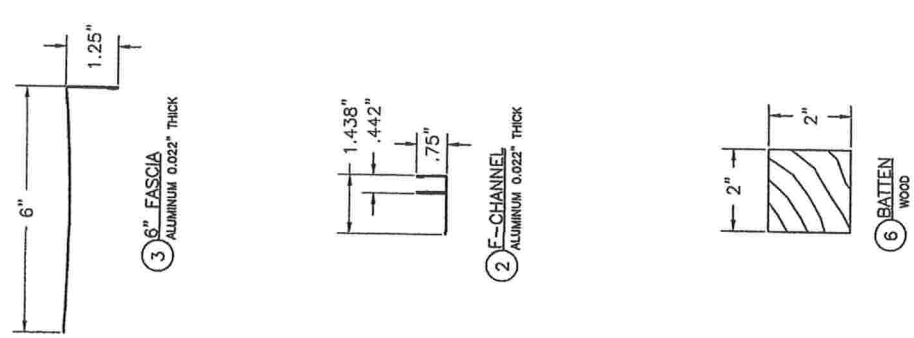

|                     |                                      |  |          |  |     |
|---------------------|--------------------------------------|--|----------|--|-----|
| PROJECT #423-0909   |                                      | KAYCAN LTD<br>1 MEMORIAL DRIVE<br>RICHFORD, VT 05476 |          | SP-600 16" ALUMINUM SOFFIT - VENTED<br>SOFFIT INSTALLATION |     |
| REV                 | DESCRIPTION                          | DATE   | DRAWN BY | SCALE  | REV |
| 6                   | UPDATE TO THE 6TH EDITION OF THE FBC | 8/31/23  | RJA      |  |     |
| 3                   | OF 4                                 |  |          |  |     |
| SHEET: KAY0003      |                                      | DATE: 12/27/11                                       |          | REV: N.T.S.  |     |
| DRAWING NO: KAY0003 |                                      | DATE: 12/27/11                                       |          | REV: N.T.S.  |     |
| SHEET: 3 OF 4       |                                      | DATE: 12/27/11                                       |          | REV: N.T.S.  |     |

**PRODUCT REVISED**  
as complying with the Florida  
Building Code  
NOA-No. 23-0908.07  
Expiration Date 06/01/2026  
By *[Signature]*  
Miami-Dade Product Control

Robert J. Amoroso, P.E.  
Florida P.E. No. 48752

**PROFESSIONAL ENGINEER**  
STATE OF FLORIDA  
No. 48752  
JAMES AMOROSO  
OS 12/27/11

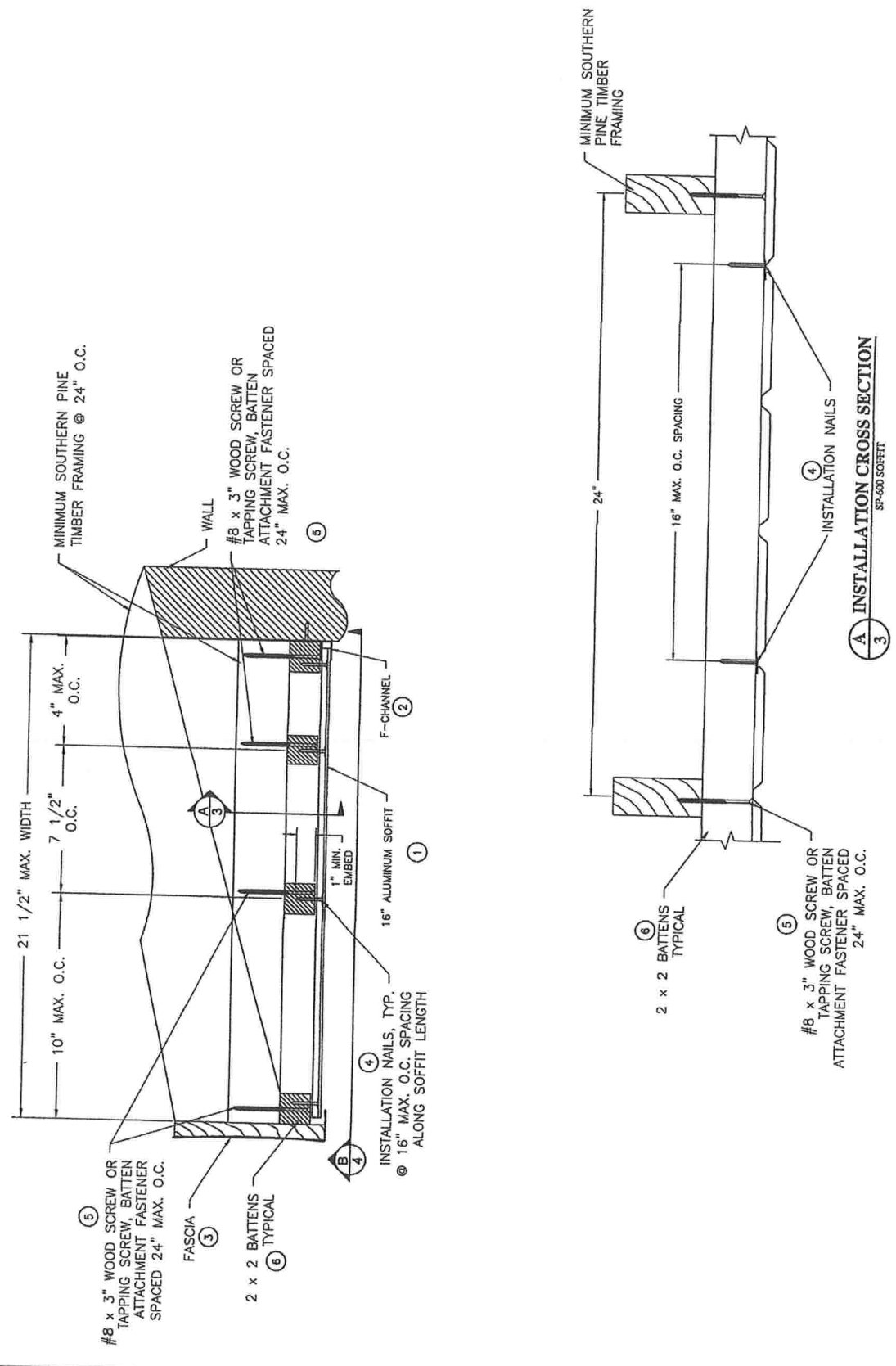

**A INSTALLATION CROSS SECTION**  
SP-600 SOFFIT

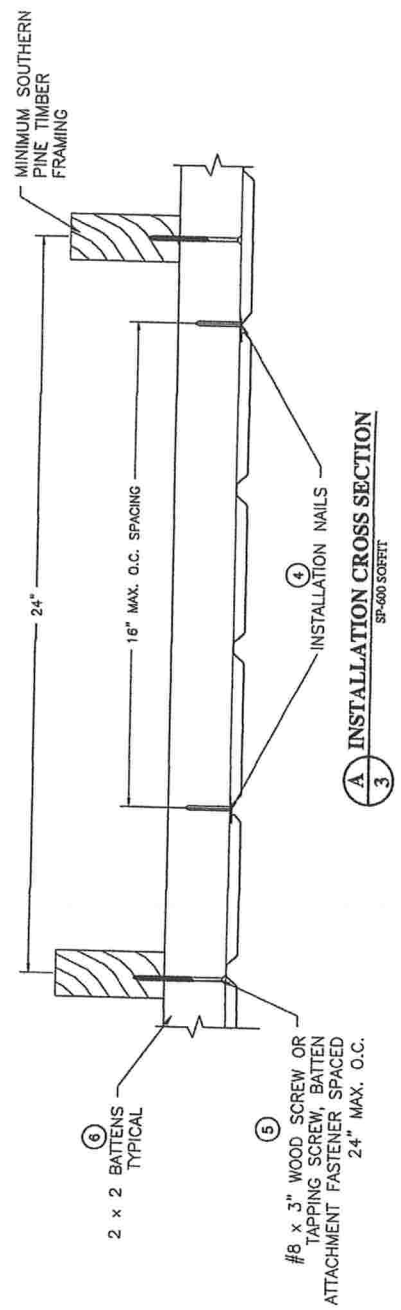



|                   |   |  |          |  |     |
|-------------------|---|--|----------|--|-----|
| PROJECT #423-0909 |   | KAYCAN LTD<br>1 MEMORIAL DRIVE<br>RICHFORD, VT 05476 |          | SP-600 16" ALUMINUM SOFFIT - VENTED<br>SOFFIT INSTALLATION SECTION |     |
| REV               | DESCRIPTION                                 | DATE   | DRAWN BY | SCALE  | REV |
| 6                 | UPDATE TO THE 8TH (2023) EDITION OF THE FBC | 8/31/23  | RJA      | 12/27/11   | 6   |
|                   |   |  |          | SHEET: 4 OF 4  |     |

**PRODUCT REVISED**  
as complying with the Florida Building Code  
NOA-No. 23-0908.07  
Expiration Date 06/01/2026  
By: *[Signature]*  
Miami-Dade Product Control

Robert L. Amoroso, P.E.  
Florida P.E. No. 49752

**PROFESSIONAL ENGINEER**  
STATE OF FLORIDA  
JAMES AMOROSO  
No. 49752  
LICENSE

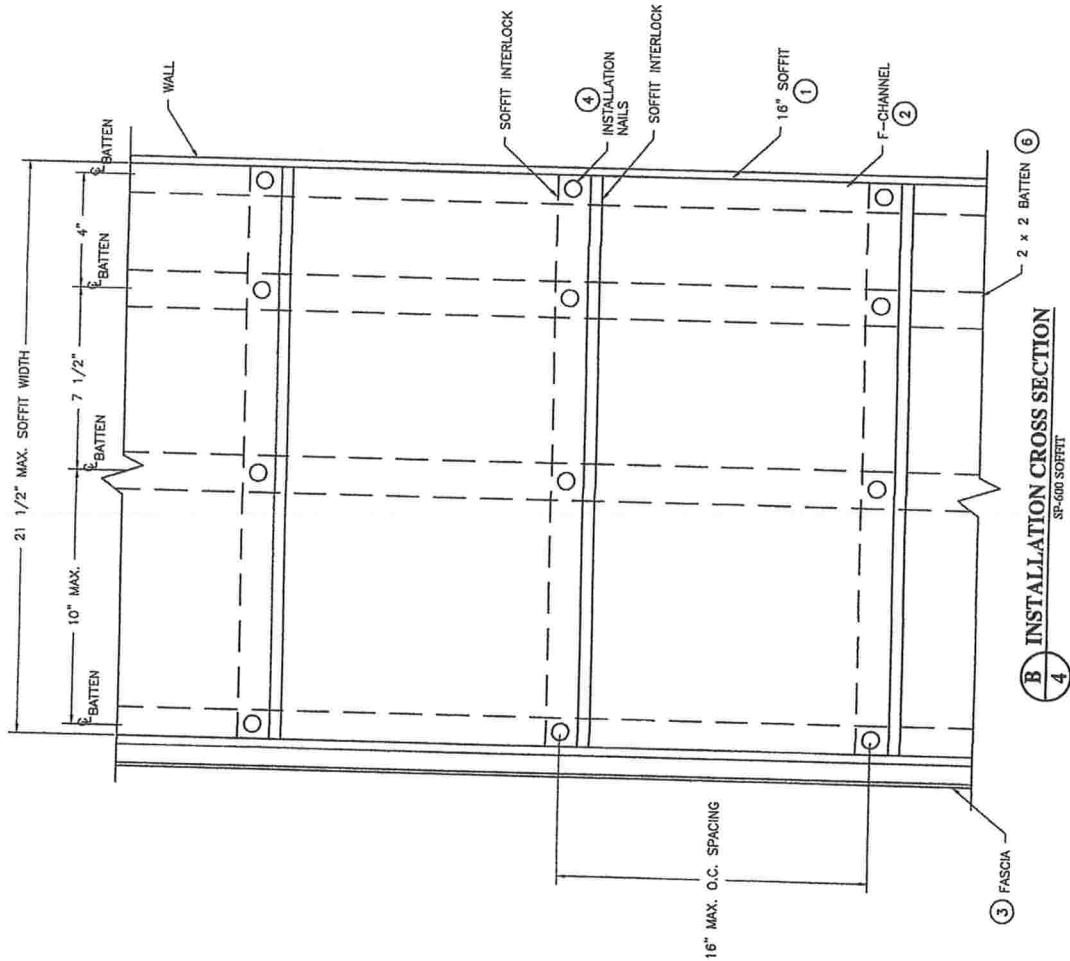

**B** INSTALLATION CROSS SECTION  
SP-600 SOFFIT

# YKK AP AMERICA RESIDENTIAL

## PRECEDENCE SINGLE HUNG WINDOW

### (NON-HVHZ) (NON-IMPACT)

#### INSTALLATION NOTES:

- ONE (1) INSTALLATION ANCHOR IS REQUIRED AT EACH ANCHOR LOCATION SHOWN.
- THE NUMBER OF INSTALLATION ANCHORS DEPICTED IS THE MINIMUM NUMBER OF ANCHORS TO BE USED FOR PRODUCT INSTALLATION.
- INSTALL INDIVIDUAL INSTALLATION ANCHORS WITHIN A TOLERANCE OF  $\pm 1/2$  INCH OF THE DEPICTED LOCATION IN THE ANCHOR LAYOUT DETAIL (I.E. WITHOUT CONSIDERATION OF TOLERANCES). TOLERANCES ARE NOT CUMULATIVE FROM ONE INSTALLATION ANCHOR TO THE NEXT.
- SHIM AS REQUIRED IN ORDER TO ACHIEVE SQUARE AND PLUMB WITH LOAD BEARING SHIMS). MAXIMUM ALLOWABLE SHIM STACK TO BE 1/4 INCH. SHIM WHERE SPACE OF 1/16 INCH OR GREATER OCCURS. SHIMS) SHALL BE CONSTRUCTED OF HIGH DENSITY PLASTIC OR BETTER.
- FINESS INSTALLATION: FOR INSTALLATION INTO WOOD FRAMING USE #10 WOOD SCREWS OF SUFFICIENT LENGTH TO ACHIEVE 1 1/2 INCH MINIMUM EMBEDMENT INTO WOOD SUBSTRATE.
- FINESS INSTALLATION: FOR INSTALLATION THROUGH 1X BUCK TO CONCRETE/MASONRY, OR DIRECTLY INTO CONCRETE/MASONRY, USE 3/16 INCH DIAMETER ITW TAPCON OF SUFFICIENT LENGTH TO ACHIEVE 1 1/4 INCH MINIMUM EMBEDMENT.
- FINESS INSTALLATION: FOR INSTALLATION THROUGH STEEL STUD USE #10 SELF-DRILLING SCREWS OF SUFFICIENT LENGTH TO ACHIEVE 3 THREDS MINIMUM PENETRATION BEYOND STEEL STRUCTURE.
- FOR MASONRY OR CONCRETE OPENINGS, 1X WOOD BUCK MAY BE USED (OPTIONAL AS LONG AS THE MINIMUM EMBEDMENT AND EDGE DISTANCE REQUIREMENTS ARE STILL MET WITHIN THE CORRESPONDING HOST SUBSTRATE. SEE GENERAL NOTE #3 ON SHEET 1 FOR MORE INFORMATION.
- MINIMUM EMBEDMENT AND EDGE DISTANCE EXCLUDE WALL FINISHES, INCLUDING BUT NOT LIMITED TO STUCCO, FOAM, BRICK VENER, AND SIDING.
- INSTALLATION ANCHORS AND ASSOCIATED HARDWARE MUST BE MADE OF CORROSION RESISTANT MATERIAL OR HAVE A CORROSION RESISTANT COATING.
- FOR HOLLOW BLOCK AND GROUT FILLED BLOCK, DO NOT INSTALL INSTALLATION ANCHORS INTO MORTAR JOINTS. EDGE DISTANCE IS MEASURED FROM FREE EDGE OF BLOCK OR EDGE OF MORTAR JOINT INTO FACE SHELL OF BLOCK.
- INSTALLATION ANCHORS SHALL BE INSTALLED IN ACCORDANCE WITH ANCHOR MANUFACTURER'S INSTALLATION INSTRUCTIONS, AND ANCHORS SHALL NOT BE USED IN SUBSTRATES WITH STRENGTHS LESS THAN THE MINIMUM STRENGTH SPECIFIED BY THE ANCHOR MANUFACTURER.
- INSTALLATION ANCHOR CAPACITIES FOR PRODUCTS HEREIN ARE BASED ON SUBSTRATE MATERIALS WITH THE FOLLOWING PROPERTIES:
  - WOOD - MINIMUM SPECIFIC GRAVITY OF 0.55.
  - CONCRETE - MINIMUM COMPRESSIVE STRENGTH OF 3000 PSI.
  - MASONRY - STRENGTH CONFORMANCE TO ASTM C-90.
  - STEEL - MINIMUM YIELD STRENGTH OF 33 KSI, MINIMUM WALL THICKNESS OF 33 MILS (20 GAUGE)

#### GENERAL NOTES:

- THE PRODUCT SHOWN HEREIN IS DESIGNED AND MANUFACTURED TO COMPLY WITH THE CURRENT EDITION FLORIDA BUILDING CODE (FBC), EXCLUDING HVHZ AND HAS BEEN EVALUATED ACCORDING TO THE FOLLOWING:
  - AAMA/WDMA/CSA 101/1.5.2/A440-08/11
- ADEQUACY OF THE EXISTING STRUCTURAL CONCRETE/MASONRY, 2X FRAMING AND METAL STUD FRAMING AS A MAIN WIND FORCE RESISTING SYSTEM CAPABLE OF WITHSTANDING AND TRANSFERRING APPLIED PRODUCT LOADS TO THE FOUNDATION IS THE RESPONSIBILITY OF THE ENGINEER OR ARCHITECT OF RECORD FOR THE PROJECT OF INSTALLATION.

- 1X & 2X BUCKS (WHEN USED) SHALL BE DESIGNED AND ANCHORED TO PROPERLY TRANSFER ALL LOADS TO THE STRUCTURE. BUCK DESIGN AND INSTALLATION IS THE RESPONSIBILITY OF THE ENGINEER OR ARCHITECT OF RECORD FOR THE PROJECT OF INSTALLATION.
- THE INSTALLATION DETAILS DESCRIBED HEREIN ARE GENERIC AND MAY NOT REFLECT ACTUAL CONDITIONS FOR A SPECIFIC SITE. IF SITE CONDITIONS CAUSE INSTALLATION TO DEVIATE FROM THE REQUIREMENTS DETAILED HEREIN, A LICENSED ENGINEER OR ARCHITECT SHALL PREPARE SITE SPECIFIC DOCUMENTS FOR USE WITH THIS DOCUMENT IN NON-HVHZ AREAS.
- APPROVED IMPACT PROTECTIVE SYSTEM IS REQUIRED ON THIS PRODUCT IN AREAS REQUIRING IMPACT RESISTANCE.
- WINDOW FRAME MATERIAL: PVC
- DESIGNATIONS "X" AND "O" STAND FOR THE FOLLOWING:
  - X: OPERABLE SASH
  - O: FIXED SASH
- GLAZING SHALL MEET ASTM E1300 REQUIREMENTS. SEE SHEET 1 FOR GLAZING DETAIL.

#### TABLE OF CONTENTS

| SHEET | SHEET DESCRIPTION  |
|-------|--|
| 1     | INSTALLATION, GENERAL NOTES & GLAZING DETAIL                               |
| 2     | ELEVATION & ANCHOR LAYOUT - SINGLE   |
| 3     | ELEVATION, ANCHOR LAYOUT - TRIPLE, ANCHOR SCHEDULE, & REINFORCEMENT TABLES |
| 4     | VERTICAL SECTIONS  |
| 5     | HORIZONTAL SECTIONS  |

#### DESIGN PRESSURE TABLE

| DESIGN PRESSURE TABLE |                 |        |             |        |                 |               |                     |               |
|-----------------------|-----------------|--------|-------------|--------|-----------------|---------------|---------------------|---------------|
| UNIT                  | MAX. FRAME SIZE |        | MAX. D.L.O. |        | DESIGN PRESSURE | CONFIGURATION | INSTALLATION METHOD | IMPACT RATING |
|                       | WIDTH           | HEIGHT | WIDTH       | HEIGHT |                 |               |                     |               |
| 1                     | 52.5"           | 75"    | 46.5"       | 33.75" | +35/-35 PSF     | "O/X"         | THROUGH FRAME       | NOT RATED     |
| 2                     | 43.5"           | 79.5"  | 39"         | 37.75" | +50/-50 PSF     | "O/X"         | THROUGH FRAME       | NOT RATED     |
| 3                     | 47.5"           | 79.5"  | 41.25"      | 36"    | +35/-35 PSF     | "O/X"         | THROUGH FRAME       | NOT RATED     |
| 4                     | 107.5"          | 79.5"  | 29.5"       | 36"    | +35/-35 PSF     | "O/X-O/X-O/X" | THROUGH FRAME       | NOT RATED     |

#### GLAZING NOTES:

- GLASS THICKNESS AND TYPE SHALL COMPLY WITH ASTM E1300 GLASS STRENGTH REQUIREMENTS.
- SETTING BLOCK DIAMETER HARDNESS OF 70-90 (SHORE A) AS REFERENCED IN FBC CHAPTER 24.
- SETTING BLOCK TO BE LOCATED AT 1/4 SPAN LENGTH FOR GLASS WIDER THAN 36" PER FBC CHAPTER 24.
- ALL GLAZING CONFIGURATIONS SHALL COMPLY WITH SAFETY GLAZING REQUIREMENTS OUTLINED IN CURRENT FBC.

#### GLAZING DETAIL

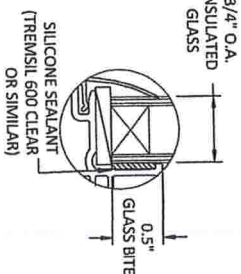

INTERCEPT STAINLESS STEEL OR TIN PLATED SPACER:  
AROUND THE PERIMETER OF THE GLASS  
PRIMARY SEALANT:  
POLYISOBUTYLENE (PIB)  
SECONDARY SEALANT:  
STRUCTURAL SILICONE INTENDED FOR FABRICATION OF INSULATED GLASS UNITS.



YKK AP AMERICA INC.  
101 MANICATA STREET NW, SUITE 2100  
ATLANTA, GA 30303  
PH: (858) 858-6000

TITLE:  
PRECEDENCE SINGLE HUNG WINDOW  
(NON-HVHZ) (NON-IMPACT)  
INSTALLATION, GENERAL NOTES &  
GLAZING DETAIL

PREPARED BY:  
BUILDING DROPS, INC.  
355 E. DANIA BEACH BLVD., STE. 335  
DANIA BEACH, FL 33004  
PH: (954) 849-8478  
FAX: (954) 444-4738  
WEB: www.buildingdrops.com

REMARKS  
BY DATE  
8TH FBC CODE CHANGE F8 09/07/23

THE INFORMATION CONTAINED HEREIN IS THE PROPERTY OF YKK AP AMERICA INC. AND IS NOT TO BE REPRODUCED OR TRANSMITTED IN ANY FORM OR BY ANY MEANS, ELECTRONIC OR MECHANICAL, INCLUDING PHOTOCOPYING, RECORDING, OR BY ANY INFORMATION STORAGE AND RETRIEVAL SYSTEM, WITHOUT THE WRITTEN PERMISSION OF YKK AP AMERICA INC.

Digitally signed by Hermes F. Navarro, P.E.  
Reason: I am approving this document  
Date: 2023.11.09 14:44:00 -0500

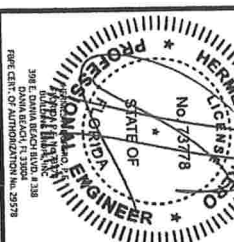

FL #: FL8114  
DATE: 03.10.18  
DWG. BY: HR  
CHK. BY: HFN  
SCALE: NTS  
DWG. #: YKK261  
SHEET: 1  
OF 5

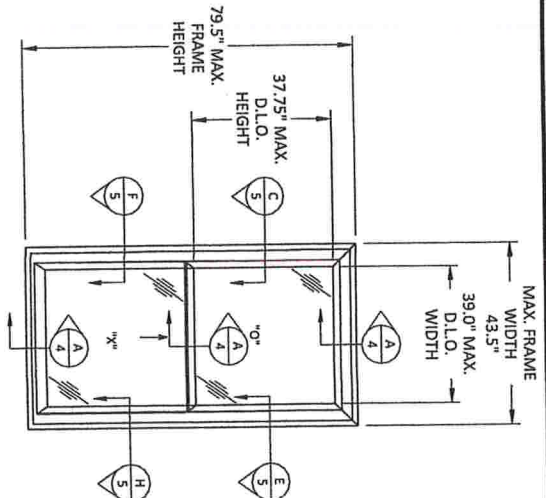
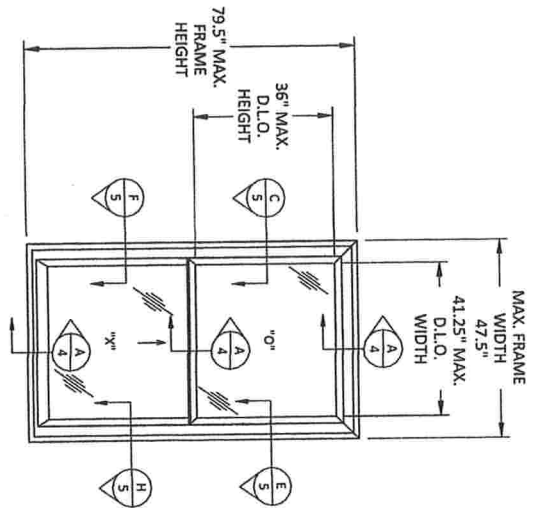
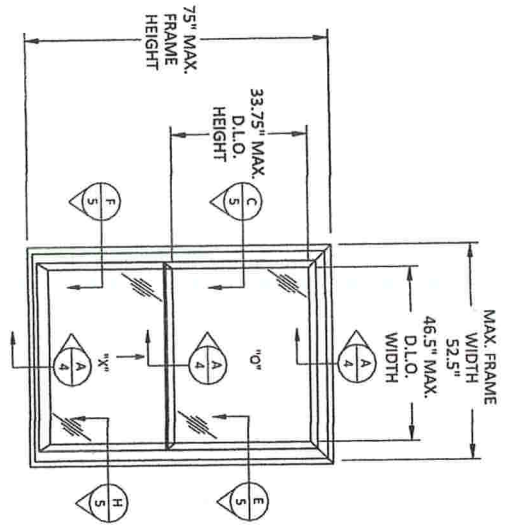

# ELEVATION SINGLE HUNG WINDOW

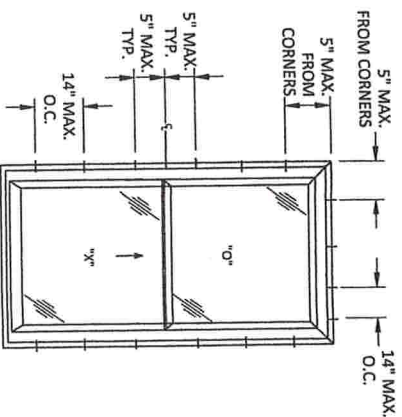
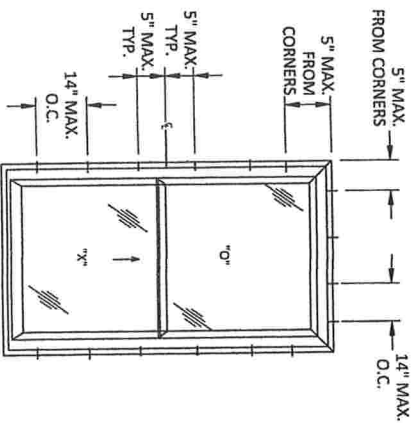
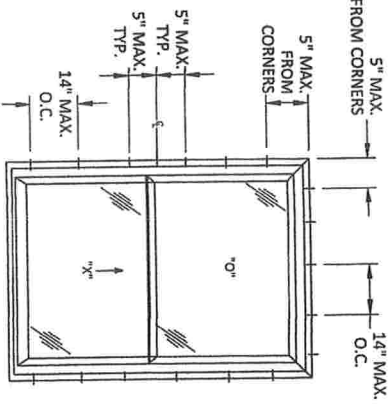

## TYPICAL ANCHOR LAYOUT SINGLE HUNG WINDOW

**YKK**  
**ap**  
Quality  
inspires

**YKK AP AMERICA INC.**  
101 MARRETTA STREET NW, SUITE 2100  
ATLANTA, GA 30303  
PH: (678) 538-6000

TITLE:  
PRECEDENCE SINGLE HUNG WINDOW  
(NON-HVHZ) (NON-IMPACT)

ELEVATION & ANCHOR LAYOUT - SINGLE

PREPARED BY:  
**BUILDING DROPS, INC.**  
398 E. DANIA BEACH BLVD., STE. 338  
DANIA BEACH, FL 33004  
PH: (954) 399-8478  
FAX: (954) 344-4738  
WEB: www.buildingdrops.com

REMARKS

8TH FBC CODE CHANGE

BY DATE

FB 09/07/23

THIS DOCUMENT IS THE PROPERTY OF YKK AP AMERICA, INC. AND IS NOT TO BE REPRODUCED OR TRANSMITTED IN ANY FORM OR BY ANY MEANS, ELECTRONIC OR MECHANICAL, WITHOUT THE WRITTEN PERMISSION OF YKK AP AMERICA, INC. IF SITE CONDITIONS CHANGE INSULATION TO MEET THE REQUIREMENTS OF THE LOCAL CODE, A LICENSED PROFESSIONAL ENGINEER MUST BE CONSULTED FOR ANY CHANGES TO THE DOCUMENT. SEE THE DOCUMENT FOR THE LATEST REVISIONS.

**HERNANDEZ, F. MORALES**  
Professional Engineer  
No. 76378  
STATE OF FLORIDA  
398 E. DANIA BEACH BLVD., STE. 338  
DANIA BEACH, FL 33004  
TYPE CERT. OF AUTHORIZATION No. 29278

FL #: **FL8114**

DATE: **03.10.18**

DWG. BY: **HR** CHK. BY: **HFN**

SCALE: **NTS**

DWG. #: **YKK261**

SHEET:



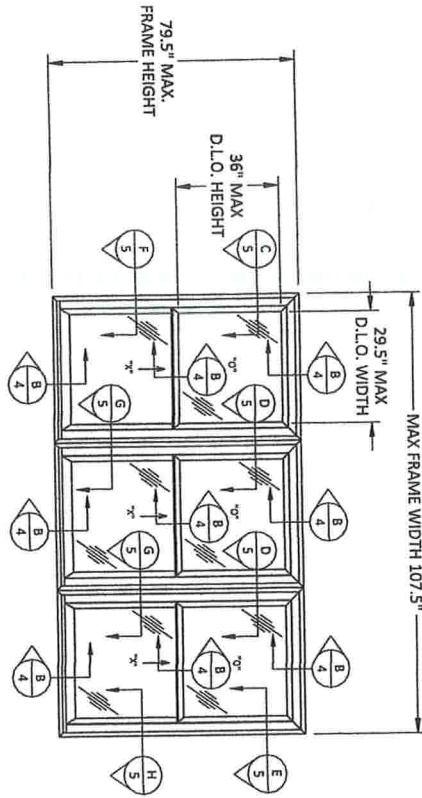

# ELEVATION SINGLE HUNG WINDOW

## ANCHOR LAYOUT THROUGH FRAME - SINGLE HUNG WINDOW

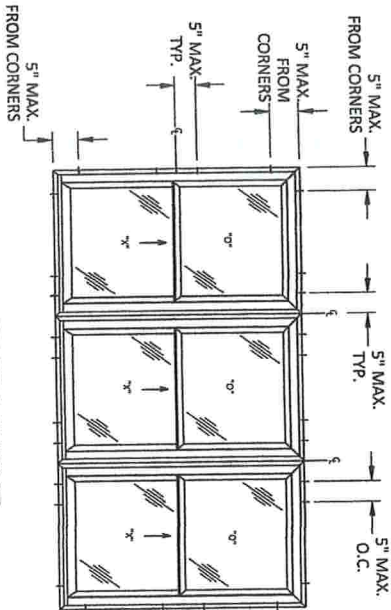

| ANCHOR SCHEDULE |   |                         |  |                    |
|-----------------|---|-------------------------|--|--------------------|
| METHOD          | SUBSTRATE                               | ANCHOR SCHEDULE         | MIN EMBEDMENT                          | MIN. EDGE DISTANCE |
| THROUGH FRAME   | WOOD: MIN. SG = 0.55                    | #10 WOOD SCREW          | 1.50"                                  | 0.75"              |
|                 | METAL: 18 GAUGE STEEL, MIN. Fy = 33KSI  | #10 SELF-DRILLING SCREW | 3 THREADS MIN PENETRATION BEYOND METAL | 0.50"              |
|                 | CONCRETE: f <sub>c</sub> = 3000 PSI     | 3/16" ITW TAPCON        | 1.25"                                  | 1.75"              |
|                 | MASONRY: CMU per ASTM C90 MIN. 2000 PSI | 3/16" ITW TAPCON        | 1.25"                                  | 1.75"              |

| REINFORCEMENT SCHEDULE |                            |                     |
|------------------------|----------------------------|---------------------|
| UNIT                   | LOCATION                   | REINFORCEMENT PART# |
| 1                      | MEETING RAIL (TOP VENT)    | E9-5501             |
|                        | MEETING RAIL (BOTTOM VENT) | E1-5033             |
|                        | STILE (BOTTOM VENT)        | E9-5502             |
|                        | BOTTOM RAIL (BOTTOM VENT)  | E9-5502             |
| 2                      | MEETING RAIL (TOP VENT)    | E9-5501             |
|                        | MEETING RAIL (BOTTOM VENT) | E1-5033             |
|                        | STILE (BOTTOM VENT)        | E9-5502             |
|                        | BOTTOM RAIL (BOTTOM VENT)  | E9-5502             |
| 3                      | MEETING RAIL (TOP VENT)    | E9-5501             |
|                        | MEETING RAIL (BOTTOM VENT) | E9-5502             |
|                        | STILE (BOTTOM VENT)        | E9-5502             |
|                        | BOTTOM RAIL (BOTTOM VENT)  | E9-5502             |
| 4                      | MEETING RAIL (TOP VENT)    | E9-5501             |
|                        | MEETING RAIL (BOTTOM VENT) | E9-5502             |
|                        | STILE (BOTTOM VENT)        | E9-5502             |
|                        | BOTTOM RAIL (BOTTOM VENT)  | E9-5502             |

| MULLION REINFORCEMENT SCHEDULE |                |                 |                     |
|--------------------------------|----------------|-----------------|---------------------|
| CONFIGURATION                  | UNIT SIZE      | DESIGN PRESSURE | REINFORCEMENT PART# |
| TRIPLE                         | 107.5" X 79.5" | +/- 35 PSF      | E9-5551             |

TITLE: PRECEDENCE SINGLE HUNG WINDOW (NON-HVHZ) (NON-IMPACT)  
ELEVATION, ANCHOR LAYOUT - TRIPLE & ANCHOR SCHEDULE

PREPARED BY: BUILDING DROPS, INC.  
398 E. DANIA BEACH BLVD., STE. 338  
DANIA BEACH, FL 33004  
PH: (954) 399-8478  
FAX: (954) 444-4738  
WEB: www.buildingdrops.com

REMARKS: 8TH FBC CODE CHANGE FB 09/07/23

BY: DATE:

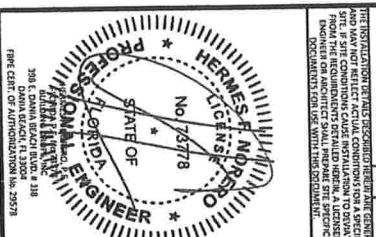

FL #: FL8114

DATE: 03.10.18

DWG. BY: HR

CHK. BY: HFN

SCALE: NTS

DWG. #: YKK261

SHEET: 3 OF 5

[illegible]

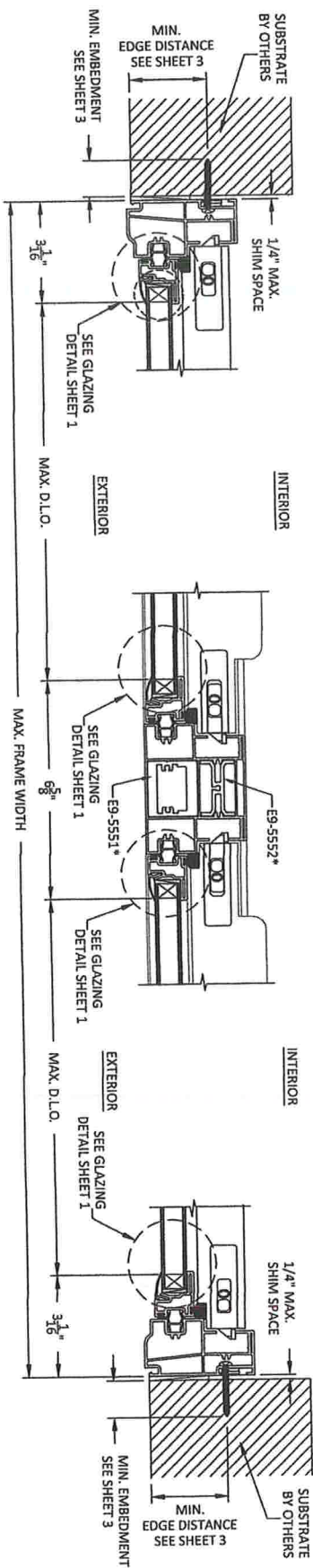

**C**  
5  
HORIZONTAL SECTION  
FIXED JAMB-THROUGH FRAME

**D**  
5  
HORIZONTAL SECTION  
FIXED MULLION

**E**  
5  
HORIZONTAL SECTION  
FIXED JAMB-THROUGH FRAME

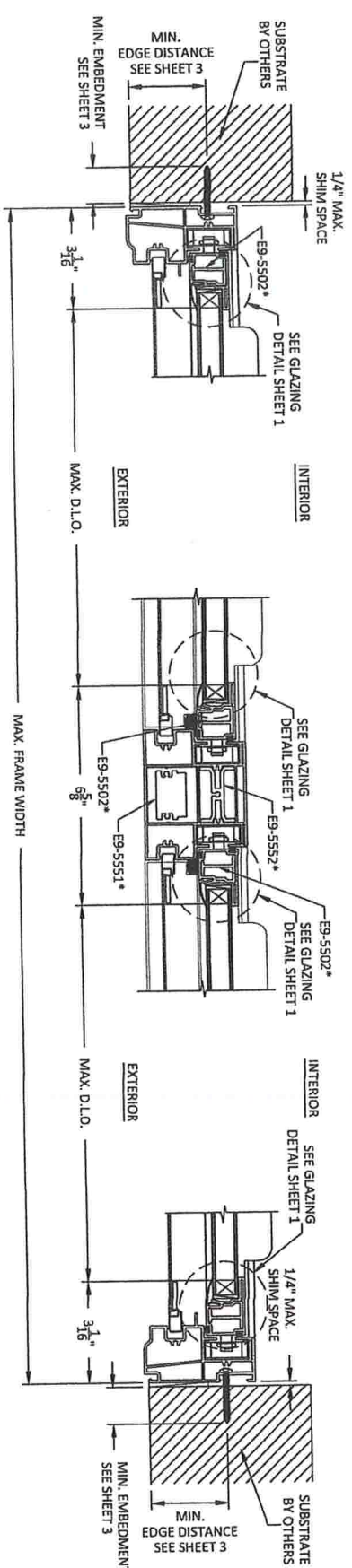

**F**  
5  
HORIZONTAL SECTION  
SASH JAMB-THROUGH FRAME

**G**  
5  
HORIZONTAL SECTION  
SASH MULLION

**H**  
5  
HORIZONTAL SECTION  
SASH JAMB-THROUGH FRAME

\* NOTE: SEE REINFORCEMENT  
TABLES ON SHEET 3.

**YKK**  
**ap**  
inspires  
Quality

**YKK AP AMERICA, INC.**  
350 E. DANIEL BEACH BLVD., STE. 338  
DANIA BEACH, FL 33004  
PH: (954) 399-8478  
FAX: (954) 744-4738  
WEB: www.buildingdrops.com

TITLE: PRECEDENCE SINGLE HUNG WINDOW (NON-HVHZ) (NON-IMPACT)  
HORIZONTAL SECTIONS  
PREPARED BY: BUILDING DROPS, INC.  
350 E. DANIEL BEACH BLVD., STE. 338  
DANIA BEACH, FL 33004  
PH: (954) 399-8478  
FAX: (954) 744-4738  
WEB: www.buildingdrops.com

REMARKS: 8TH FBC CODE CHANGE FB 06/07/23  
BY DATE

HERMES J. MORALES  
No. 75778  
STATE OF FLORIDA  
Professional Engineer  
350 E. DANIEL BEACH BLVD., STE. 338  
DANIA BEACH, FL 33004  
FBC CERT. OF AUTHORIZATION No. 29278

FL #: FL8114  
DATE: 03.10.18  
DWG. BY: CHK. BY: HR HFN  
SCALE: NTS  
DWG. #: YKK261  
SHEET: 5 OF 5





# plastpro

5200 W. CENTURY BLVD.  
LOS ANGELES, CA 90045

## Smooth / Wood Grain / White Wood Grain Rustic / Mahogany Series N Fiberglass Door

### GENERAL NOTES

1. This product has been evaluated and is in compliance with the 8th Edition (2023) Florida Building Code (FBC) structural requirements including the "High Velocity Hurricane Zone" (HVHZ).
2. Product anchors shall be as listed and spaced as shown on details. Anchor embedment to base material shall be beyond wall dressing or stucco.
3. When used in the "HVHZ" this product complies with Section 1626 of the Florida Building Code and does not require an impact resistant covering.
4. When used in areas requiring wind borne debris protection this product complies with FBC Sections 1609.1.2 & R301.2.1.2 and does not require an impact resistant covering. This product meets missile level "D" and includes Wind Zone 4 as defined in ASTM E1996 and FBC Sections 1609.1.2.2 & R301.2.1.2.1.
5. For 2x stud framing construction, anchoring of these units shall be the same as that shown for 2x buck masonry construction.
6. Site conditions that deviate from the details of this drawing require further engineering analysis by a licensed engineer or registered architect.
7. Outswing configuration (using sill item #29) meets water infiltration requirements for "HVHZ". The ADA configuration (using sill item #35) does not meet the water infiltration requirements for the "HVHZ" and must be installed only in non-habitable areas or at habitable locations protected by an overhang or canopy such that the angle between the edge of canopy or overhang to sill is less than 45 degrees.

### OUTSWING "IMPACT"

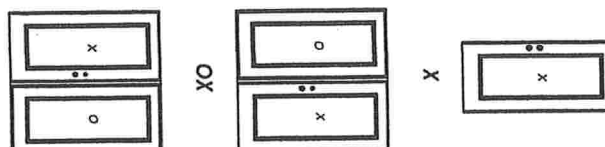
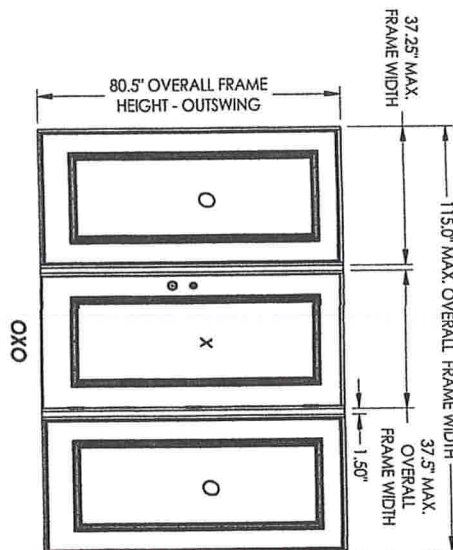

| CONFIGURATION | MAX. FRAME DIMENSION | MAX. SIDELITE D.L.O. DIMENSION | DESIGN PRESSURE (PSF)            |
|---------------|----------------------|--------------------------------|----------------------------------|
| X             | 37.5" X 80.5"        | 20.63" X 62.63"                | POSITIVE<br>OUTSWING<br>NEGATIVE |
| OX/XO         | 76.25" X 80.5"       | 20.63" X 62.63"                | +50.0<br>-50.0                   |
| OXO           | 115.0" X 80.5"       | 20.63" X 62.63"                | +50.0<br>-50.0                   |

### TABLE OF CONTENTS

| SHEET # | DESCRIPTION  |
|---------|--|
| 1       | Typical elevations, design pressures & general notes |
| 2       | Door panel details and glazing detail                |
| 3       | Sidelite panel details and glazing detail            |
| 4       | Elevations   |
| 5       | Horizontal cross sections                            |
| 6       | Vertical cross sections                              |
| 7       | Vertical cross sections                              |
| 8       | Buck anchoring                                       |
| 9       | Frame anchoring                                      |
| 10      | Bill of materials and components                     |



Digitally signed by Lyndon F Schmidt  
Date: 2023.08.15 14:06:14 -04'00'

This item has been digitally signed and sealed by L.F. Schmidt, P.E. on the date adjacent to the seal. Printed copies of this document are not considered signed and sealed and the signature must be verified on any electronic copies.

THIS PRODUCT APPROVAL IS VALID ONLY FOR THE STATE OF FLORIDA

|  |  |  |  |  |          |  |     |
|--|--|--|--|--|----------|--|-----|
| <div>DATE: 02/21/12</div> <div>SCALE: N.T.S.</div> <div>DRG. BY: JK</div> <div>CHK. BY: LFS</div> <div>DRAWING NO.: FL-15180.1</div> |  |  |  | PRODUCT:   |          | Documents Prepared By:   |     |
|  |  |  |  | PLASTPRO INC.<br>FIBERGLASS DOOR                       |          | Lyndon F. Schmidt<br>P.E. No. 43409  |     |
| <div>NO.</div> <div>DATE</div> <div>REVISIONS</div>  |  |  |  | PART OR ASSEMBLY:                                      |          | <div>RW</div> <div>BUILDING CONSULTANTS, INC.<br/>P.O. Box 230, Valrico, FL 33595<br/>Phone No.: 813.659.9197<br/>FBPE Registry No. 9813</div> |     |
|  |  |  |  | TYPICAL ELEVATION, DESIGN<br>PRESSURES & GENERAL NOTES |          |  |     |
|  |  |  |  | 5  | 8/15/23  | UPDATE TO 8TH ED. (2023) FBC   | LFS |
|  |  |  |  | 4  | 6/28/22  | ADD ADA THRESHOLD  | LFS |
|  |  |  |  | 3  | 7/23/20  | UPDATE TO 7TH ED (2020) FBC  | JK  |
|  |  |  |  | 2  | 7/24/17  | UPDATE TO 6TH ED. (2017) FBC   | JK  |
|  |  |  |  | 1  | 04/22/15 | UPDATE TO 5TH ED. (2014) FBC   | JK  |
|  |  |  |  |  |          |  | BY  |

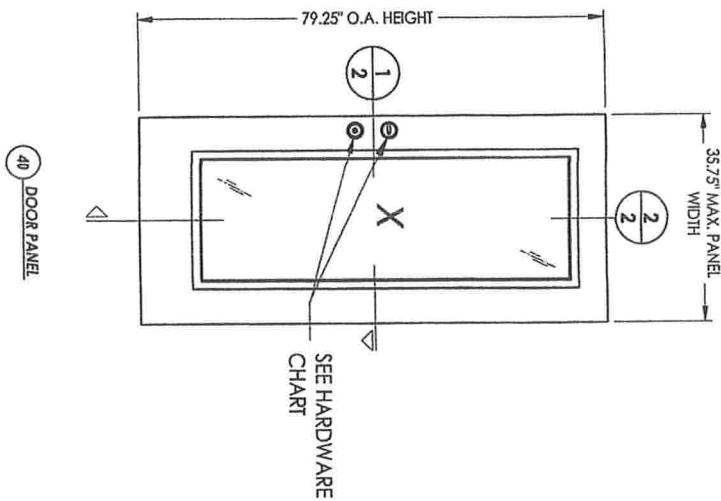

| HARDWARE CHART |                           |
|----------------|---------------------------|
| MANUFACTURER   | MODEL                     |
| Kwikset        | SIGNATURE SERIES (780)    |
| Yale           | YH COLLECTION (80 SERIES) |
| LOCK:          | DEADBOLT:                 |

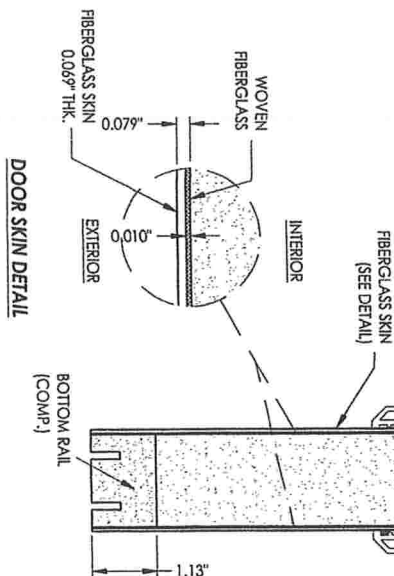
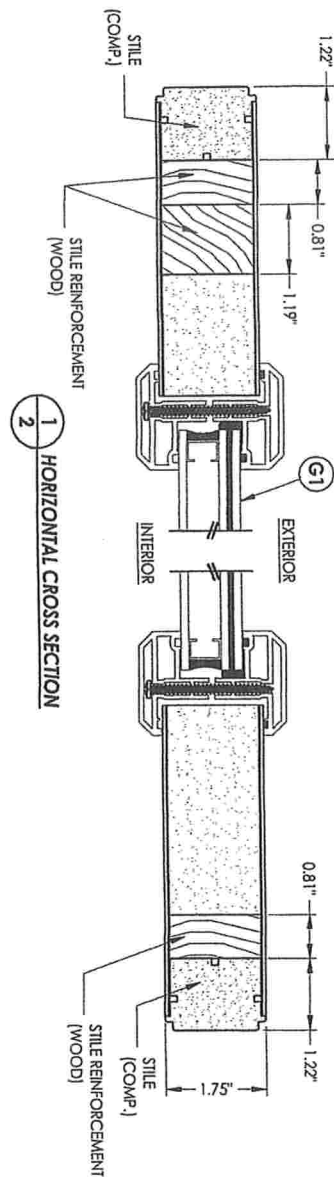

|  |  |  |  |   |  |  |  |
|--|--|--|--|---|--|--|--|
| <b>REVISIONS</b><br>NO. DATE DESCRIPTION BY<br>5 8/15/23 UPDATE TO 8TH ED. (2023) FBC LFS<br>4 6/28/22 ADD ADA THRESHOLD LFS<br>3 7/23/20 UPDATE TO 7TH ED (2020) FBC LFS<br>2 7/24/17 UPDATE TO 6TH ED. (2017) FBC JK<br>1 04/22/15 UPDATE TO 5TH ED. (2014) FBC JK |  |  |  | <b>PRODUCT:</b><br>PLASTPRO INC.<br>FIBERGLASS DOOR<br><b>PART OR ASSEMBLY:</b><br>DOOR PANEL DETAILS<br>AND GLAZING DETAIL |  | <b>Documents Prepared By:</b><br>Lyndon F. Schmidt<br>P.E. No. 43409<br><i>RW</i> BUILDING CONSULTANTS, INC.<br>P.O. Box 230, Valrico, FL 33595<br>Phone No.: 813.659.9197<br>FBPE Registry No. 9813 |  |
| <b>DATE</b> 02/21/12<br><b>SCALE</b> N.T.S.<br><b>CHK. BY:</b> JK<br><b>DRG. BY:</b> LFS<br><b>DRAWING NO.:</b> FL-15180.1<br><b>SHEET</b> 2 OF 10   |  |  |  |   |  |  |  |

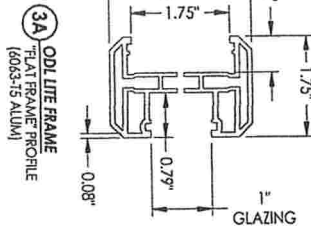
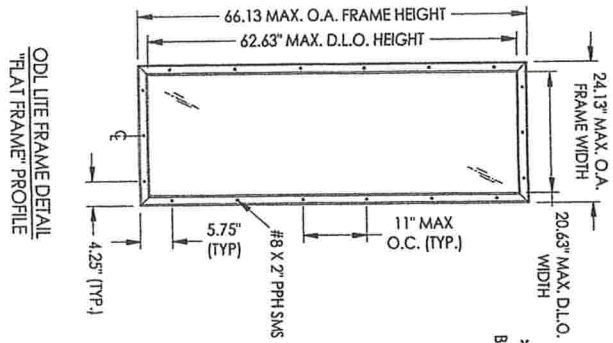
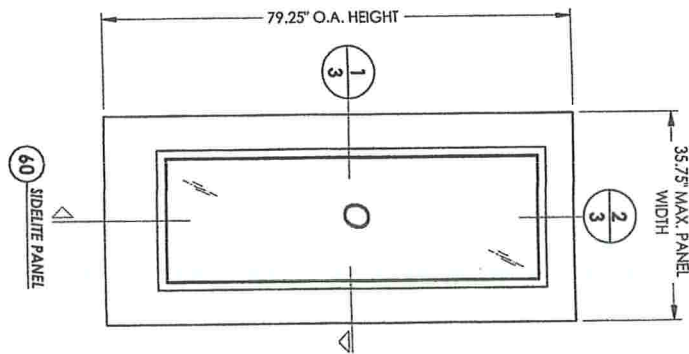

## DOOR SKIN DETAIL

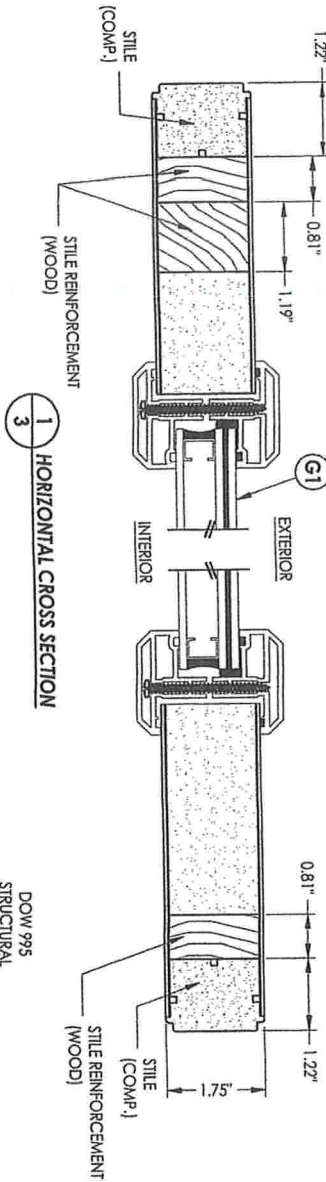
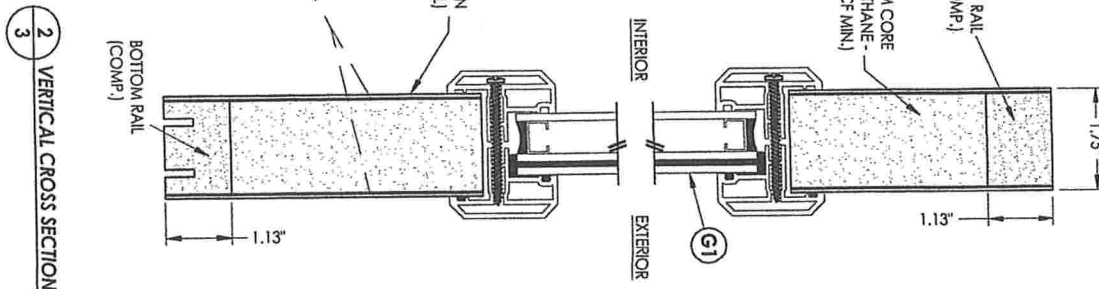

|  |          |                              |     |  |  |  |  |  |  |   |  |   |         |                              |     |   |         |                   |     |   |         |                             |     |   |         |                              |    |   |          |                              |    |     |      |  |    |  |  |   |  |
|--|----------|------------------------------|-----|--|--|--|--|--|--|---|--|---|---------|------------------------------|-----|---|---------|-------------------|-----|---|---------|-----------------------------|-----|---|---------|------------------------------|----|---|----------|------------------------------|----|-----|------|--|----|--|--|---|--|
| <div>DATE: 02/21/12<br/>SCALE: N.T.S.<br/>DWG. BY: JK<br/>CHK. BY: LFS<br/>DRAWING NO.: FL-15180.1<br/>SHEET 3 OF 10</div> |          |                              |     |  |  |  |  |  |  | <div>REVISIONS</div> <table><tr><td>5</td><td>8/15/23</td><td>UPDATE TO 8TH ED. (2023) FBC</td><td>LFS</td></tr><tr><td>4</td><td>6/28/22</td><td>ADD ADA THRESHOLD</td><td>LFS</td></tr><tr><td>3</td><td>7/23/20</td><td>UPDATE TO 7TH ED (2020) FBC</td><td>LFS</td></tr><tr><td>2</td><td>7/24/17</td><td>UPDATE TO 6TH ED. (2017) FBC</td><td>JK</td></tr><tr><td>1</td><td>04/22/15</td><td>UPDATE TO 5TH ED. (2014) FBC</td><td>JK</td></tr><tr><td>NO.</td><td>DATE</td><td></td><td>BY</td></tr></table> |  | 5 | 8/15/23 | UPDATE TO 8TH ED. (2023) FBC | LFS | 4 | 6/28/22 | ADD ADA THRESHOLD | LFS | 3 | 7/23/20 | UPDATE TO 7TH ED (2020) FBC | LFS | 2 | 7/24/17 | UPDATE TO 6TH ED. (2017) FBC | JK | 1 | 04/22/15 | UPDATE TO 5TH ED. (2014) FBC | JK | NO. | DATE |  | BY | <div>PRODUCT:</div> <div>PLASTPRO INC.<br/>FIBERGLASS DOOR</div> <div>PART OR ASSEMBLY:</div> <div>SIDELITE PANEL DETAILS<br/>AND GLAZING DETAIL</div> |  | <div>Documents Prepared By:</div> <div>Lyndon F. Schmidt<br/>P.E. No. 43409</div> <div>RW BUILDING CONSULTANTS, INC.<br/>P.O. Box 230, Valrico, FL 33595<br/>Phone No.: 813.659.9197<br/>FBPE Registry No. 9813</div> |  |
| 5  | 8/15/23  | UPDATE TO 8TH ED. (2023) FBC | LFS |  |  |  |  |  |  |   |  |   |         |                              |     |   |         |                   |     |   |         |                             |     |   |         |                              |    |   |          |                              |    |     |      |  |    |  |  |   |  |
| 4  | 6/28/22  | ADD ADA THRESHOLD            | LFS |  |  |  |  |  |  |   |  |   |         |                              |     |   |         |                   |     |   |         |                             |     |   |         |                              |    |   |          |                              |    |     |      |  |    |  |  |   |  |
| 3  | 7/23/20  | UPDATE TO 7TH ED (2020) FBC  | LFS |  |  |  |  |  |  |   |  |   |         |                              |     |   |         |                   |     |   |         |                             |     |   |         |                              |    |   |          |                              |    |     |      |  |    |  |  |   |  |
| 2  | 7/24/17  | UPDATE TO 6TH ED. (2017) FBC | JK  |  |  |  |  |  |  |   |  |   |         |                              |     |   |         |                   |     |   |         |                             |     |   |         |                              |    |   |          |                              |    |     |      |  |    |  |  |   |  |
| 1  | 04/22/15 | UPDATE TO 5TH ED. (2014) FBC | JK  |  |  |  |  |  |  |   |  |   |         |                              |     |   |         |                   |     |   |         |                             |     |   |         |                              |    |   |          |                              |    |     |      |  |    |  |  |   |  |
| NO.  | DATE     |                              | BY  |  |  |  |  |  |  |   |  |   |         |                              |     |   |         |                   |     |   |         |                             |     |   |         |                              |    |   |          |                              |    |     |      |  |    |  |  |   |  |



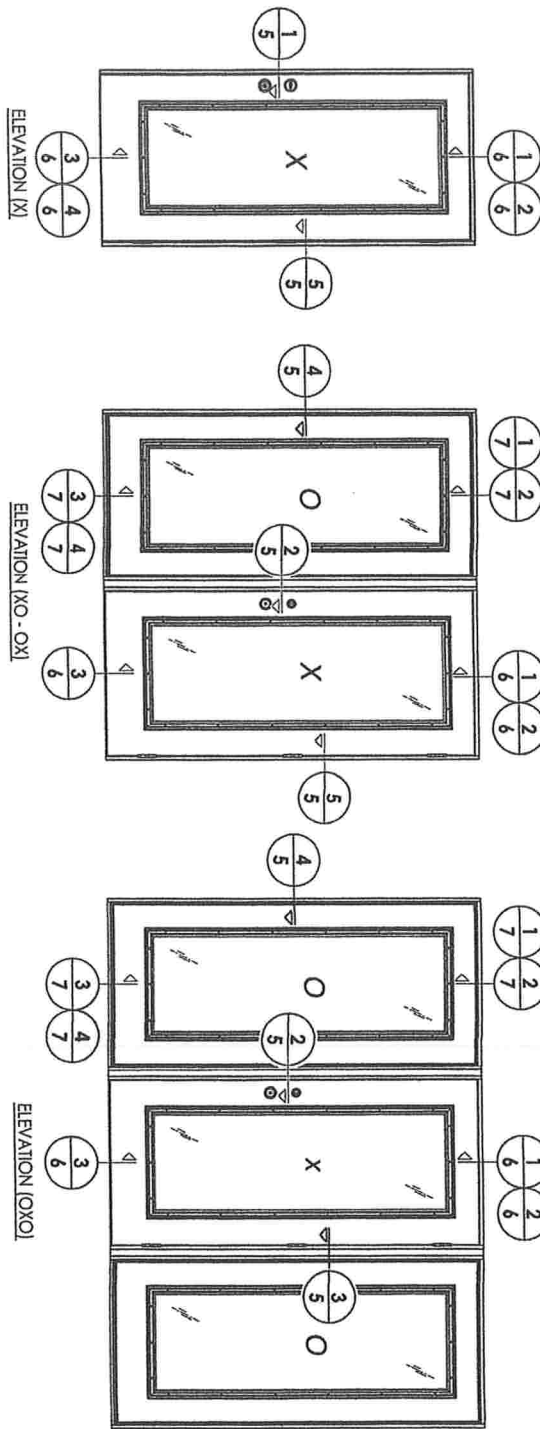

|                            |          |                              |     |  |  |  |  |  |  |  |  |
|----------------------------|----------|------------------------------|-----|--|--|--|--|--|--|--|--|
| DRAWING NO.:<br>FL-15180.1 |          |                              |     | PRODUCT:<br>PLASTPRO INC.<br>FIBERGLASS DOOR |  |  |  | Documents Prepared By:<br>Lyndon F. Schmidt<br>P.E. No. 43409  |  |  |  |
| SHEET 4 of 10              |          |                              |     | PART OR ASSEMBLY:<br>ELEVATIONS              |  |  |  | <div>RW</div> <div>BUILDING CONSULTANTS, INC.<br/>P.O. Box 230, Valrico, FL 33595<br/>Phone No.: 813.659.9197<br/>FBPE Registry No. 9813</div> |  |  |  |
| DATE: 02/21/12             |          |                              |     | REVISIONS                                    |  |  |  |  |  |  |  |
| 5                          | 8/15/23  | UPDATE TO 8TH ED. (2023) FBC | LFS |  |  |  |  |  |  |  |  |
| 4                          | 6/28/22  | ADD ADA THRESHOLD            | LFS |  |  |  |  |  |  |  |  |
| 3                          | 7/23/20  | UPDATE TO 7TH ED (2020) FBC  | LFS |  |  |  |  |  |  |  |  |
| 2                          | 7/24/17  | UPDATE TO 6TH ED. (2017) FBC | JK  |  |  |  |  |  |  |  |  |
| 1                          | 04/22/15 | UPDATE TO 5TH ED. (2014) FBC | JK  |  |  |  |  |  |  |  |  |
| NO. DATE                   |          |                              |     | BY   |  |  |  |  |  |  |  |
| DATE: 02/21/12             |          |                              |     |  |  |  |  |  |  |  |  |
| SCALE: N.T.S.              |          |                              |     |  |  |  |  |  |  |  |  |
| DWG. BY: JK                |          |                              |     |  |  |  |  |  |  |  |  |
| CHK. BY: LFS               |          |                              |     |  |  |  |  |  |  |  |  |

NOTE:  
1. Spacing for item K: 6" from ends and 7" more equally spaced along side(s) (9' total).

# 1 HORIZONTAL CROSS SECTION

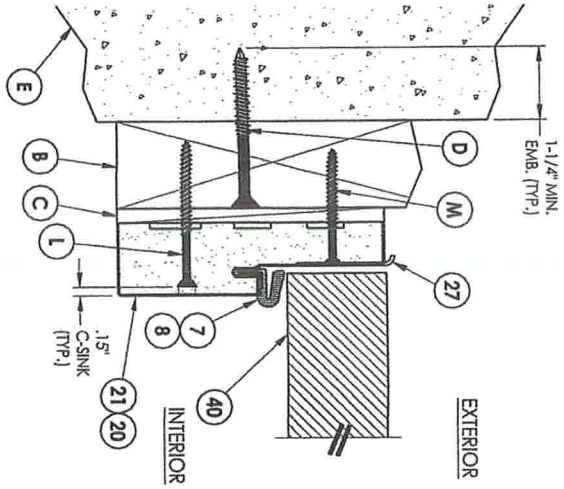

# 4 HORIZONTAL CROSS SECTION

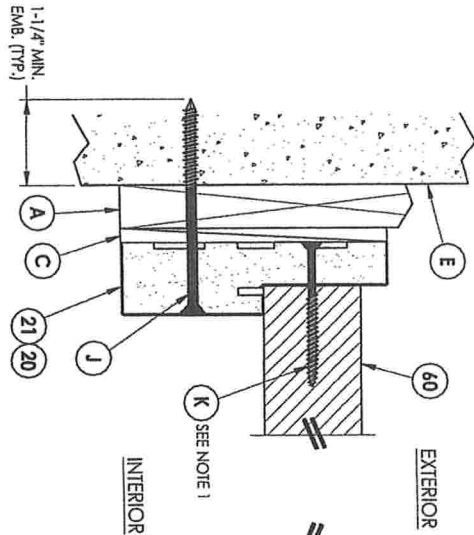

# 5 HORIZONTAL CROSS SECTION

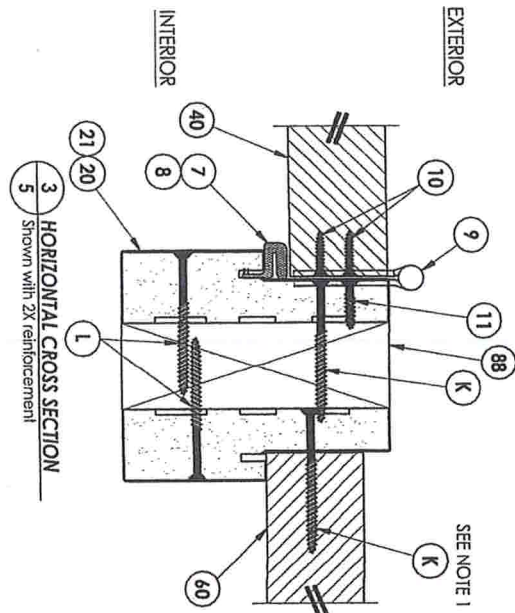
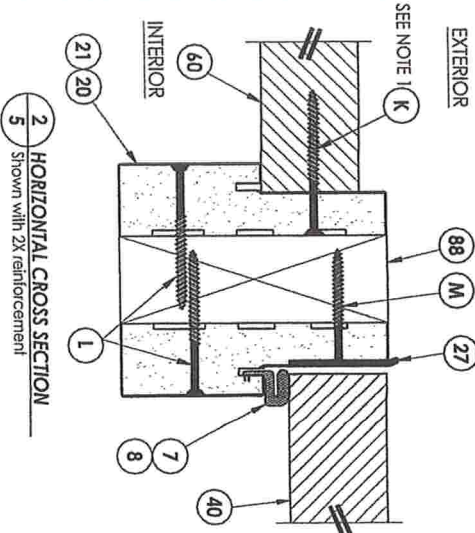
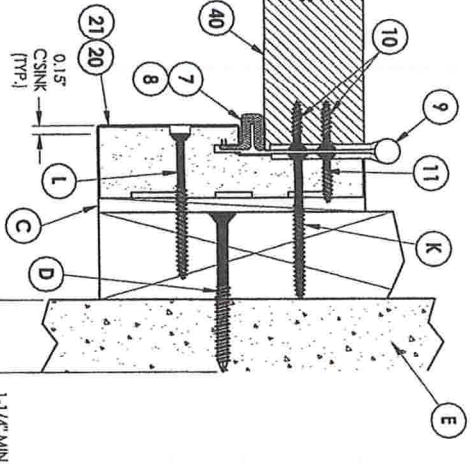

|                           |  |               |  |   |  |   |  |
|---------------------------|--|---------------|--|---|--|---|--|
| DRAWING NO:<br>FL-15180.1 |  | SHEET 5 OF 10 |  | PRODUCT:<br>PLASTPRO INC.<br>FIBERGLASS DOOR      |  | Documents Prepared By:<br>Lyndon F. Schmidt<br>P.E. No. 43409   |  |
| DATE: 02/21/12            |  | SCALE: N.T.S. |  | PART OR ASSEMBLY:<br>HORIZONTAL<br>CROSS SECTIONS |  | <div><i>Rw</i></div> <div>BUILDING CONSULTANTS, INC.<br/>P.O. Box 230, Valrico, FL 33595<br/>Phone No.: 813.659.9197<br/>FBPE Registry No. 9813</div> |  |
| NO.                       |  | DATE          |  | BY  |  |   |  |
| 5                         |  | 8/15/23       |  | UPDATE TO 8TH ED. (2023) FBC                      |  | LFS   |  |
| 4                         |  | 6/28/22       |  | ADD ADA THRESHOLD                                 |  | LFS   |  |
| 3                         |  | 7/23/20       |  | UPDATE TO 7TH ED (2020) FBC                       |  | LFS   |  |
| 2                         |  | 7/24/17       |  | UPDATE TO 6TH ED. (2017) FBC                      |  | JK  |  |
| 1                         |  | 04/22/15      |  | UPDATE TO 5TH ED. (2014) FBC                      |  | JK  |  |
|                           |  |               |  | REVISIONS   |  |   |  |

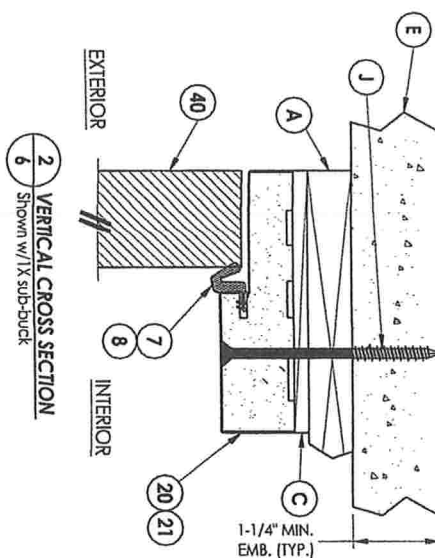
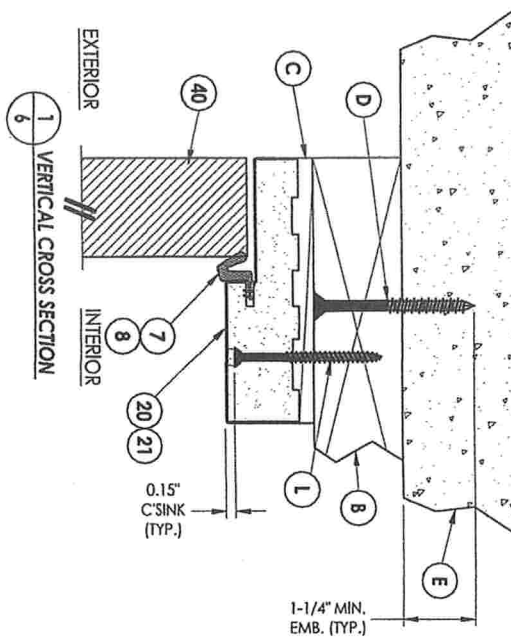
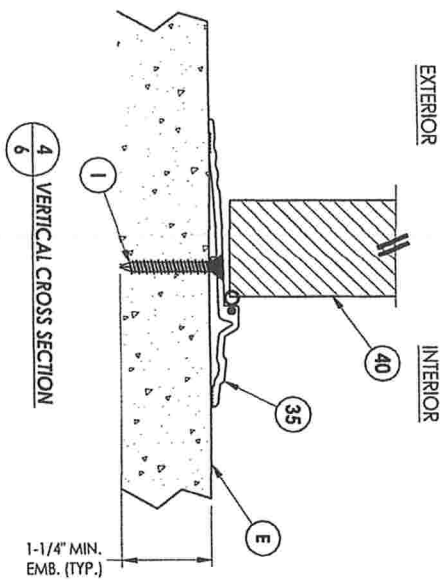
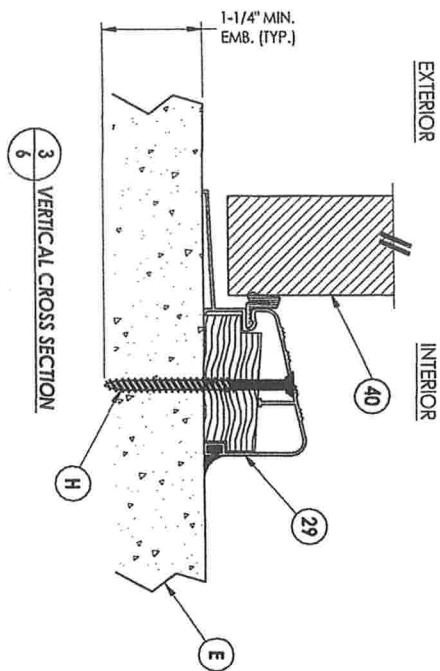

|                         |  |  |  |   |  |  |  |   |  |  |  |
|-------------------------|--|--|--|---|--|--|--|---|--|--|--|
| DATE: 02/21/12          |  |  |  | PRODUCT: PLASTPRO INC.<br>FIBERGLASS DOOR |  |  |  | Documents Prepared By:<br>Lyndon F. Schmidt<br>P.E. No. 43409   |  |  |  |
| SCALE: N.T.S.           |  |  |  | PART OR ASSEMBLY:                         |  |  |  | RW BUILDING CONSULTANTS, INC.<br>P.O. Box 230, Valrico, FL 33595<br>Phone No.: 813.659.9197<br>FBPE Registry No. 9813 |  |  |  |
| DWG. BY: JK             |  |  |  | VERTICAL CROSS SECTIONS                   |  |  |  |   |  |  |  |
| CHK. BY: LFS            |  |  |  |   |  |  |  |   |  |  |  |
| DRAWING NO.: FL-15180.1 |  |  |  |   |  |  |  |   |  |  |  |
| SHEET 6 of 10           |  |  |  |   |  |  |  |   |  |  |  |
| NO.                     |  |  |  | DATE                                      |  |  |  |   |  |  |  |
|                         |  |  |  | REVISIONS                                 |  |  |  |   |  |  |  |
| 5                       |  |  |  | 8/15/23                                   |  |  |  | UPDATE TO 8TH ED. (2023) FBC  |  |  |  |
| 4                       |  |  |  | 6/28/22                                   |  |  |  | ADD ADA THRESHOLD   |  |  |  |
| 3                       |  |  |  | 7/23/20                                   |  |  |  | UPDATE TO 7TH ED (2020) FBC   |  |  |  |
| 2                       |  |  |  | 7/24/17                                   |  |  |  | UPDATE TO 6TH ED. (2017) FBC  |  |  |  |
| 1                       |  |  |  | 04/22/15                                  |  |  |  | UPDATE TO 5TH ED. (2014) FBC  |  |  |  |
|                         |  |  |  |   |  |  |  | BY  |  |  |  |



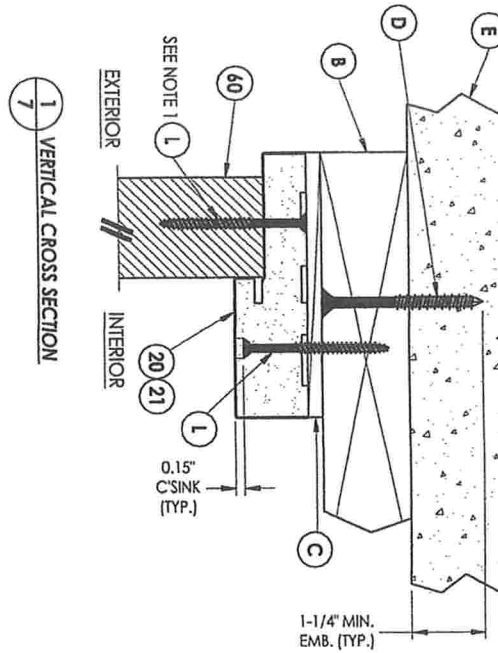

NOTE:  
1. Spacing for item K: 6" from each end and at centerline (3 total).

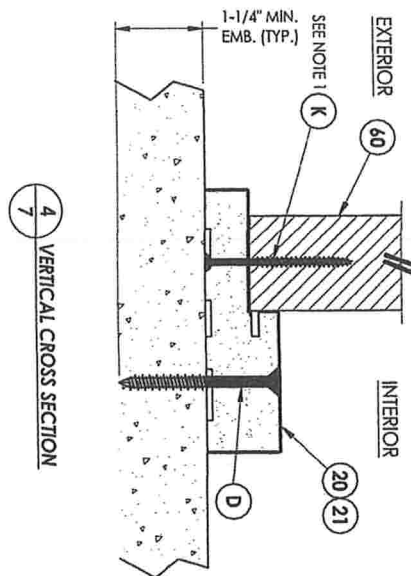
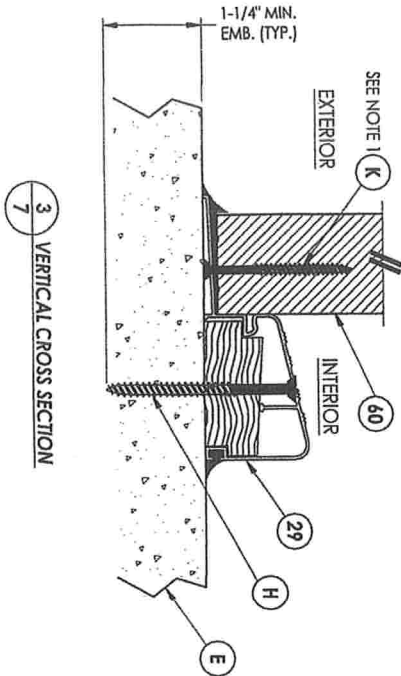
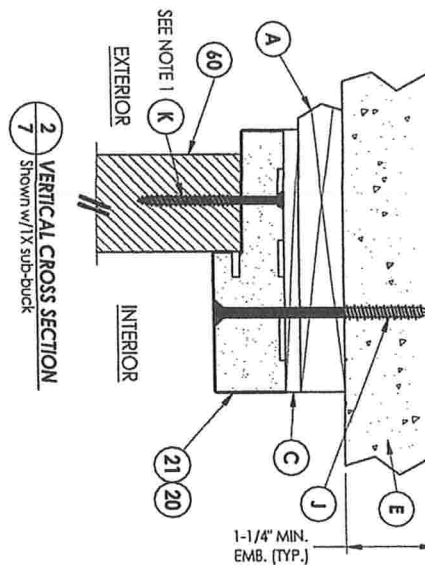

|                                 |  |          |  |                              |  |             |  |              |  |                         |  |               |  |
|---------------------------------|--|----------|--|------------------------------|--|-------------|--|--------------|--|-------------------------|--|---------------|--|
| DATE: 02/21/12                  |  |          |  | SCALE: N.T.S.                |  | DWG. BY: JK |  | CHK. BY: LFS |  | DRAWING NO.: FL-15180.1 |  | SHEET 7 OF 10 |  |
| 5                               |  | 8/15/23  |  | UPDATE TO 8TH ED. (2023) FBC |  | LFS         |  | BY           |  | NO.                     |  | DATE          |  |
| 4                               |  | 6/28/22  |  | ADD ADA THRESHOLD            |  | LFS         |  |              |  |                         |  |               |  |
| 3                               |  | 7/23/20  |  | UPDATE TO 7TH ED (2020) FBC  |  | LFS         |  |              |  |                         |  |               |  |
| 2                               |  | 7/24/17  |  | UPDATE TO 6TH ED. (2017) FBC |  | JK          |  |              |  |                         |  |               |  |
| 1                               |  | 04/22/15 |  | UPDATE TO 5TH ED. (2014) FBC |  | JK          |  |              |  |                         |  |               |  |
|                                 |  |          |  |                              |  |             |  |              |  |                         |  |               |  |
| REVISIONS                       |  |          |  |                              |  |             |  |              |  |                         |  |               |  |
| PRODUCT:                        |  |          |  |                              |  |             |  |              |  |                         |  |               |  |
| PLASTPRO INC.                   |  |          |  |                              |  |             |  |              |  |                         |  |               |  |
| FIBERGLASS DOOR                 |  |          |  |                              |  |             |  |              |  |                         |  |               |  |
| PART OR ASSEMBLY:               |  |          |  |                              |  |             |  |              |  |                         |  |               |  |
| VERTICAL                        |  |          |  |                              |  |             |  |              |  |                         |  |               |  |
| CROSS SECTIONS                  |  |          |  |                              |  |             |  |              |  |                         |  |               |  |
| Documents Prepared By:          |  |          |  |                              |  |             |  |              |  |                         |  |               |  |
| Lyndon F. Schmidt               |  |          |  |                              |  |             |  |              |  |                         |  |               |  |
| P.E. No. 43409                  |  |          |  |                              |  |             |  |              |  |                         |  |               |  |
| RW BUILDING CONSULTANTS, INC.   |  |          |  |                              |  |             |  |              |  |                         |  |               |  |
| P.O. Box 230, Valrico, FL 33595 |  |          |  |                              |  |             |  |              |  |                         |  |               |  |
| Phone No.: 813.659.9197         |  |          |  |                              |  |             |  |              |  |                         |  |               |  |
| FBPE Registry No. 9813          |  |          |  |                              |  |             |  |              |  |                         |  |               |  |

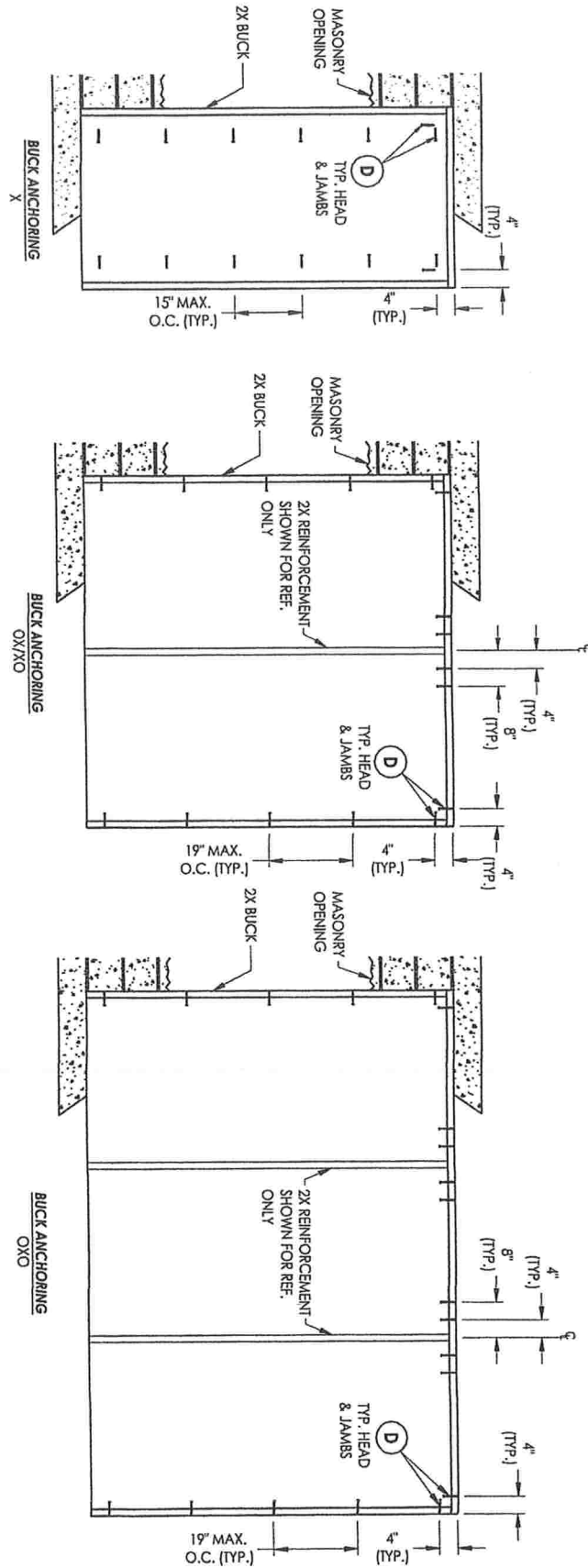
**CONCRETE ANCHOR NOTES:**

1. Concrete anchor locations at the corners may be adjusted to maintain the min. edge distance to mortar joint.
2. Concrete anchor locations noted as "MAX. ON CENTER" must be adjusted to maintain the min. edge distance to mortar joints, additional concrete anchors may be required to ensure the "MAX. ON CENTER" dimension are not exceeded.
3. Concrete anchor table:

| ANCHOR TYPE | ANCHOR SIZE | MIN. EMBEDMENT | MIN. CLEARANCE TO MASONRY EDGE | MIN. CLEARANCE TO ADJACENT ANCHOR |
|-------------|-------------|----------------|--------------------------------|-----------------------------------|
| ITW         | 1/4"        | 1-1/4"         | 2"                             | 4"                                |
| TARCON®     | 1/4"        | 1-1/4"         | 1"                             | 4"                                |
| DEWALT®     | 1/4"        | 1-1/4"         | 1"                             | 4"                                |
| ULTRACON®   | 1/4"        | 1-1/4"         | 1"                             | 4"                                |

**WOOD SCREW INSTALLATION NOTES:**

1. Maintain a minimum 5/8" edge distance, 1" and distance, & 1" o.c. spacing of wood screws to prevent the splitting of wood.

|               |                         |              |             |               |                |           |          |                              |     |   |   |                                     |   |
|---------------|-------------------------|--------------|-------------|---------------|----------------|-----------|----------|------------------------------|-----|---|---|-------------------------------------|---|
| SHEET 8 OF 10 | DRAWING NO.: FL-15180.1 | CHK. BY: LFS | DWC. BY: JK | SCALE: N.T.S. | DATE: 02/21/12 | 5         | 8/15/23  | UPDATE TO 8TH ED. (2023) FBC | LFS | PRODUCT: PLASTPRO INC.<br>FIBERGLASS DOOR | Documents Prepared By:<br>Lyndon F. Schmidt<br>P.E. No. 43409 |                                     |   |
|               |                         |              |             |               |                | 4         | 6/28/22  | ADD ADA THRESHOLD            | LFS |   |   |                                     |   |
|               |                         |              |             |               |                | 3         | 7/23/20  | UPDATE TO 7TH ED (2020) FBC  | LFS |   |   |                                     |   |
|               |                         |              |             |               |                | 2         | 7/24/17  | UPDATE TO 6TH ED. (2017) FBC | JK  |   |   |                                     |   |
|               |                         |              |             |               |                | 1         | 04/22/15 | UPDATE TO 5TH ED. (2014) FBC | JK  |   |   |                                     |   |
|               |                         |              |             |               |                | NO.       |          | DATE                         |     | BY  |   | PART OR ASSEMBLY:<br>BUCK ANCHORING | RW BUILDING CONSULTANTS, INC.<br>P.O. Box 230, Valrico, FL 33595<br>Phone No.: 813.659.9197<br>FBPE Registry No. 9813 |
|               |                         |              |             |               |                | REVISIONS |          |                              |     |   |   |                                     |   |

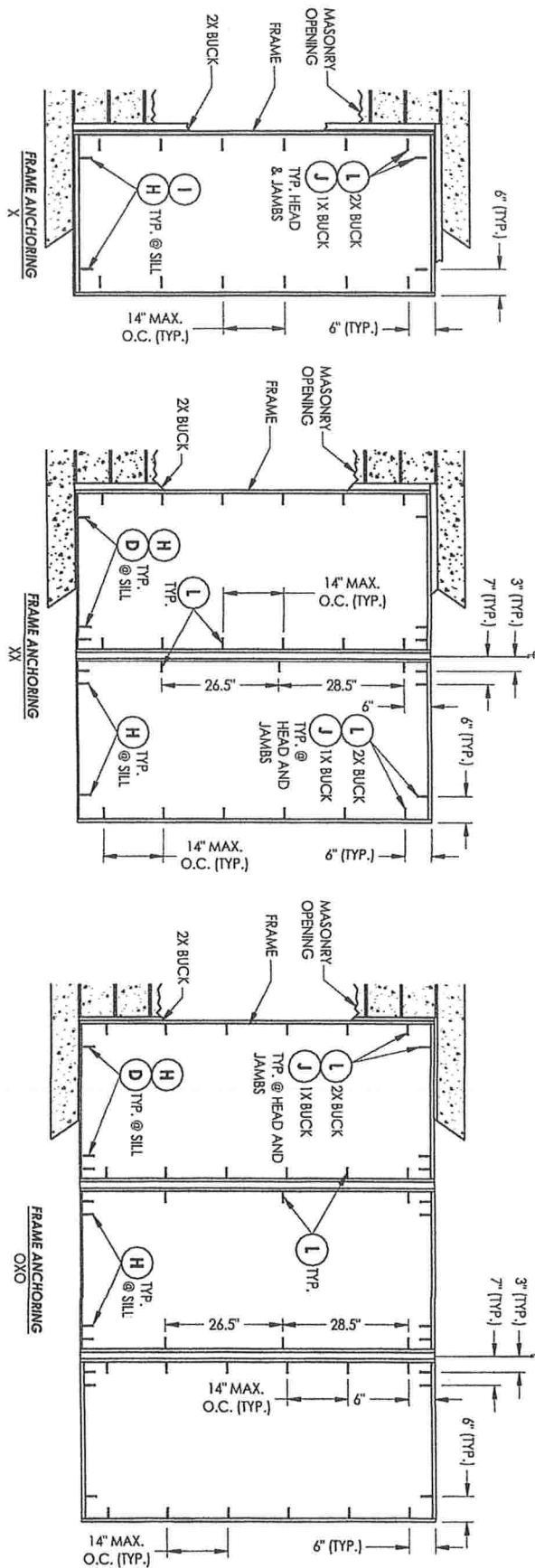

- CONCRETE ANCHOR NOTES:**
1. Concrete anchor locations at the corners may be adjusted to maintain the min. edge distance to mortar joints.
  2. Concrete anchor locations noted as "MAX. ON CENTER" must be adjusted to maintain the min. edge distance to mortar joints; additional concrete anchors may be required to ensure the MAX. ON CENTER dimension are not exceeded.
  3. Concrete anchor table:

| ANCHOR TYPE           | ANCHOR SIZE | MIN. EMBEDMENT | MIN. CLEARANCE TO MASONRY EDGE | MIN. CLEARANCE TO ADJACENT ANCHOR |
|-----------------------|-------------|----------------|--------------------------------|-----------------------------------|
| ITW <sup>®</sup>      | 1/4"        | 1-1/4"         | 2"                             | 4"                                |
| TAPCON <sup>®</sup>   | 1/4"        | 1-1/4"         | 1"                             | 4"                                |
| ULTRACON <sup>®</sup> | 1/4"        | 1-1/4"         | 1"                             | 4"                                |
| ITW <sup>®</sup>      | 3/16"       | 1-1/4"         | 3"                             | 1-1/2"                            |

**WOOD SCREW INSTALLATION NOTES:**

1. Maintain a minimum 5/8" edge distance, 1" and distance, & 1" o.c. spacing of wood screws to prevent the splitting of wood.

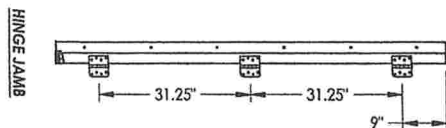
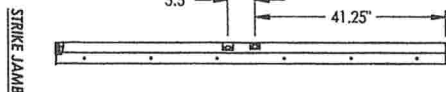
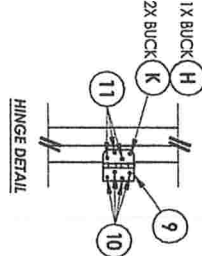
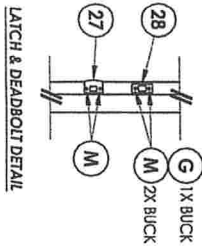

| NO. | DATE     | REVISIONS                    | BY  |
|-----|----------|------------------------------|-----|
| 5   | 8/15/23  | UPDATE TO 8TH ED. (2023) FBC | LFS |
| 4   | 6/28/22  | ADD ADA THRESHOLD            | LFS |
| 3   | 7/23/20  | UPDATE TO 7TH ED (2020) FBC  | LFS |
| 2   | 7/24/17  | UPDATE TO 6TH ED. (2017) FBC | JK  |
| 1   | 04/22/15 | UPDATE TO 5TH ED. (2014) FBC | JK  |

PRODUCT: PLASTPRO INC. FIBERGLASS DOOR

PART OR ASSEMBLY: FRAME ANCHORING

Documents Prepared By:  
Lyndon F. Schmidt  
P.E. No. 43409

**RW** BUILDING CONSULTANTS, INC.  
P.O. Box 230, Valrico, FL 33595  
Phone No.: 813.659.9197  
FBPE Registry No. 9813



| BILL OF MATERIALS |  |            |
|-------------------|--|------------|
| ITEM #            | DESCRIPTION  | MATERIAL   |
| A                 | 1X BUCK (SG >= 0.55)   | WOOD       |
| B                 | 2X BUCK (SG >= 0.55)   | WOOD       |
| C                 | 1/4" MAX. SHIM SPACE   |            |
| D                 | 1/4" X 2-3/4" DeWALT OR ITW CONCRETE SCREW   | STEEL      |
| E                 | MASONRY - 3,000 PSI MIN. CONCRETE CONFORMING TO ACI 301 OR HOLLOW BLOCK CONFORMING TO ASTM C90 | CONCRETE   |
| G                 | 3/16" X 3-1/4" PH ITW CONCRETE SCREW   | STEEL      |
| H                 | 1/4" X 3-1/4" PH DeWALT OR ITW CONCRETE SCREW  | STEEL      |
| I                 | 1/4" X 1-3/4" PH DeWALT OR ITW CONCRETE SCREW  | STEEL      |
| J                 | 1/4" X 3-3/4" PH DeWALT OR ITW CONCRETE SCREW  | STEEL      |
| K                 | #9 X 2-1/2" PH WOOD SCREW  | STEEL      |
| L                 | #10 X 2-1/2" PH WOOD SCREW (1.15" MIN. EMBEDMENT)  | STEEL      |
| M                 | #8 X 2" PH WOOD SCREW  | STEEL      |
| N                 | FORCE 5 WEATHERSTRIP (ENDURA)  | FOAM       |
| O                 | COMPRESSION WEATHERSTRIP QILON 650 (SCHLEGEL)  | FOAM       |
| P                 | 4" X 4" BUTT HINGE   | STEEL      |
| Q                 | #9 X 1" PH WOOD SCREW  | STEEL      |
| R                 | #9 X 3/4" PH WOOD SCREW  | STEEL      |
| S                 | FINGER JOINTED PINE FRAME, HEAD & HINGE JAMBS  | WOOD       |
| T                 | POLY FIBER JAMB  | COMP/VINYL |
| U                 | LATCH STRIKE PLATE   | STEEL      |
| V                 | DEADBOLT STRIKE PLATE  | STEEL      |
| W                 | OUTSWING THRESHOLD   | ALUM/WOOD  |
| X                 | ADA THRESHOLD  | ALUM       |
| Y                 | DOOR PANEL - SEE DOOR PANEL DETAIL SHEET FOR CONSTRUCTION DETAILS                              | -          |
| Z                 | SIDELITE PANEL - SEE SIDELITE PANEL DETAIL SHEET FOR CONSTRUCTION DETAILS                      | -          |
| 88                | 2X REINFORCEMENT (CLEAR PINE: SG >= 0.49)  | WOOD       |

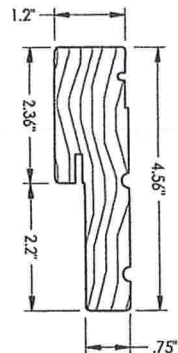

20 HEAD & SIDE Jamb

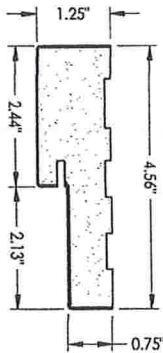

21 HEAD & SIDE Poly fiber jamb

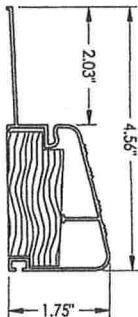

29 OUTSWING THRESHOLD DLP (Q058)

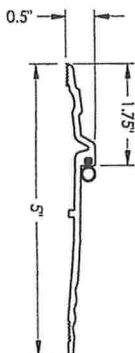

35 ADA THRESHOLD NCF 896V

|   |          |                              |     |   |  |  |  |
|---|----------|------------------------------|-----|---|--|--|--|
| <b>PRODUCT:</b><br>PLASTPRO INC.<br>FIBERGLASS DOOR           |          |                              |     | <b>Documents Prepared By:</b><br>Lyndon F. Schmidt<br>P.E. No. 43409  |  |  |  |
| <b>PART OR ASSEMBLY:</b><br>BILL OF MATERIALS<br>& COMPONENTS |          |                              |     | <b>BUILDING CONSULTANTS, INC.</b><br>P.O. Box 230, Valrico, FL 33595<br>Phone No.: 813.659.9197<br>FBPE Registry No. 9813 |  |  |  |
| <b>REVISIONS</b>  |          |                              |     | <b>DATE</b>   |  |  |  |
| 5   | 8/15/23  | UPDATE TO 8TH ED. (2023) FBC | LFS |   |  |  |  |
| 4   | 6/28/22  | ADD ADA THRESHOLD            | LFS |   |  |  |  |
| 3   | 7/23/20  | UPDATE TO 7TH ED (2020) FBC  | LFS |   |  |  |  |
| 2   | 7/24/17  | UPDATE TO 6TH ED. (2017) FBC | JK  |   |  |  |  |
| 1   | 04/22/15 | UPDATE TO 5TH ED. (2014) FBC | JK  |   |  |  |  |
|   |          |                              |     | <b>NO.</b>  |  |  |  |
|   |          |                              |     | <b>DATE</b>   |  |  |  |
|   |          |                              |     | <b>SCALE:</b> N.T.S.  |  |  |  |
|   |          |                              |     | <b>DWG. BY:</b> JK  |  |  |  |
|   |          |                              |     | <b>CHK. BY:</b> LFS   |  |  |  |
|   |          |                              |     | <b>DRAWING NO.:</b> FL-15180.1  |  |  |  |
|   |          |                              |     | <b>SHEET</b> 10 of 10   |  |  |  |